



1718 W. Fullerton Chicago, IL 60614
 Ph: 773.770.1195 • Fax: 773.935.5613
 www.PureEdgeLighting.com • info@PureEdgeLighting.com
 © 2016 PureEdge Lighting. All Rights Reserved.

Installation Instructions for Reveal Wall Wash

IMPORTANT INFORMATION

- Reveal Wall Wash must be mounted 24" away from the wall.
- This instruction shows a typical installation.
- It is recommended that a qualified electrician install this product.

SAVE THESE INSTRUCTIONS!



Standard Installation

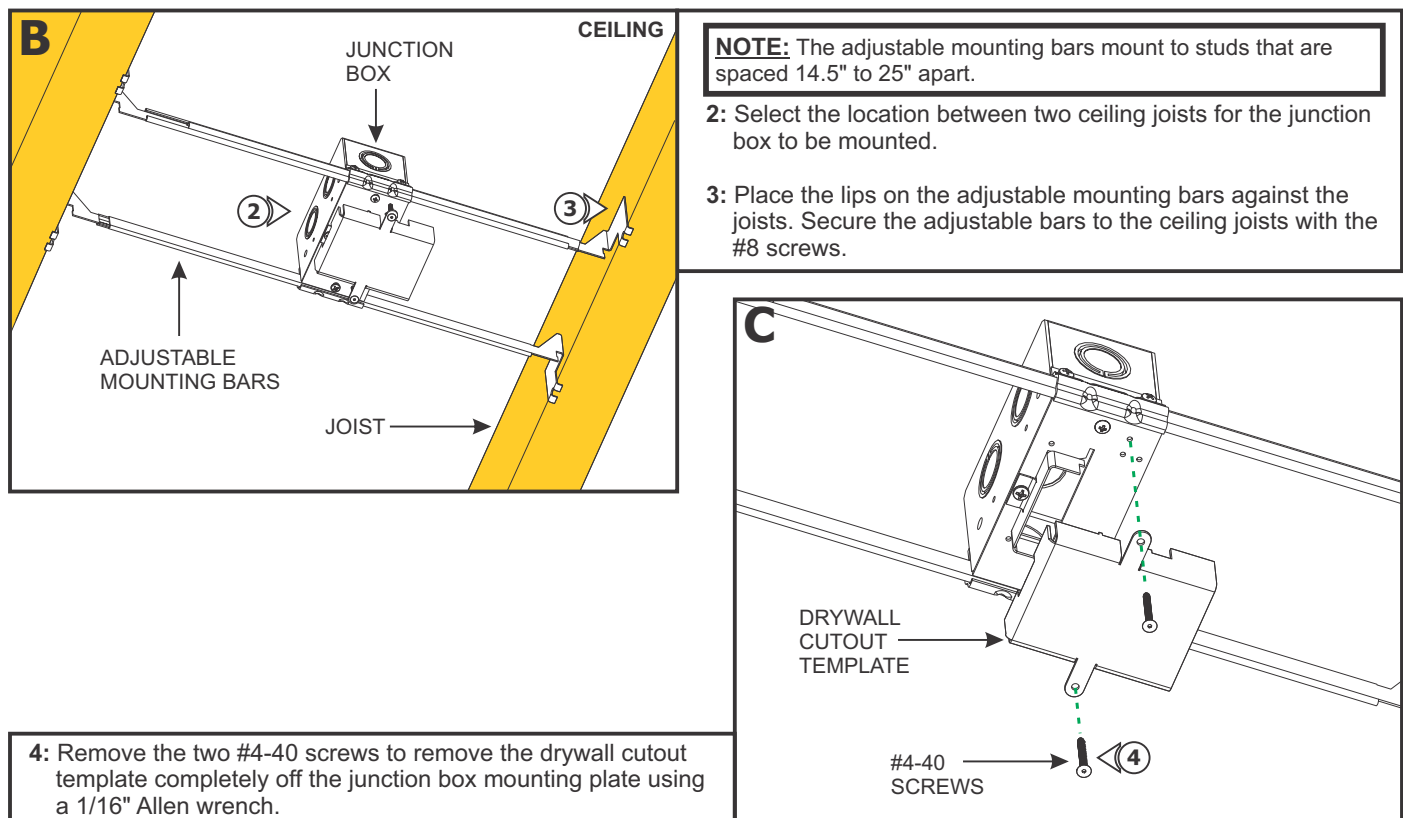
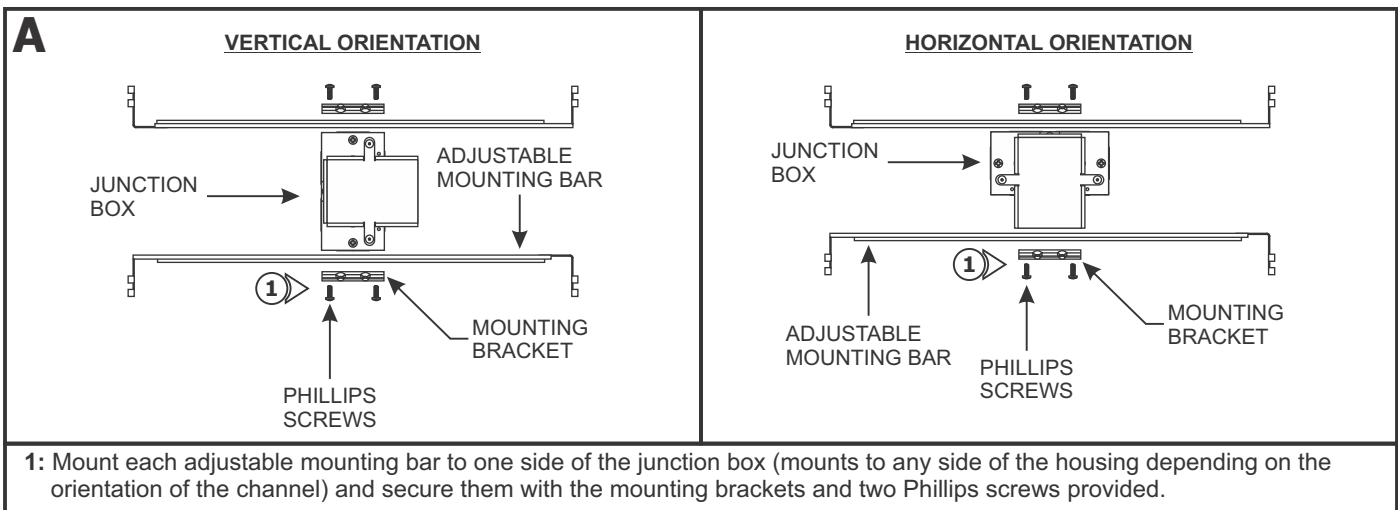

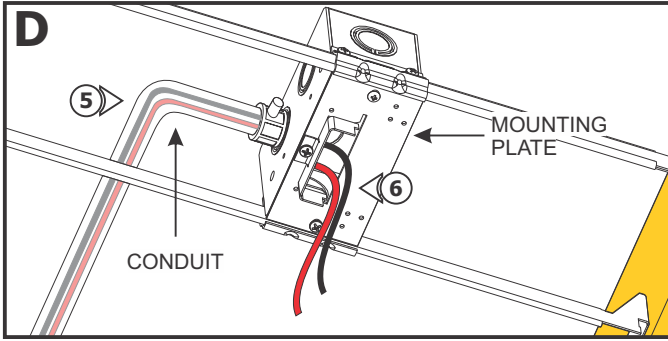

- 5: Remove a knockout on the junction box to install a conduit into the junction box.
- 6: Install conduit(s) (if required by local electrical code) and run low-voltage power wires to the junction box.

- 7: Replace the drywall cutout template.
- 8: Mark a location on the drywall where the junction box will be located. Trace the drywall cutout template onto the drywall at the junction box location.
- 9: Remove the template and cut out the marked area using a jab saw or other appropriate tool to expose the junction box. Install the drywall.

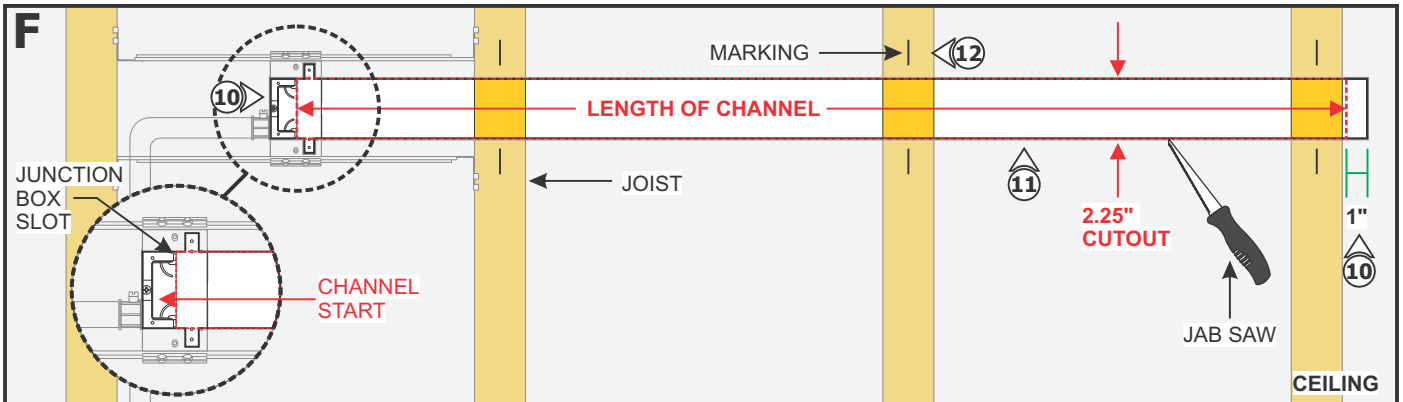
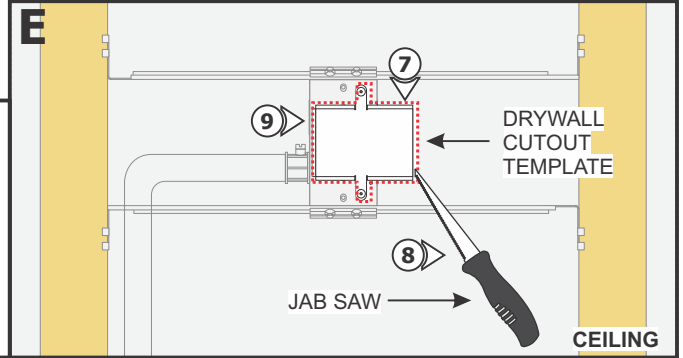

- 10: Mark the area where the installation will be located on the ceiling using the drywall cutout template as a guide (MIN 2.25"). Allow for 1" extra space at the end of the installation for the take-up box.
- 11: Cut out the marked area on the drywall using a jab saw or other appropriate tool.
- 12: Mark the location of the joists to the drywall for future reference.

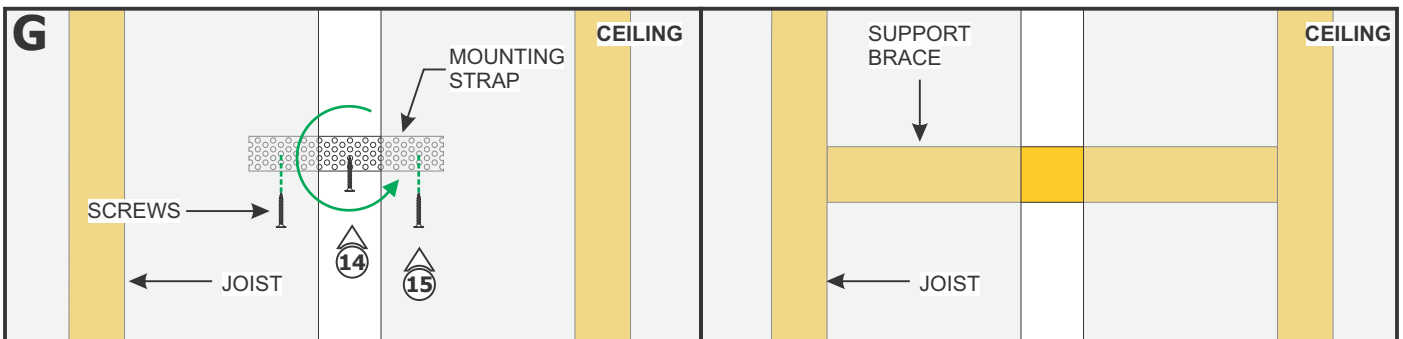

NOTE: For areas with lots of vibrations, it is suggested to install 2X4 support braces (suggested spacing is every 32") before installing and finishing drywall to avoid cracking of plaster.

- 13: To install the channel in a wall without standard spaced studs/joists, install perforated mounting straps every 32" behind drywall.
- 14: Thread a drywall screw into the perforated material. Place the mounting strap behind the drywall and rotate into place using the drywall screw.
- 15: Secure the mounting strap to the drywall using two drywall screws. Mark the location on the mounting strap on the drywall.

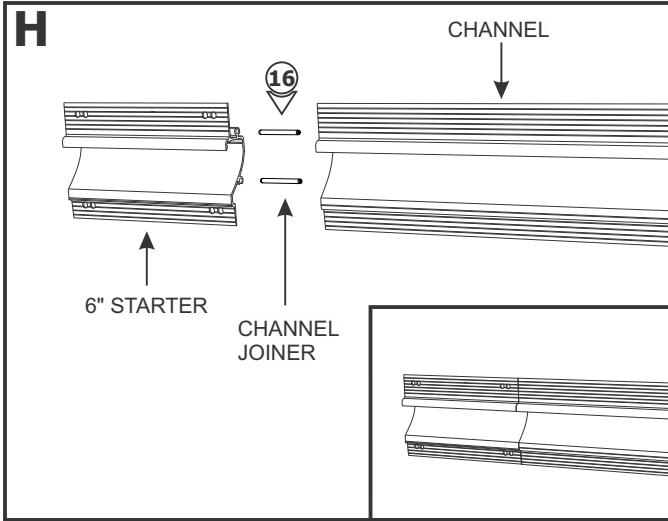

16: Insert the channel joiners half way into the 6" starter channel and then slide the channel onto the joiners.

17: Attach the end cap cover to the 6" starter channel using the two #6-32 screws. Align the slot with the LED section of the channel.

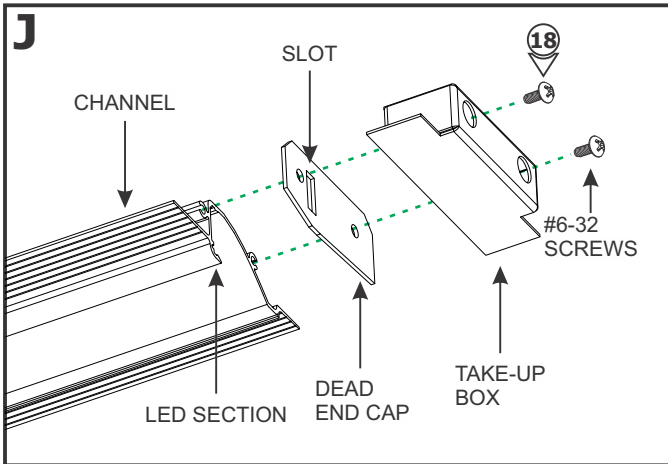
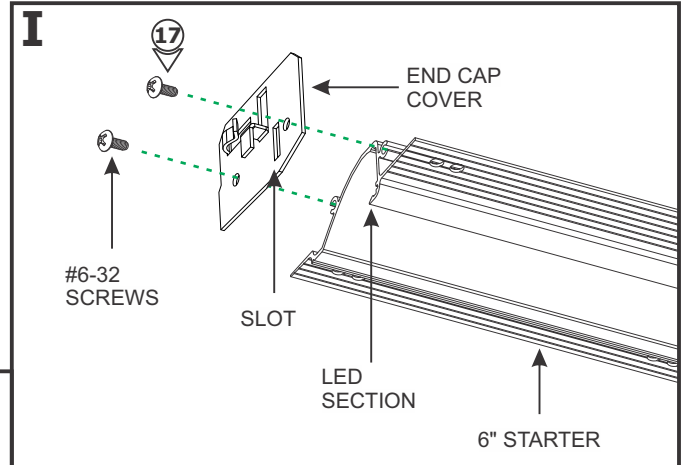

18: Install the dead end cap and take-up box to the opposite end of the channel using the two #6-32 screws. Align the slot with the LED section of the channel.

NOTE: Remote power supply wires must be present in the junction box. Refer to instructions provided with the power supply.

19: Connect the red power supply wire (+24VDC) to the red power connector wire with a wire nut.

20: Connect the black power supply wire (-24VDC) to the black power connector wire with a wire nut.

21: Place all wire nut connections inside the junction box.

CAUTION: Unroll the entire LED strip from the reel and use the power connector to power the strip making sure there is no outage before continuing with the installation. Afterwards, carefully roll the LED strip loosely back into the reel.

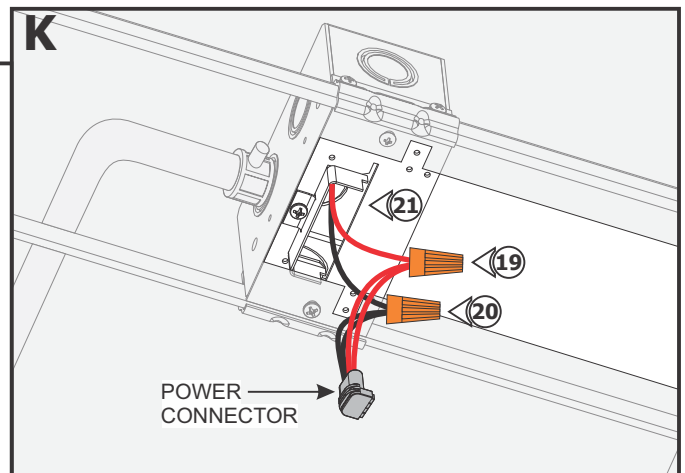

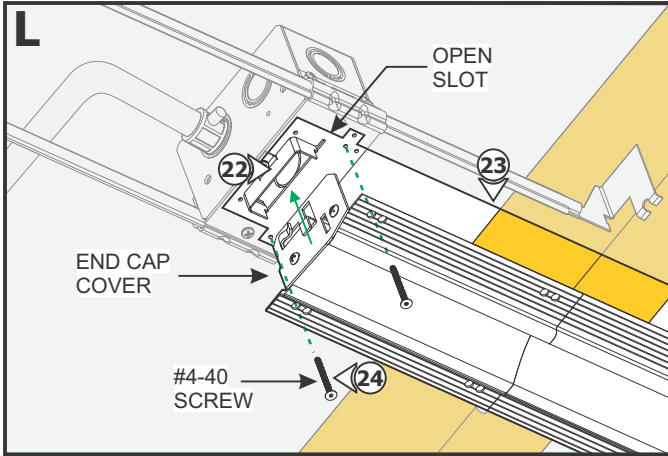

22: Align the end cap cover with the open slot of the mounting plate and push the channel assembly into the drywall cutout on the ceiling.

23: Make sure the channel is aligned straight using a level.

24: Secure the end feed power connector to the junction box with the two #4-40 screws from the drywall cutout template using a 1/16" Allen wrench.

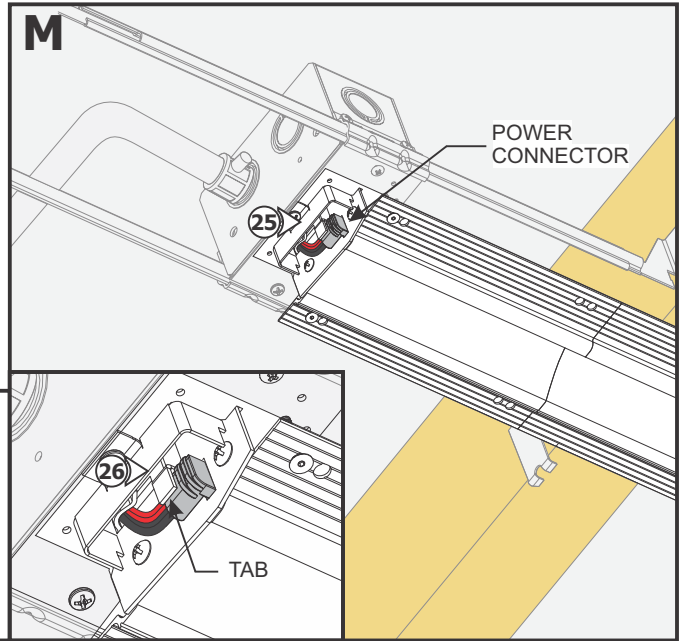

NOTE: Note the alignment of the red +24VDC connection of the power connector to ensure proper alignment when installing LED strip in later steps.

25: Place the power connector into the open slot of the end cap cover.

26: Use needle-nose pliers to bend the tab on the end cap cover to secure the power connector in place.

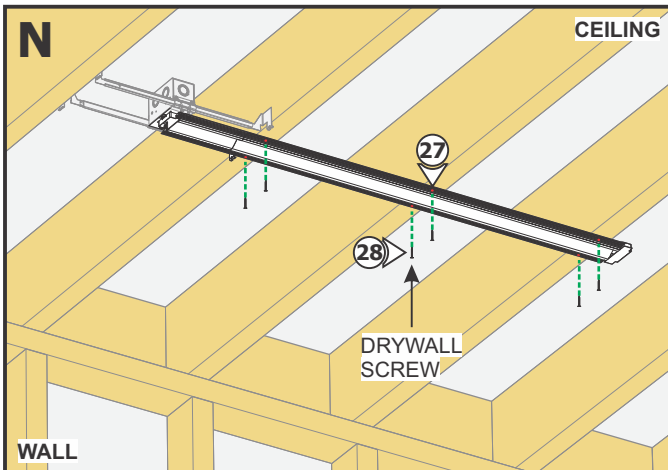

27: Drill and countersink holes to the channel at marked joist locations.

28: Secure channel to the joists using drywall screws.

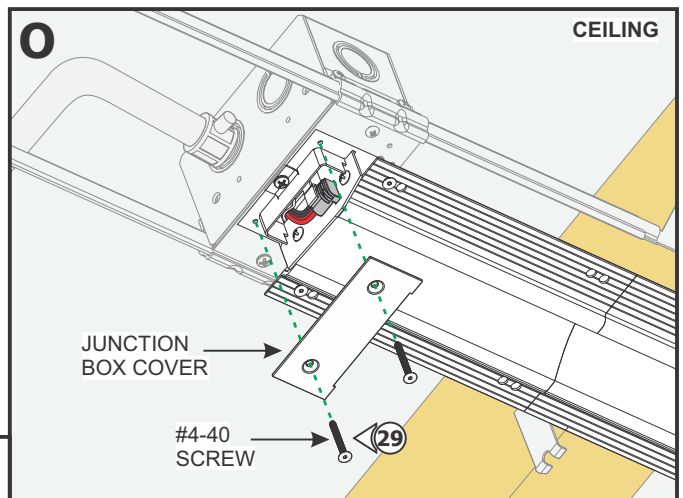

29: Secure the junction box cover to the mounting plate using the two #4-40 screws.

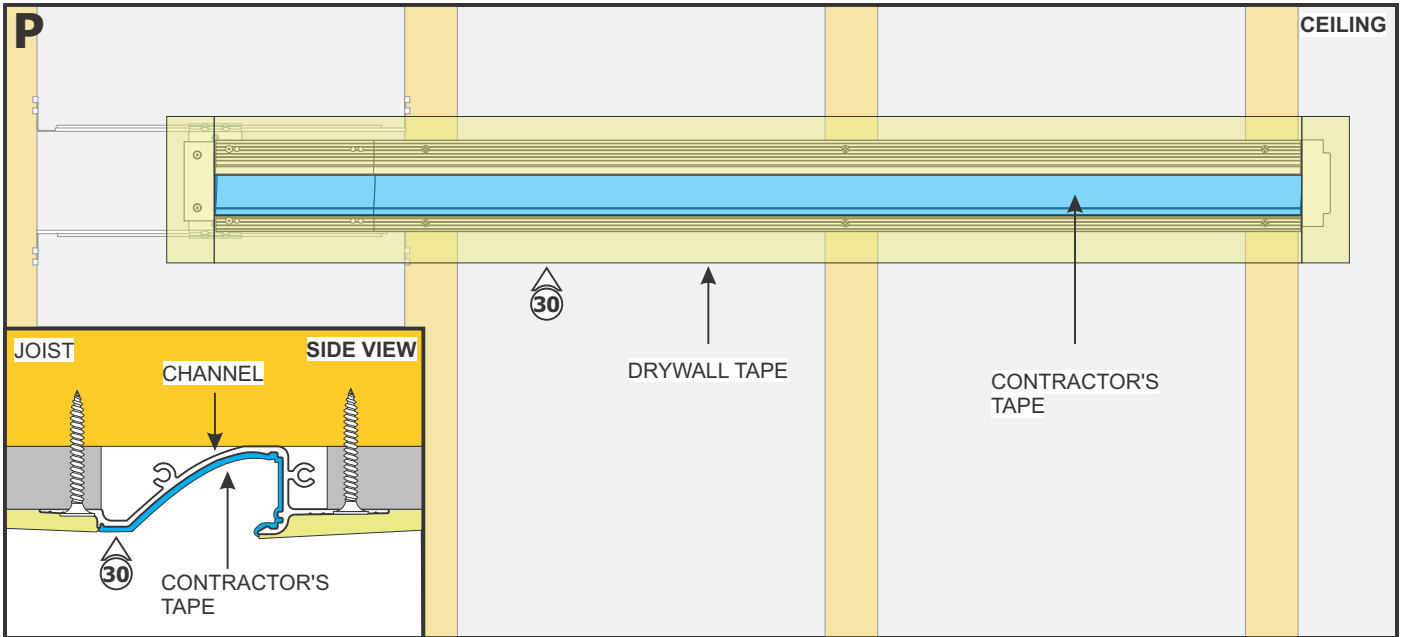

NOTE: Cover the channel opening with contractor's tape before plastering.

NOTE: For areas with lots of vibrations, it is suggested to use Durabond to avoid cracking of plaster.

NOTE: **Do Not use premixed joint compound "Soft Mud." No use compuesto para juntas premezclado "Soft Mud."**

30: Must apply drywall tape (Ultra-Thin drywall tape suggested) along edges of channel to prevent cracking of plaster after installation. **Do Not** overlap strips of drywall tape.

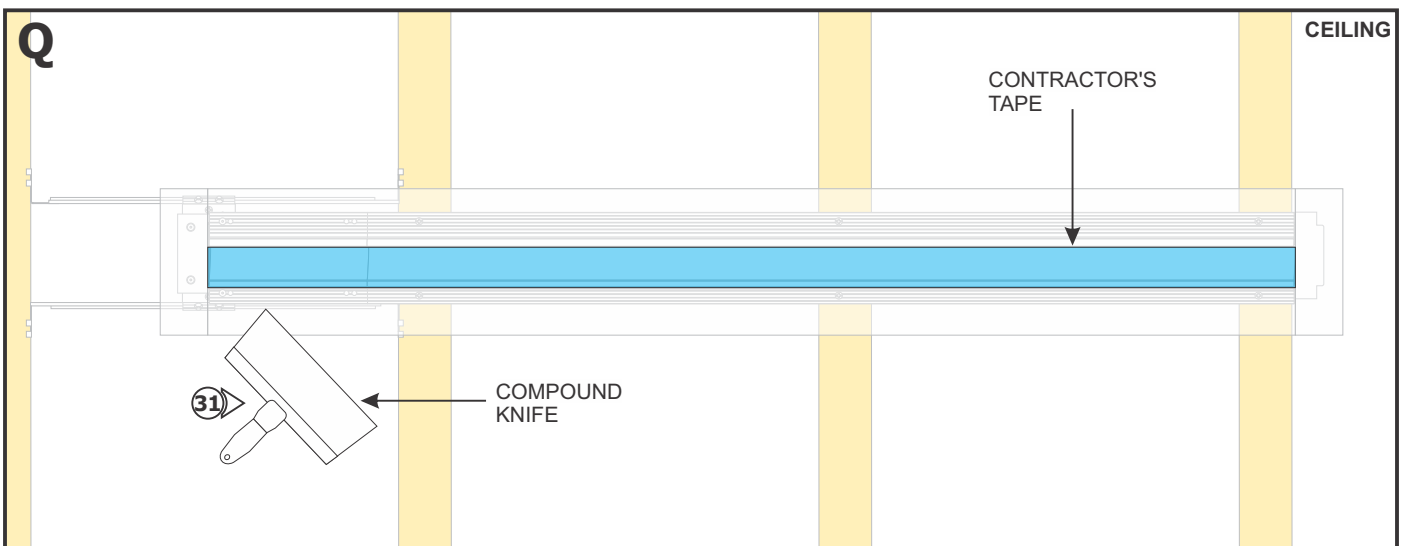

31: Use a compound knife for a smooth compound spread. Sand, paint, and finish the plaster and drywall before removing the contractor's tape.

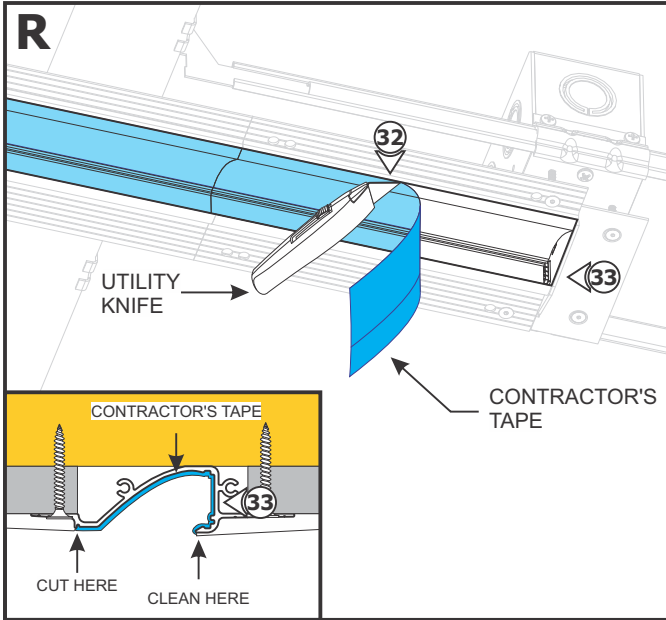

32: Use a utility knife to cut along the channel gutter while removing the contractor's tape from the channel. This will avoid plaster and paint damage during tape removal.

33: Run the utility knife along the channel edge near the area where the LED strip will be installed to remove any excess paint.

NOTE: Clean the channel area where the LED strip will be installed with alcohol to remove any dust or debris before continuing.

NOTE: If installation requires RGB, RGB+W, or Tunable White, refer to wiring diagrams on pages 8-10.

34: Carefully remove the backing from the LED strip, making sure not to remove the tape from the LED strip. Line up the red wire side of the power connector with the "+24VDC" marking on the LED strip. Push the male connector of the strip into the power connector.

35: Firmly press down the adhesive portion of the LED strip onto the channel surface while removing the rest of the backing, making sure there are no air bubbles that can cause surface irregularities.

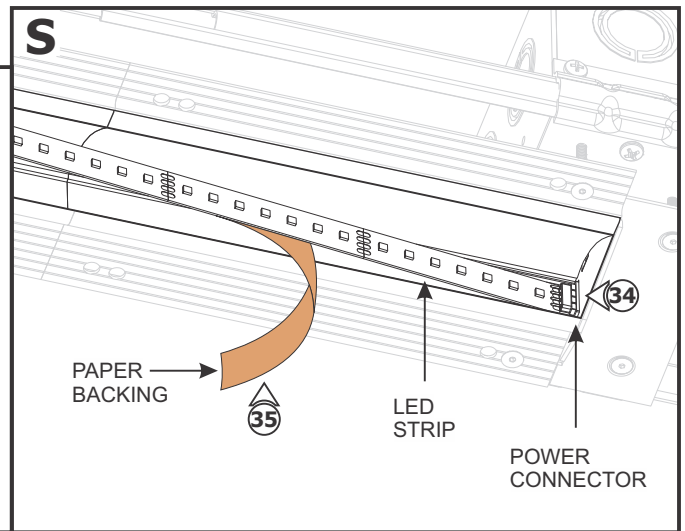

36: If required, trim the LED strip on the dashed cuttable section and place the excess LED strip inside the take-up box. Ensure the entire length of the channel is covered with LED strips to avoid unlit areas.

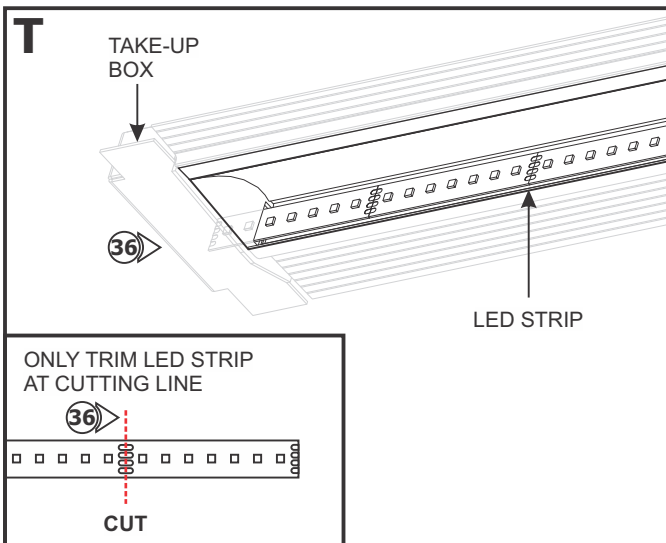

37: Snap the lens onto the channel. Ensure the lenses are fully seated.

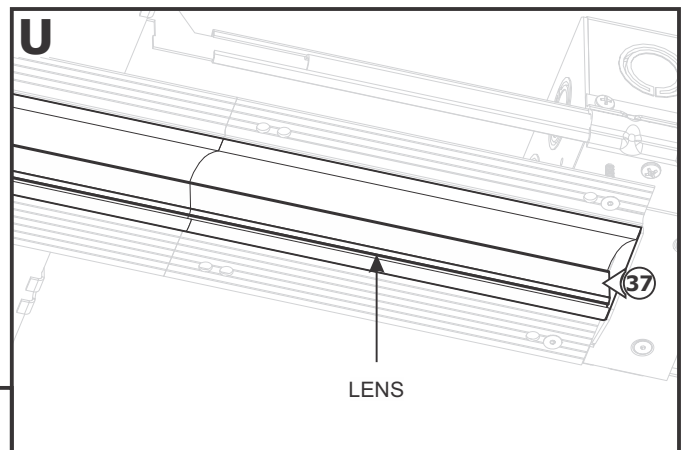

IMPORTANT INFORMATION REGARDING INSTALLATION AND REWORK OF SOFT STRIP LED

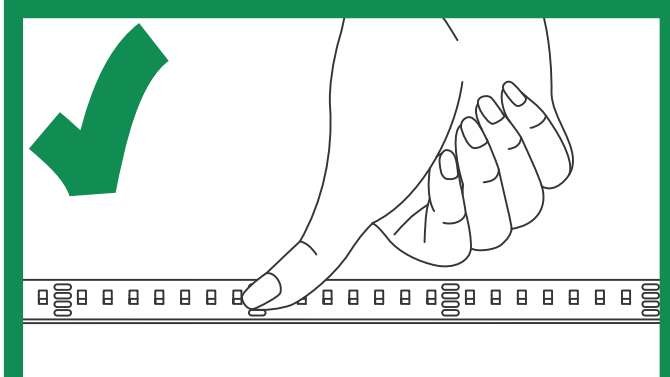
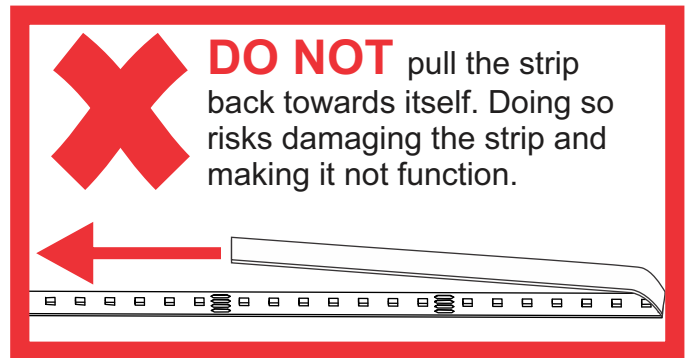
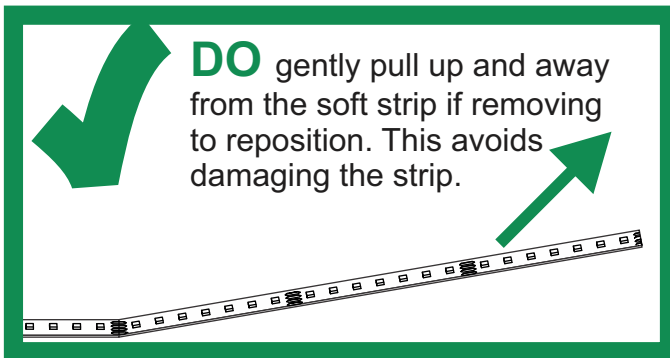

DO only ever use fingers to gently install soft strip to a surface **AFTER** cleaning the surface with alcohol.

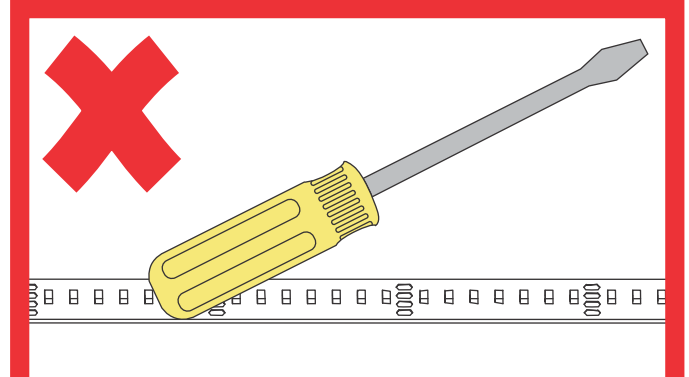

DO NOT use any tool to install soft strip to a surface. This will damage the soft strip component.

Relocating Soft Strip (Optional)

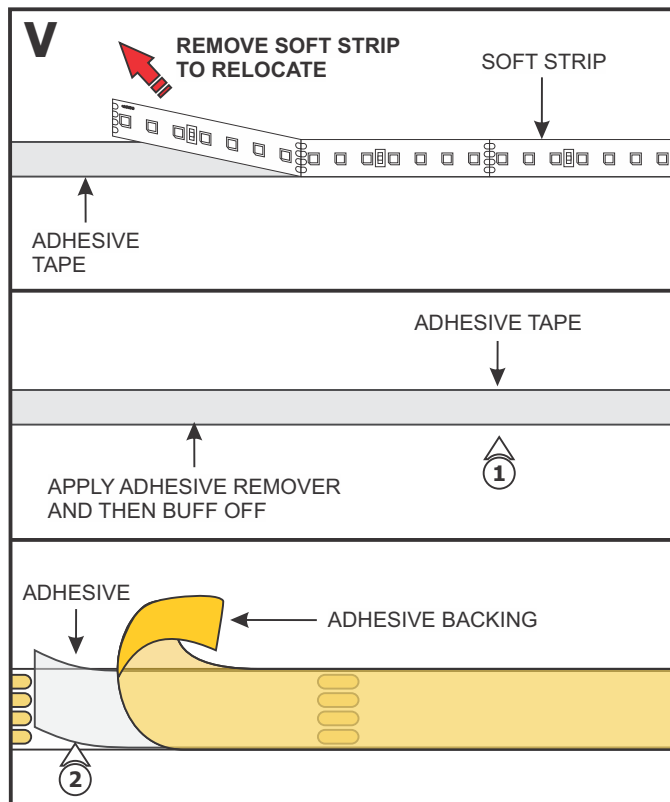

NOTE: If relocating the installed soft strip, make sure that the adhesive tape on back of the soft strip covers the entire strip. The adhesive tape isolates the strip from the installation surface. Damaged or inconsistent adhesive tape may cause the contacts on the back of the strip to come in contact with the conductive heat sink which will cause the strip to short and burn. Call Edge Lighting to get replacement adhesive tape and/or optional aluminum heat sink tape (SS-HR-F).

- 1: To remove tape residue from back of the strip, apply WD-40, Goo Gone, or a mixture of warm water and lemon oil to the corner of a clean, dry towel. Gently buff the area containing the adhesive residue until it is completely removed.
- 2: Gently remove a few inches from one side of the tape backing. Attach the adhesive tape to the back of the soft strip and apply moderate pressure to affix the tape. Continue this step a few inches at the time until the entire adhesive tape is attached to back of the soft strip.
- 3: Refer to steps 34 through 36 to reinstall the soft strip.

Wiring Diagrams

General 0-10V Configuration

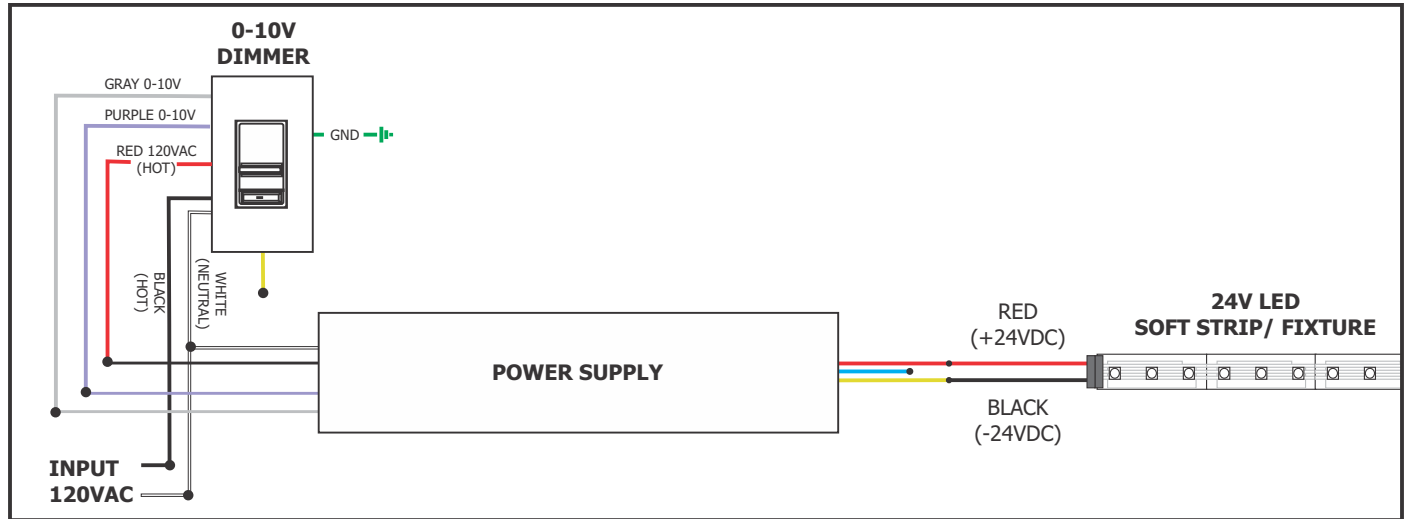

General 24VDC Configuration

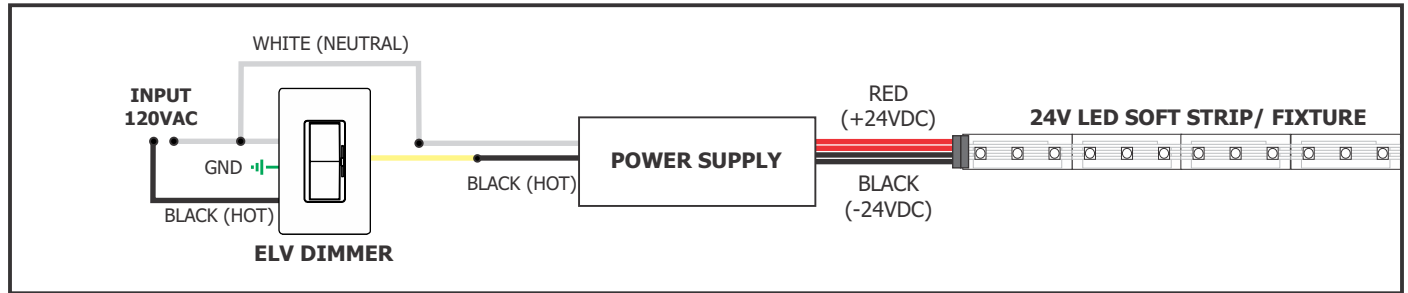

RGB Configuration

Using LED Power Supply with RGB Soft Strip & CDP, CTP or CDMX Control

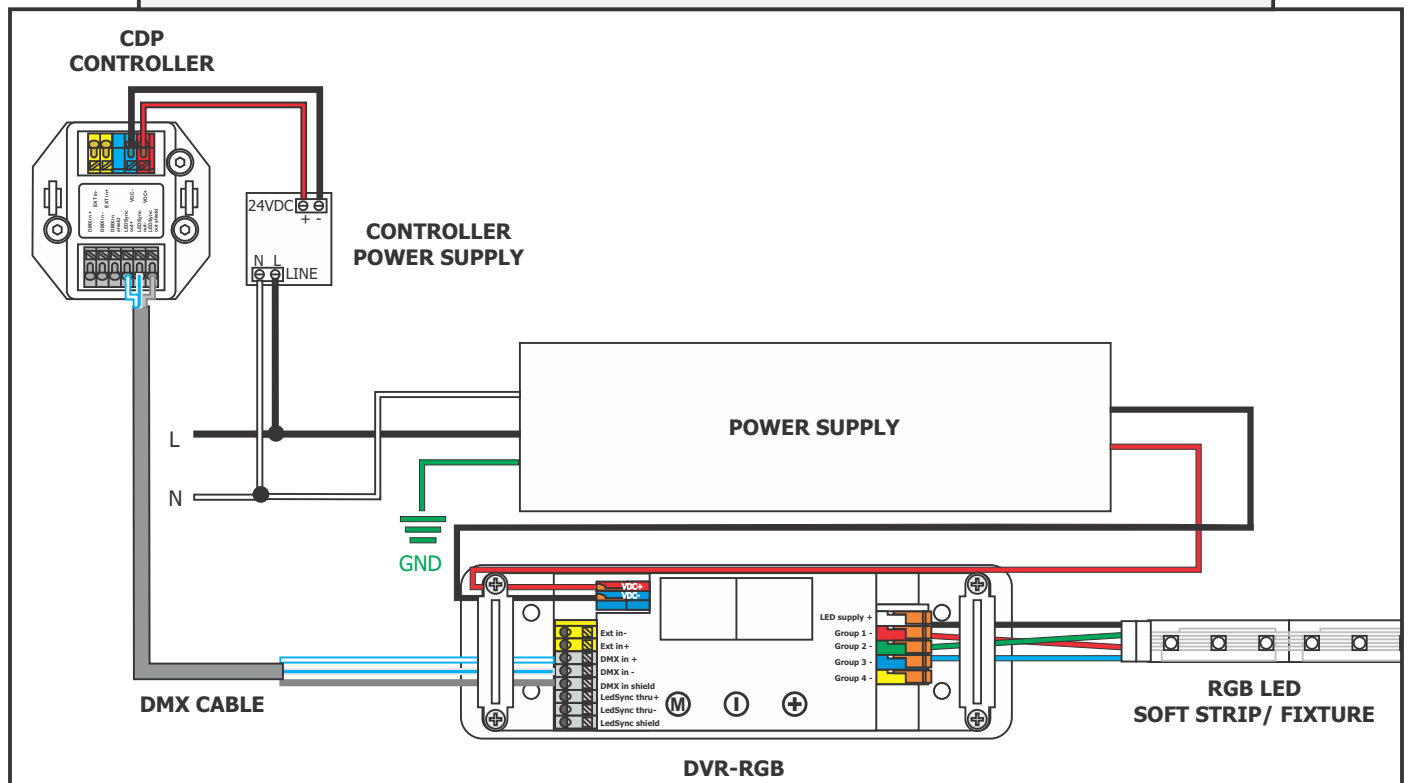

RGB+W Configuration

Using LED Power Supply with RGB+W Soft Strip & CDP, CTP or CDMX Control

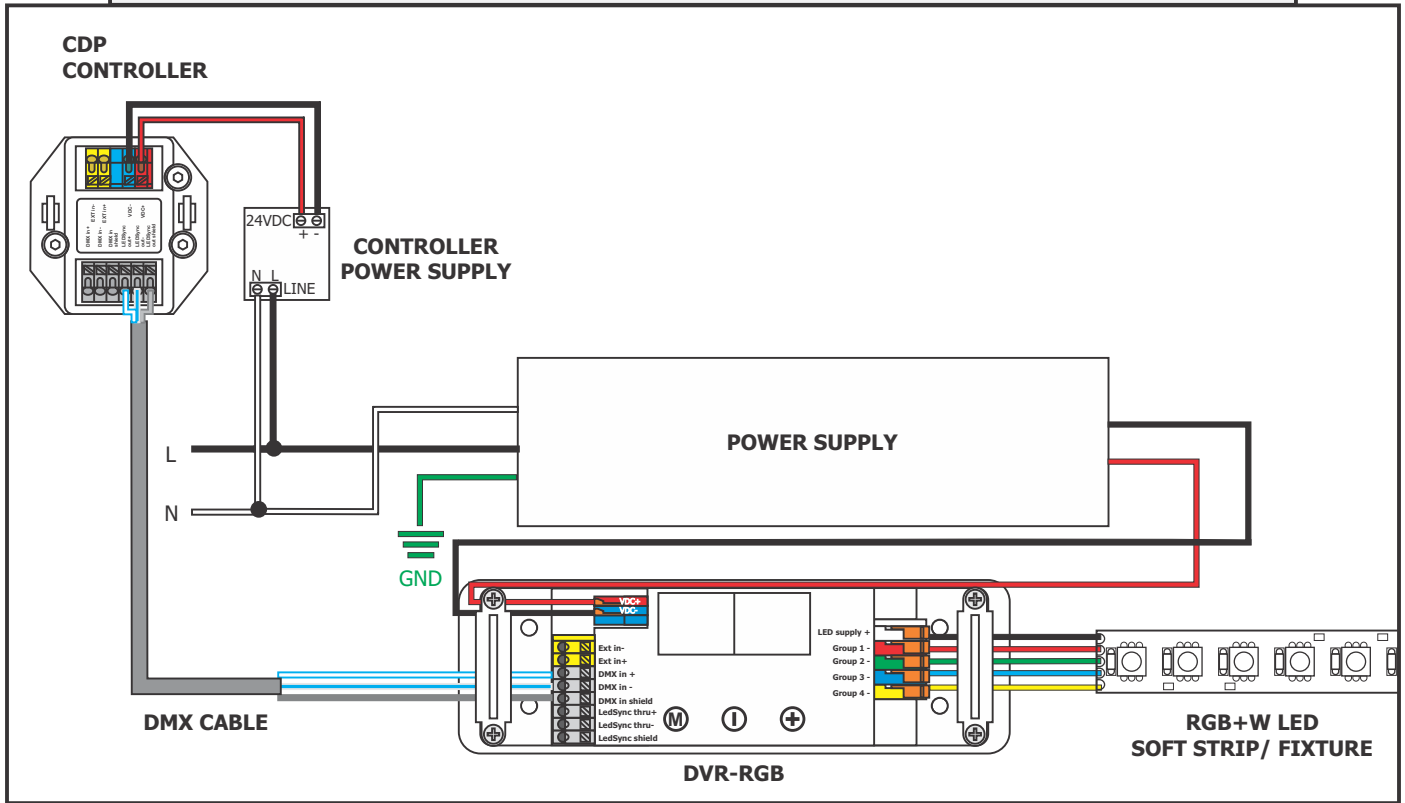

Tunable White Configuration

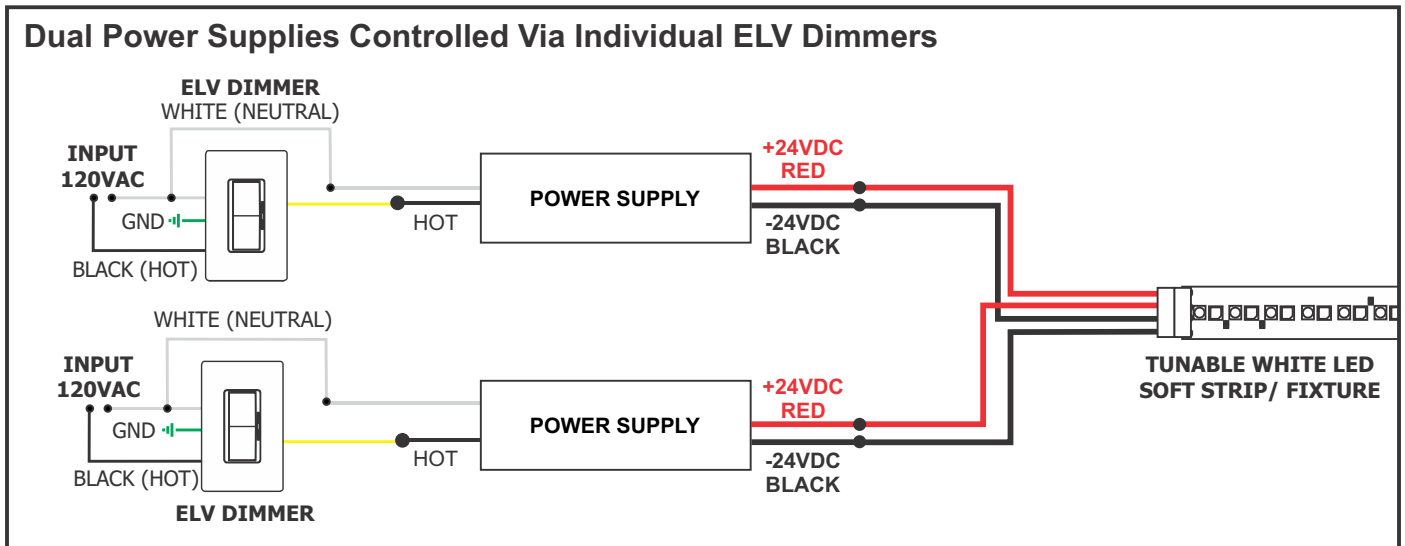

Tunable White Configuration

