

Description: TruQuad .5A, a versatile 24VDC linear plaster-in LED system, creates glare-free, indoor architectural lighting. The system recesses into 5/8 inch thick drywall without joist modification. May be secured to studs that are spaced 13 – 24 inches apart, or between studs with mounting clips provided. Sold in 1 inch increments from 6 – 400 inches (6 – 384 inches for RGBW). Several color temperature options are available, including 24K – 57K (ELV/010), Warm Dim (ELV), Tunable White (ELV/010/DMX), RGB and RGBW (DMX). High CRI commercial-grade white or dynamic color-changing LED Soft Strip projects a clean line of light. Coordinate installation with electrician and drywall contractors. Includes a 5-year pro-rated warranty.

Design Note: TruQuad can be installed on a single surface (wall or ceiling) and allows for the creation of personalized square or rectangular configurations. LED Soft Strip mounts to side wall of the channel, wrapping continuously to create seamless illumination.

Applications: Indoor damp or dry locations only. General illumination and architectural accent for kitchens, offices, hospitality, retail, residences, libraries, hallways, and bath/vanity.

Lamp: The average LED Life is 50,000 hours

Watts per Foot	Lumens per Watt	Lumens per Foot	85+CRI 24k, 35K, 40K, 57K	90+CRI 2K4K	92+CRI 27D, 30D	95+CRI 27K, 30K	RGB	RGBW
2WDC (2.5WDC)	52	169	•			•		
5WDC	50	244	•	•	•	•	•	
6WDC	N/A	N/A						•

Lumen values are based on the 3000K LED test.

Remote Power Supplies*, Dimmers & Controls (Sold Separately):

- Electronic Low Voltage Dimming (ELV)
- 0-10 Volt Dimming (0-10V)
- Dynamic Color Changing (DMX)

*In-Wall Mounting Kits available for select power supplies

Included Components: TruLine .5A Channel(s), Power Channel Connector(s) with Junction Box, Channel Joiners, Mounting Straps, Drywall Screws, LED Soft Strip, and Lens(es)

ORDERING CODE

System	Watts Per Foot	Short Side	Long Side	Color Temperature
TL.5A	2W	6	400	27K
TL.5A TruLine .5A	2W 2.5 Watts 5W 5 Watts 6W 6 Watts	6 - 400 inches (1" increments) per side, RGBW max 384"	6 - 400 inches (1" increments) per side, RGBW max 384"	24K 2400K Amber White 27K 2700K Very Warm White 27D 2700K Warm Dim (5W Only) 30K 3000K Warm White 30D 3000K Warm Dim (5W Only) 35K 3500K Neutral White 40K 4000K Cool White 57K 5700K Daylight White 2K4K 2000K - 4000K Tunable White (5W Only) RGB Red, Green, and Blue (5W Only) RGBW Red, Green, Blue, and 2000K White (6W Only, 384" Max)

For custom design and layout assistance, send drawings to design@PureEdgeLighting.com

COMPANY		FIXTURE TYPE		DATE	
PROJECT		APPROVED BY			

Product specification subject to change without notification. REV.02.21.17





INCLUDED COMPONENTS

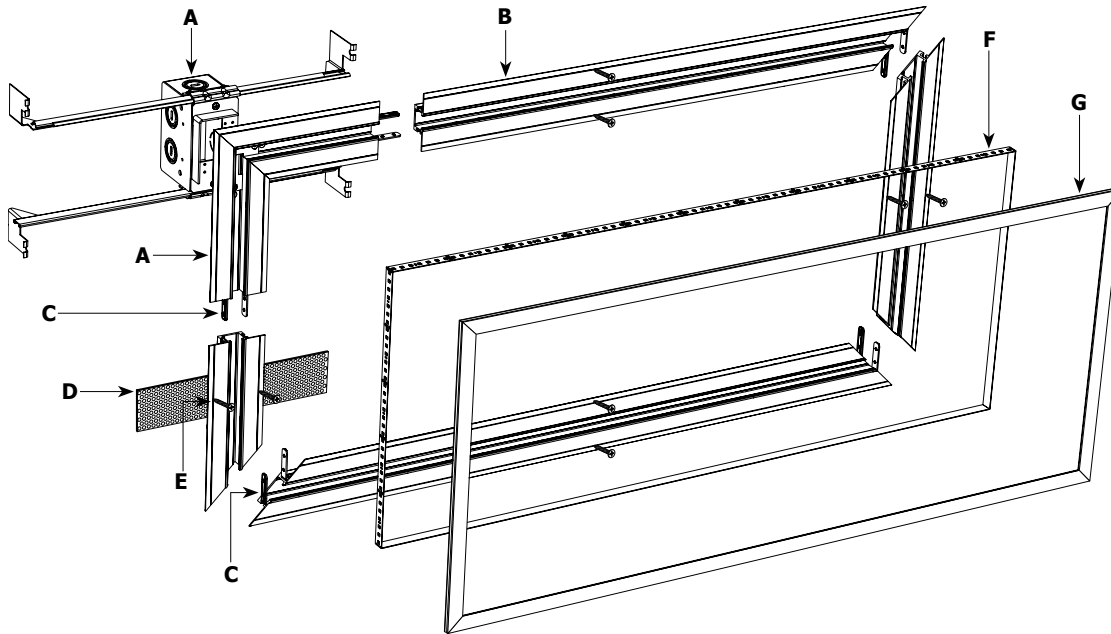

A. Power Channel Connectors with Junction Box: TruQuad includes 1, 2 or 4 L-Picture Frame Power Channel Connectors based on max wattage of design. Low voltage 24VDC wires from remote power supply connect to LED wires inside Junction box. Junction Box opening is covered by the channel and comes with Adjustable Mounting Bars. Required at the beginning of each run and necessary to rough-in electrical before TruQuad installation.

B. TruQuad .5A Channel: 5/8 inch deep extrusion houses a single row of commercial-grade white or dynamic color-changing LED Soft Strip.

C. Channel Joiners: Channel Joiners ship as a pair to connect two channels together. Additional channel joiners may be necessary based on lighting design.

D. Mounting Strap: Secures channel to drywall when wall stud is unavailable.

E. Drywall Screw: Secures channel to drywall and stud.

F. LED Soft Strip: Commercial grade white or dynamic color-changing LED Soft Strip.

G. Lens: 0.5 inch wide diffuser lens projects a clean line of light without LED dots.

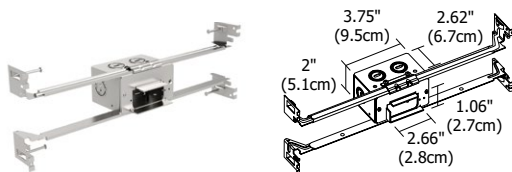

Rough-In Component

Junction Box: One Junction Box is included with TruQuad .5A. Order additional Junction Box separately to rough-in electrical wiring before drywall installation. Quick shipment available.

System	Size	Component
TL.5A	-	1RE - JBOX
TL.5A TruLine .5A	1RE 1" Rectangle	JBOX Junction Box

COMPANY		FIXTURE TYPE		DATE	
PROJECT		APPROVED BY			

Product specification subject to change without notification. REV.02.21.17



TruQuad .5A, 24VDC Plaster-In LED system



INSTALLATION

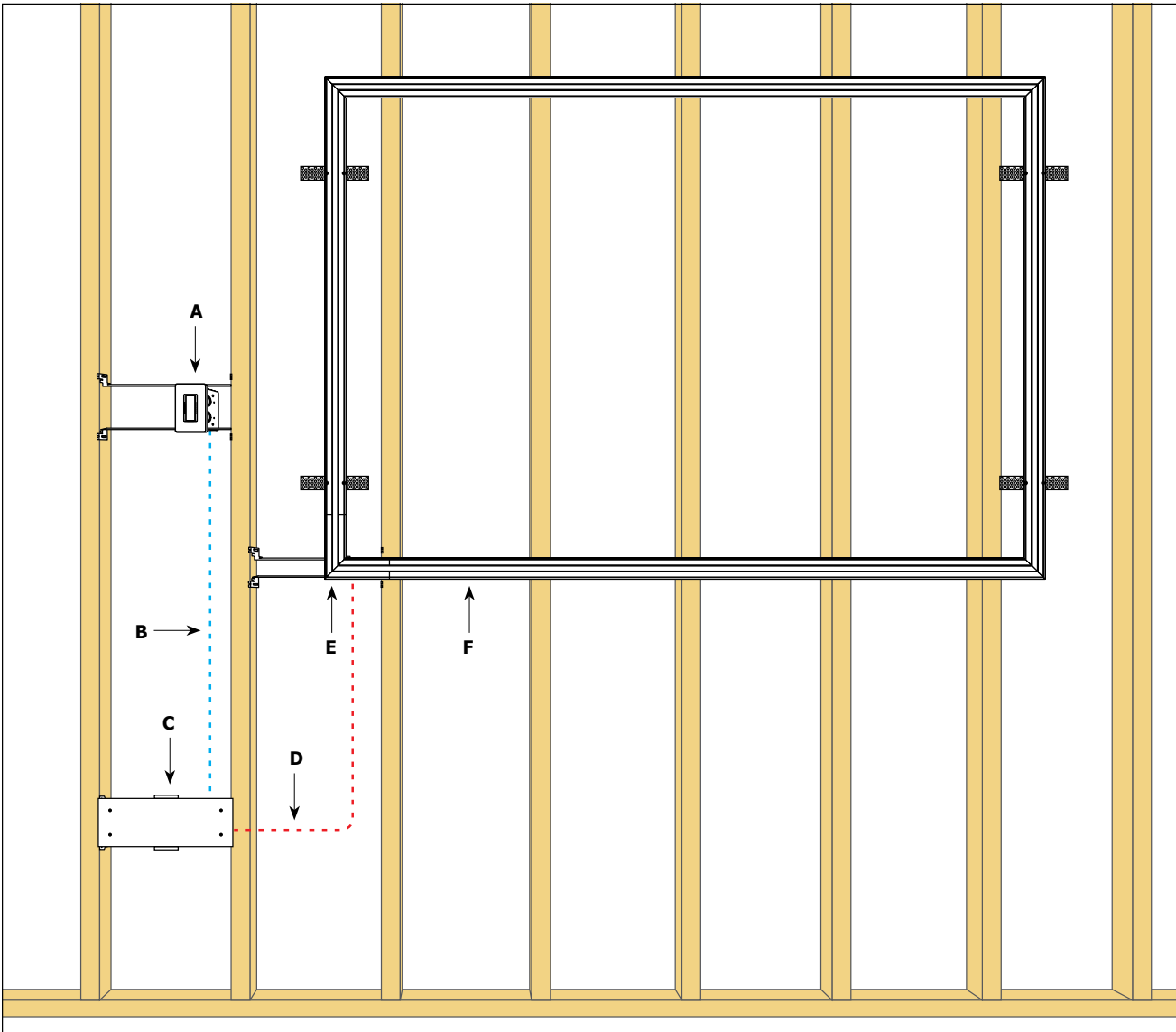

- A. Dimmer or Switch
- B. 120VAC wiring
- C. 120V/24VDC remote power supply with In-Wall Mounting Kit
- D. 24VDC, Class 2 wiring
- E. L-Picture Frame Power Channel Connector with Junction Box
- F. TruQuad Channel

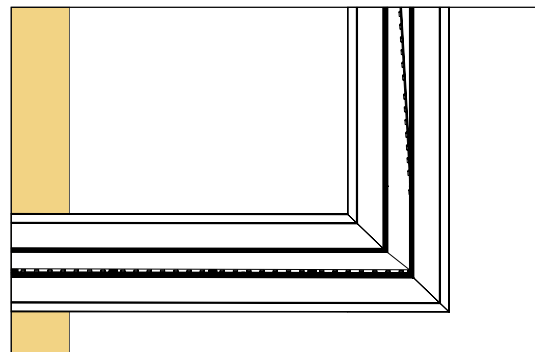

LEDs on Side of Channel

COMPANY		FIXTURE TYPE		DATE	
PROJECT		APPROVED BY			

Product specification subject to change without notification. REV.02.21.17





Application: 0-10V dimming for TruQuad .5A Channel
Power Supply: PSB-96W-010-24VDC (24VDC 96W output) | PSB-2X96W-010-24VDC (24VDC 2X96W output).
Dimming: Radio Ra2 (with GRX-TVI), Grafik Eye Qs (with GRX-TVI), Diva (with PP20); Nova T; Philips: Sunrise SR1200ZTUNV; Leviton: IP710-LF.

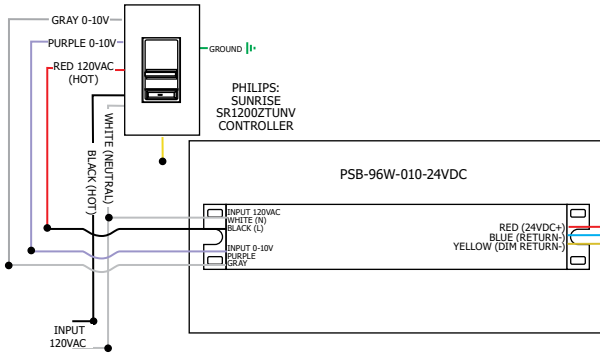

96W, 24VDC LOW VOLTAGE WIRE SIZE CHART: 3% VOLTAGE DROP

WIRE LENGTH (FT)	UP TO 33FT	34FT-52FT	53FT-86FT	87FT-130FT
WIRE SIZE	14 AWG	12 AWG	10 AWG	8 AWG
VOLTAGE AT END OF WIRE	23.28VDC	23.29VDC	23.28VDC	23.28VDC

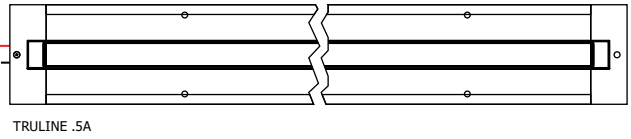

A Division of PureEdge Lighting 1718 W. Fullerton Chicago, IL 60614 • Ph: 773.770.1196 • Fax: 773.883.6128 • www.purelighting.com



COMPANY		FIXTURE TYPE		DATE	
PROJECT		APPROVED BY			