

NEW CONSTRUCTION PLATE INSTALLATION GUIDE – WARNING

WARNING – Read all product labels and instructions before installing fixture.

WARNING – Wear safety gloves and other appropriate safety equipment.

NCPLATE/T4689 INCLUDES:

1 x L-bracket 

8 x M4 Screws 

TO COMPLETE INSTALLATION YOU WILL NEED:

Cutting Pliers 

Philips PH2 screw driver 

DOWNLIGHT COMPATIBILITY & CIRCULAR KNOCKOUT (KO) SIZING

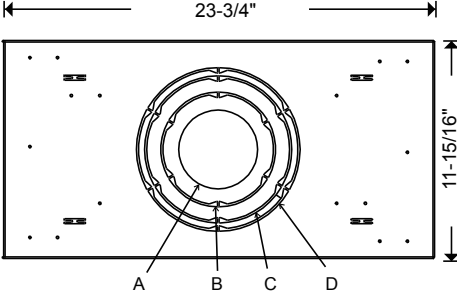
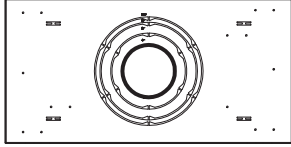
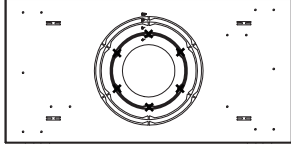
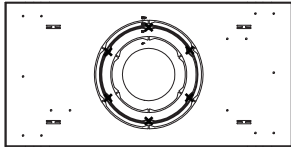
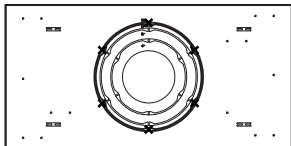
New Construction Plate Dimensions	Compatible Products	Circular Knockout (KO) Instructions
 <p style="margin-top: 20px;">A: Ø4-5/16" B: Ø6-5/16" C: Ø8-1/16" D: Ø9"</p>	<p style="text-align: center;"><u>THINFIT 4"</u> 8.5DLNC4DIM/xxx 10NCDLR4DIM/9xx/EXT 10NCDLR4DIM/9xx/277V/EXT <u>INNOFIT 4"</u> 14CDLA6/xxx/277V <u>SPECFIT 4"</u> AD4LExxxxDIMxxxAD4Rxx <u>SELECTFIT 4"</u> SLFT4/xxCCTx/DIMx</p>	 <p style="margin-top: 5px;">Use KO for 4" fixtures</p>
<p style="margin-top: 20px;">A: Ø4-5/16" B: Ø6-5/16" C: Ø8-1/16" D: Ø9"</p>	<p style="text-align: center;"><u>THINFIT 6"</u> 11.6DLNC6DIM/xxx 12NCDLR6DIM/9xx/EXT 12NCDLR6DIM/9xx/277V/EXT <u>INNOFIT 6"</u> 21CDLA6/xxx/277V <u>SPECFIT 6"</u> AD6LExxxxDIMxxxAD6Rxx <u>SELECTFIT 6"</u> SLFT6/xxCCTx/DIMx</p>	 <p style="margin-top: 5px;">Remove KO for 6" fixtures</p>
<p style="margin-top: 20px;">A: Ø4-5/16" B: Ø6-5/16" C: Ø8-1/16" D: Ø9"</p>	<p style="text-align: center;"><u>THINFIT 8"</u> 24.5NCDLR8DIM/9xx/EXT 24.5NCDLR8DIM/9xx/277V/EXT <u>INNOFIT 8"</u> 27CDLA8/xxx/277V <u>SPECFIT 8"</u> AD8LExxxxDIMxxxAD8Rxx <u>SELECTFIT 8"</u> SLFT8/xxCCTx/DIMx</p>	 <p style="margin-top: 5px;">Remove KO for 8" fixtures</p>
<p style="margin-top: 20px;">A: Ø4-5/16" B: Ø6-5/16" C: Ø8-1/16" D: Ø9"</p>	<p style="text-align: center;"><u>INNOFIT 9.5"</u> 45CDLA9.5/xxx/277V <u>SPECFIT 9.5"</u> AD9.5LExxxxDIMxxxAD8Rxx <u>SELECTFIT 9.5"</u> SLFT9.5/xxCCTx/DIMx</p>	 <p style="margin-top: 5px;">Remove KO for 9.5" fixtures</p>

NEW CONSTRUCTION PLATE T-GRID INSTALLATION

1. If applicable, using cutting pliers, remove any KO sections necessary to install the selected downlight. (fig. 1)

2. For new construction installations or when required by local building code, attach the NCPLATEJB* J-box (sold separately) in the appropriate location using the pre-drilled mounting holes and provided screws. (fig. 2)

3. If applicable, install Emergency Battery Pack* (sold separately) into the mounting holes using the screws provided. (fig. 3)

5. Place the NCPLATE/T on top of the T-Grid tile where the downlight will be installed. Screw the NCPLATE/T to the sides of the T-Grid through the plate's flange holes. (fig. 4)

6. If applicable secure the downlight's driver*.

For THINFIT EXT:

Bend the driver box's middle clip downward and slide it around one of the accessible plate's finger tabs to secure the driver. (fig 5)

For SPECFIT:

Attached the L bracket (included) into the mounting holes (fig. 6), then bend out one of the screw hole tabs of the driver box. Slide the driver in the tab of the preinstalled L bracket, through the squared sliding hole of the driver box. Finally secure the driver box to the L bracket with a screw through the bended screw hole tabs of the driver box and the predrilled hole of the L bracket. (fig. 6 & 7)

7. Connect power per individual fixture instructions.

8. Once the plate is attached to the T-Grid, cut a hole in the tile following the inside of the selected CKO. (fig. 8)

9. Follow individual installation instructions to complete the fixture installation. (fig. 9 & 10)

*At the discretion of the installer, NCPLATEJB, Emergency Battery Packs and driver boxes can be secured to the ceiling structure by alternate methods to meet NEC and local building codes without the use of the new construction plate.

fig. 1

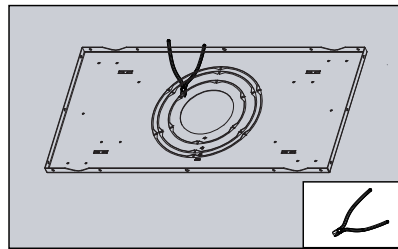

fig. 2

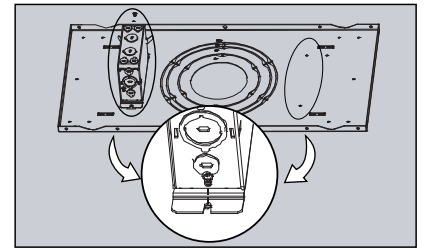

fig. 3

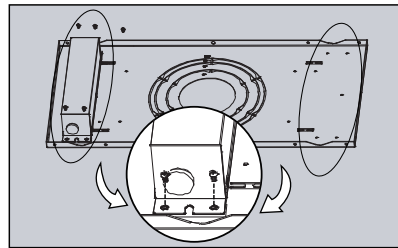

fig. 4

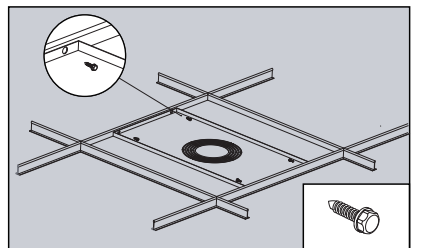

fig. 5

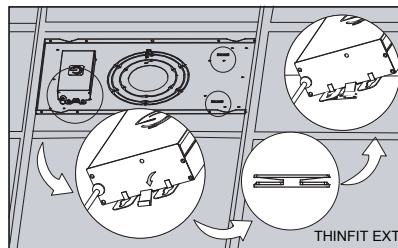

fig. 6

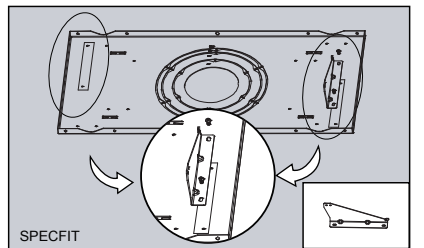

fig. 7

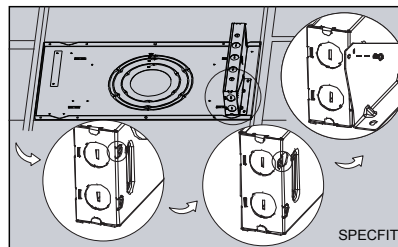

fig. 8

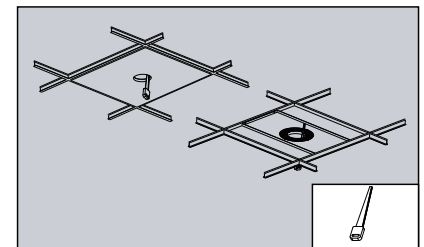

fig. 9

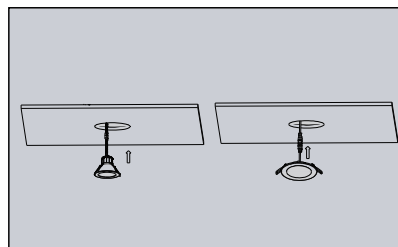
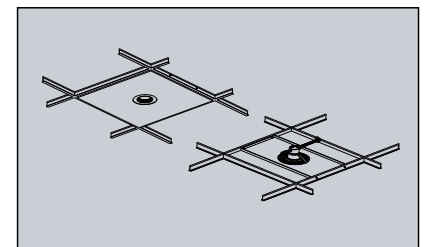
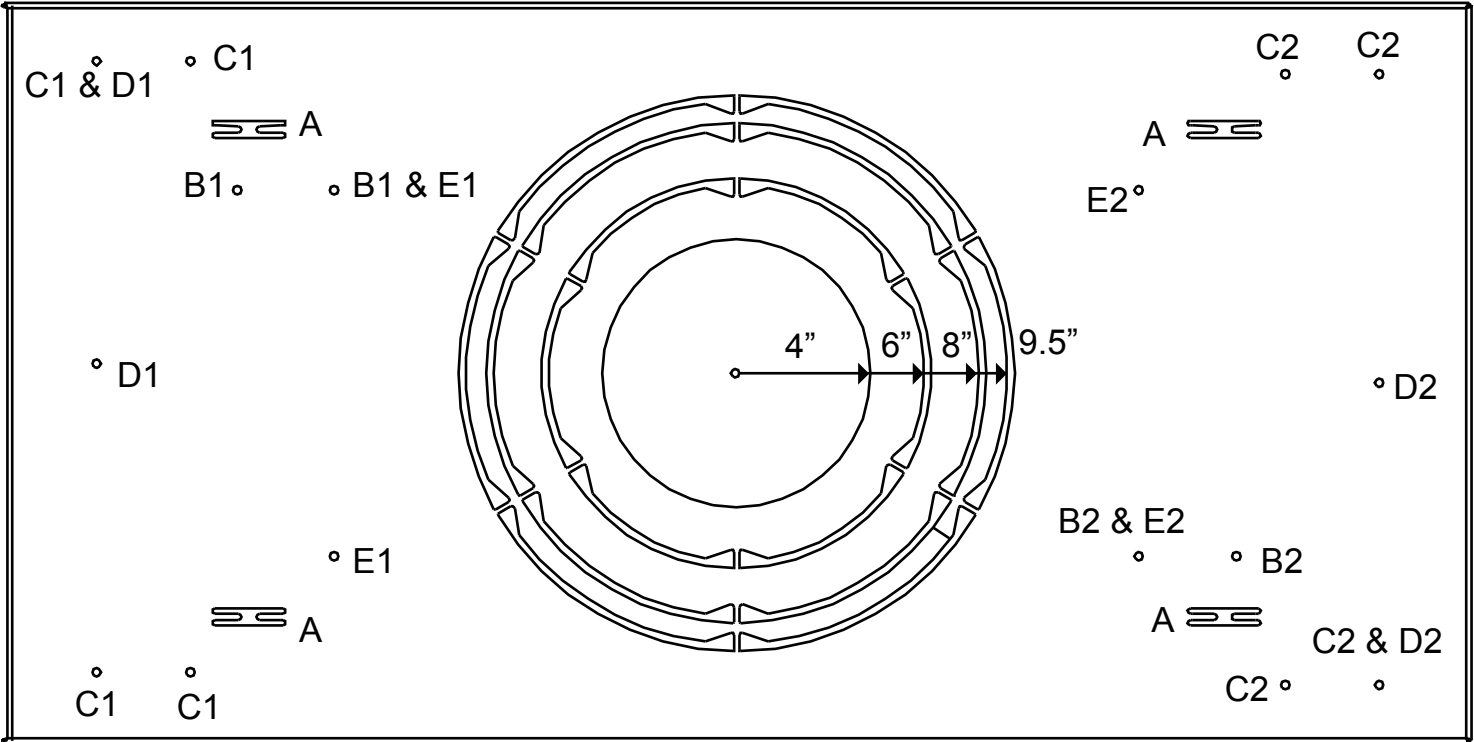

fig. 10



NEW CONSTRUCTION PLATE T-GRID INSTALLATION



- A = Finger tabs for THINFIT EXT installation using clip hook installation
- B = Screw holes for THINFIT EXT using key slot holes installation
- C = Screw holes for Emergency Battery Pack installation
- D = Screw holes for SPECFIT driver Bracket installation
- E = Screw holes for NCPLATEJB installation

A = THINFIT EXT with finger tabs

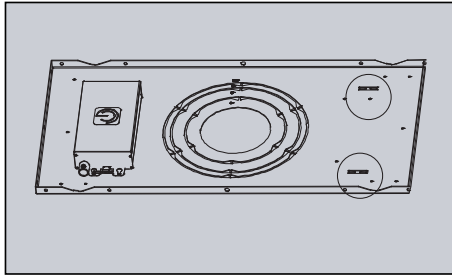

B = THINFIT EXT with key holes

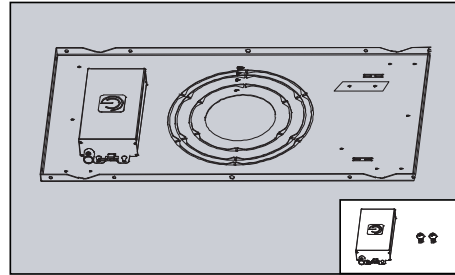

C = Emergency Battery Pack

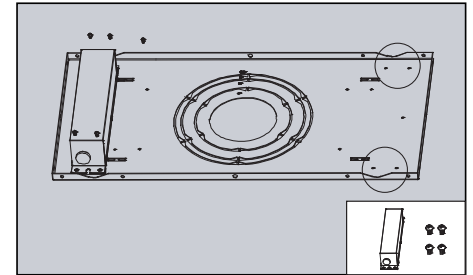

D = SPECFIT driver bracket

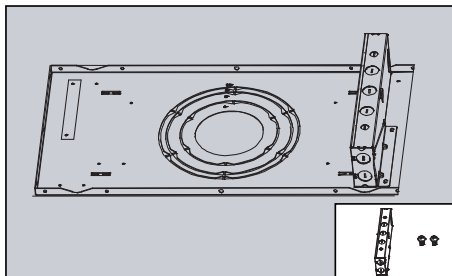

E = NCPLATEJB Installation

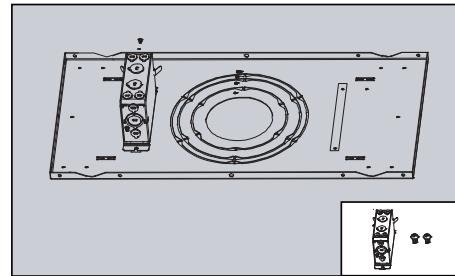



NEW CONSTRUCTION PLATE INSTALLATION GUIDE – WARNING

WARNING – Read all product labels and instructions before installing fixture.

WARNING – Wear safety gloves and other appropriate safety equipment.

NCPLATE468 INCLUDES:

1 x L-bracket 

8 x M4 Screws 

TO COMPLETE INSTALLATION YOU WILL NEED:

Cutting Pliers 

Philips PH2 screw driver 

DOWNLIGHT COMPATIBILITY & CIRCULAR KNOCKOUT (KO) SIZING

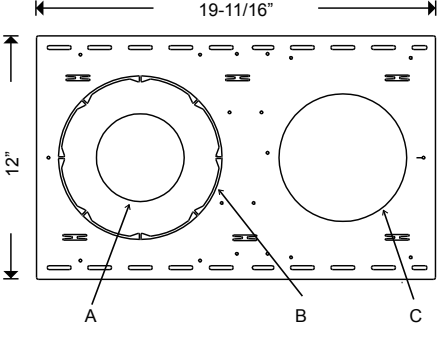
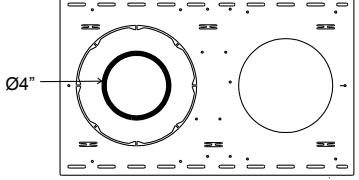
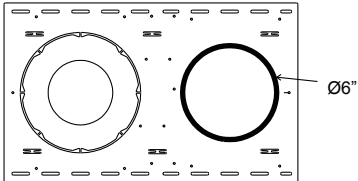
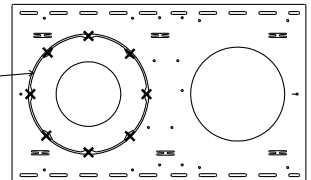
New Construction Plate Dimensions	Compatible Products	Circular Knockout (KO) Instructions
 <p style="margin-top: 10px;">A: Ø4-5/16" B: Ø8-1/16" C: Ø6-5/16"</p>	<p style="text-align: center;"><u>THINFIT 4"</u> 8.5DLNC4DIM/xxx 10NCDLR4DIM/9xx/EXT 10NCDLR4DIM/9xx/277V/EXT</p> <p style="text-align: center;"><u>INNOFIT 4"</u> 14CDLA6/xxx/277V</p> <p style="text-align: center;"><u>SPECFIT 4"</u> AD4LExxxxDIMxxxxAD4Rxx</p> <p style="text-align: center;"><u>SELECTFIT 4"</u> SLFT4/xxCCTx/DIMx</p>	 <p style="text-align: center;">Use KO for 4" fixtures</p>
Dimensions are shared with the first row	<p style="text-align: center;"><u>THINFIT 6"</u> 11.6DLNC6DIM/xxx 12NCDLR6DIM/9xx/EXT 12NCDLR6DIM/9xx/277V/EXT</p> <p style="text-align: center;"><u>INNOFIT 6"</u> 21CDLA6/xxx/277V</p> <p style="text-align: center;"><u>SPECFIT 6"</u> AD6LExxxxDIMxxxxAD6Rxx</p> <p style="text-align: center;"><u>SELECTFIT 6"</u> SLFT6/xxCCTx/DIMx</p>	 <p style="text-align: center;">Use KO for 6" fixtures</p>
Dimensions are shared with the first row	<p style="text-align: center;"><u>THINFIT 8"</u> 24.5NCDLR8DIM/9xx/EXT 24.5NCDLR8DIM/9xx/277V/EXT</p> <p style="text-align: center;"><u>INNOFIT 8"</u> 27CDLA8/xxx/277V</p> <p style="text-align: center;"><u>SPECFIT 8"</u> AD8LExxxxDIMxxxxAD8Rxx</p> <p style="text-align: center;"><u>SELECTFIT 8"</u> SLFT8/xxCCTx/DIMx</p>	 <p style="text-align: center;">Remove KO for 8" fixtures</p>

NEW CONSTRUCTION PLATE DRYWALL INSTALLATION

1. If applicable, using cutting pliers (not provided), remove any KO sections necessary to install the selected downlight. (fig. 1)

2. For new construction installations or when required by local building code, attach the NCPLATEJB* J-box (sold separately) in the appropriate location using the pre-drilled mounting holes and provided screws. (fig. 2)

3. If applicable, install Emergency Battery Pack* (sold separately) into the mounting holes using the screws provided. (fig. 3)

4. Nail or screw the NCPLATE468 to the ceiling's studs/joists. Note NCPLATE468 allows a maximum spacing of 24". Use the spacing distance marks on the side of the plate to center the downlight as desired. (fig. 4)

6. If applicable secure the downlight's driver*.

For THINFIT EXT:

Bend the driver box's middle clip downward and slide it around one of the accessible plate's finger tabs to secure the driver. (fig 5)

For SPECFIT:

Attached the L bracket (included) into the mounting holes (fig. 6), then bend out one of the screw hole tabs of the driver box. Slide the driver in the tab of the preinstalled L bracket, through the squared sliding hole of the driver box. Finally secure the driver box to the L bracket with a screw through the bended screw hole tabs of the driver box and the predrilled hole of the L bracket. (fig. 7)

7. Connect power per individual fixture instructions.

8. Follow individual installation instructions to complete the fixture installation.(fig. 9 & 10)

*At the discretion of the installer, NCPLATEJB, Emergency Battery Packs and driver boxes can be secured to the ceiling structure by alternate methods to meet NEC and local building codes without the use of the new construction plate.

fig. 1

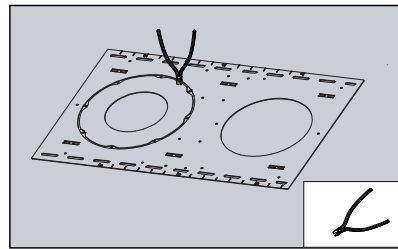

fig. 2

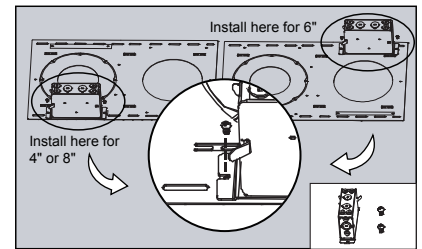

fig. 3

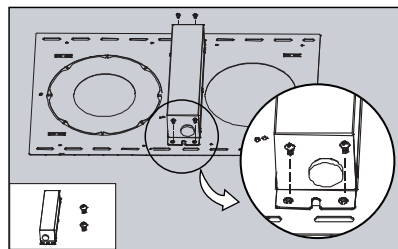

fig. 4

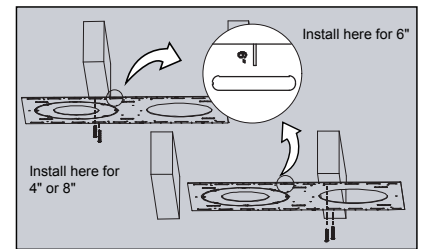

fig. 5

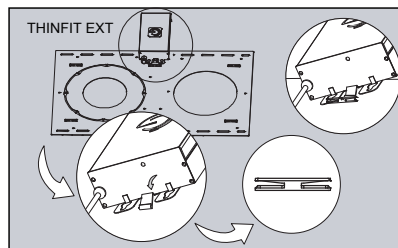

fig. 6

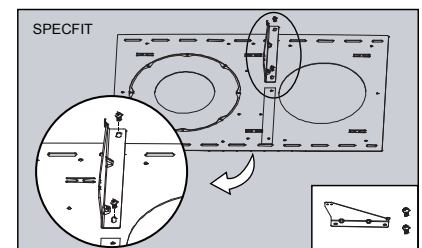

fig. 7

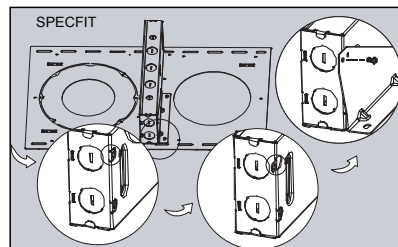

fig. 8

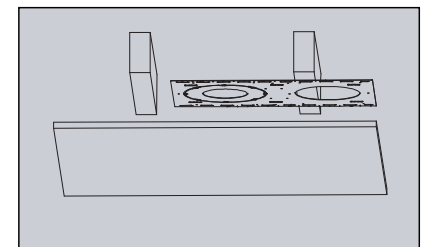
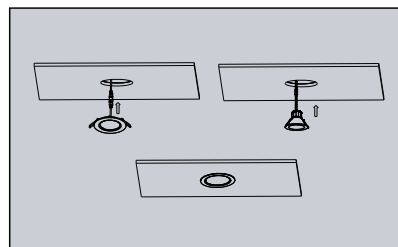
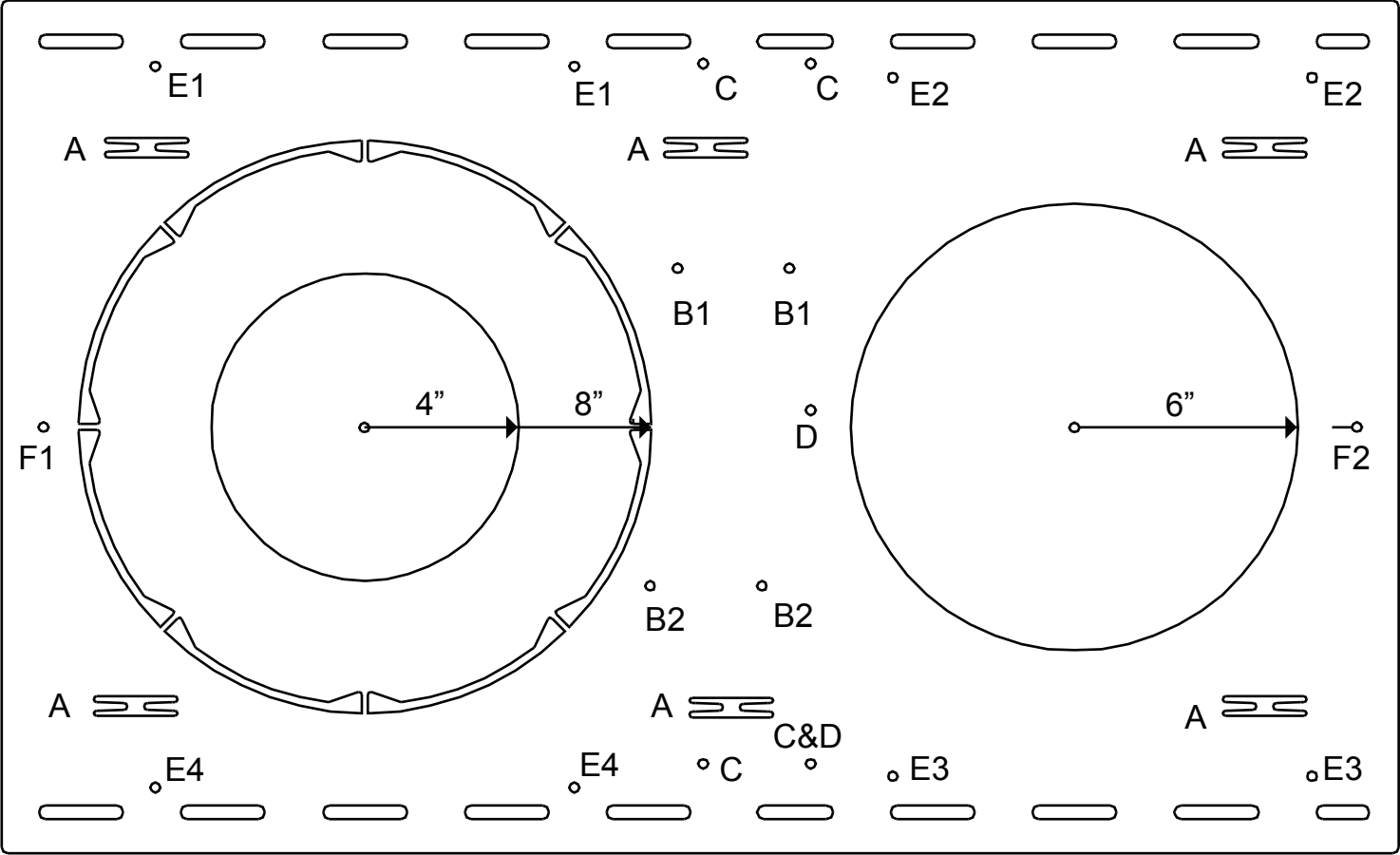

fig. 9



NEW CONSTRUCTION PLATE DRYWALL INSTALLATION



- A** = Finger tabs for THINFIT EXT installation using clip hook installation
- B** = Screw holes for THINFIT EXT using key slot holes installation
- C** = Screw holes for Emergency Battery Pack installation
- D** = Screw holes for SPECFIT driver Bracket installation
- E** = Screw holes for NCPLATEJTB installation
- F** = Extra holes

A = THINFIT EXT with finger tabs

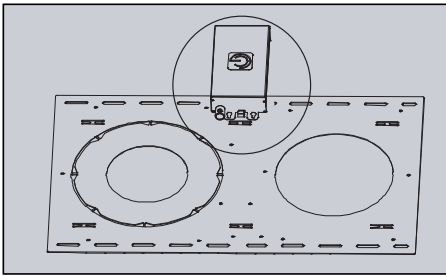

B = THINFIT EXT with key holes

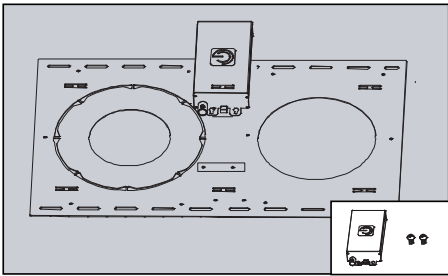

C = Emergency Battery Pack

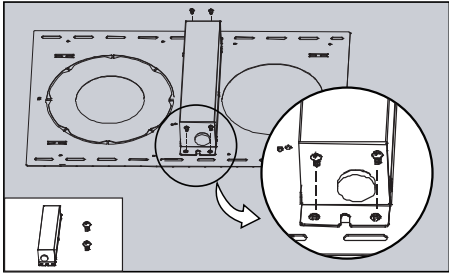

D = SPECFIT driver bracket

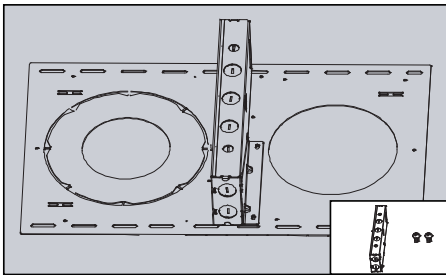

E = NCPLATEJTB

