

## Euro Wall Spot

PROJECT:

TYPE:

SOURCE:

NOTES:

### PURELED SPECIFICATIONS

<b>LED Chip</b>	Cree XPG-50-2 Plug and Play field replaceable LED board
<b>Luminaire Output</b>	420 Lumens @ 700mA (4 watts), 240 Lumens @ 350mA (2 watts), delivered from luminaire with unobstructed beam.
<b>Lumens Per Watt</b>	105 Lumens minimum @ 4 watts, delivered from luminaire with unobstructed beam
<b>CRI (3000K)</b>	85+ Standard, 90+ Optional
<b>Colour Temperatures</b>	2700K, 3000K, 4000K
<b>Beam Angles</b>	15, 25, 38, 60
<b>Ingress Protection</b>	IP66
<b>Warranty</b>	Electronics = 5 years Body Cop/ SS = 10 years
<b>Standards</b>	AS/NZS 61046, EN60598 cUL 1838, 2108, 1598 CSA C22.2 No. 250.7, No. 250.0-08, No. 250.0 CE

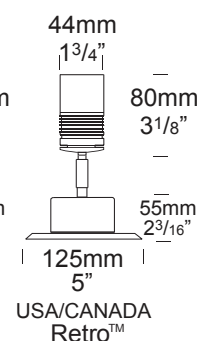
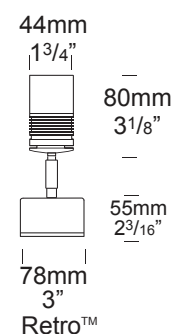
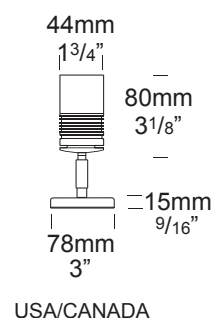
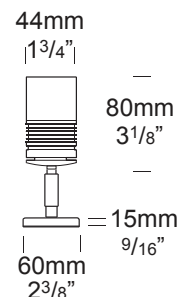

### PRODUCT CONFIGURATION

Please fill in appropriate codes into boxes provided

Cat. No. EWS/L

Luminaire	Power	Material/ Finish	Beam	Colour	Accessories
EWS/L					
S	SERIES, REMOTE DRIVER	COP	15	2	HCL
D3	12VAC, 2W INTEGRAL	SS	25	3	LF
D7	12VAC, 4W INTEGRAL		38	4	WBAP
R	RETRO, 110/240V DRIVER		60	39	CJK

**SERIES, REMOTE DRIVER REQUIRED:**  
Constant current driver  
Individual fixtures require 6vdc @ 700mA maximum

**12VAC INTEGRAL DRIVER:**  
Hunza integrated Plug and Play Driver (included)  
Input: 12VAC, 5watt total.  
Output: 6vdc @ D3=350mA, D7=700mA

**110/240VAC RETRO DRIVER:**  
Input: 120/240vac, 5 watt total (driver included)  
Output: 6vdc, 700mA  
0-10 volt dimming  
(USA - non dimming)

#### OTHER LAMP OPTIONS:

EWS/H - MR11 Halogen 12V Lamp  
EWS/M11L - MR11 LED Retrofit 12V Lamp (lamps vary by market - please refer to supplier for details)

Please click for Remote Power Supply Guidance Charts:

[USA \(page 2\)](#)

[Rest of the World \(page 2\)](#)

[Click here for halogen specification sheet](#)

# LUMINAIRE CONSTRUCTION

## CNC machined from one of the following metals:

### Copper:

Body: 45.4mm x 80mm (1<sup>3/4</sup>" x 3<sup>1/8</sup>") copper rod.

Flange: 70mm (3<sup>1/2</sup>") solid copper rod.

Base and Mounting Plate (Retro™): handspun 2mm (5/64") copper disk and forged brass.

### 316 Stainless Steel

Body: 45.4mm x 80mm (1<sup>3/4</sup>" x 3<sup>1/8</sup>") stainless steel rod.

Flange: 70mm (3<sup>1/2</sup>") 316 stainless steel rod.

Base and Mounting Plate: investing cast and CNC machined 316 stainless steel.

### Lens:

6mm (1/4") extra clear low iron flush fit shatter resistant glass. Add Hex Cell Louvre accessory for glare control.

### Gaskets:

Silicone, iron impregnated 220°C (428°F)

### Knuckles:

Copper luminaires: 360° rotation and 0-90° elevation, solid brass with anti rust spring.

Stainless Steel luminaires: 360° rotation and 0-90° elevation, full stainless steel construction.

### Mounting:

12 volt: The luminaire is mounted to the wall using two 316 stainless screws through a shallow base 15mm (5/8") in depth. A Wall Box Adaptor Plate is available as an accessory to fit 3.0 and 4.0 Junction boxes for USA/Canada.

Retro™ (110/240-12volt): A mounting plate is fixed to the wall using two screws and the luminaire is fitted to the mounting plate.

### Luminaire Weight:

Low Voltage

Cop: 0.700kg (1lb 9oz)

SS: 0.415kg (15oz)

Retro™

Cop: 1.120kg (2lb 8oz)

SS: 1.150kg (2lb 9oz)

## ACCESSORIES

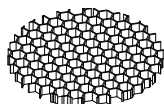

Hex Cell Louvre

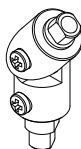

Locking Knuckle

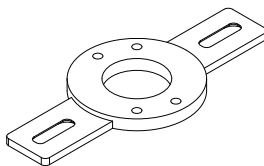

Wall Box Adaptor

## BEAM ANGLES

High efficiency PMMA TIR lenses. Field replaceable

IES files available for download: <http://www.hunzalighting.com/download.php>

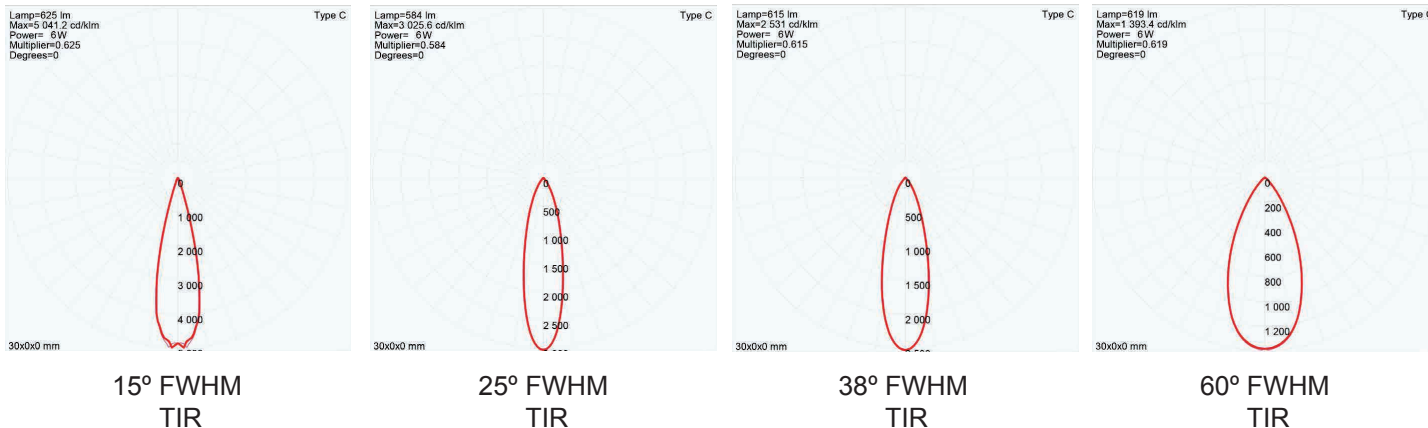

## WIRING GUIDE

### Series/remote driver

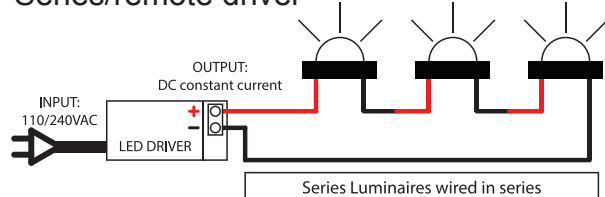

Diagrams are a guide only, wire colours and polarity may change depending on fixture and country

available for download: <http://www.hunzalighting.com/download.php>

### 12v integral driver

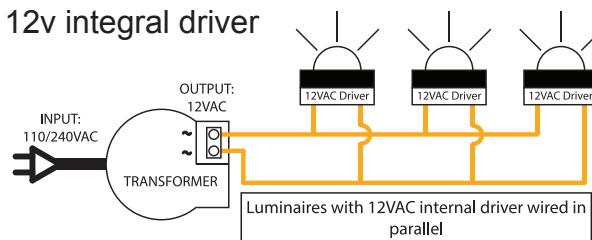

Specifications may change without notification

Aug 2017

**HUNZA**™ PURE OUTDOOR LIGHTING

HUNZA FACTORY

130 Felton Mathew Ave  
Saint Johns  
Auckland 1072  
New Zealand

Ph: +64-9-528 9471  
Fax: +64-9-528 9361  
hunza@hunza.co.nz  
www.hunzalighting.com

INTERNATIONAL CONTACTS:

<http://www.hunzalighting.com/contact.php>

This document contains proprietary information of Hunza. Its receipt or possession does not convey any rights to reproduce or disclose its content.