

Assembly Instructions (US/Canada)

1

a. LED head
b. Body
c. Desk base
d. Transformer
e. Occupancy sensor*

*Sold separately

2

3

Push down to click into place

4

Plug in transformer to the wall

To lamp

Plug in transformer to the lamp

5

(Occupancy Sensor sold separately)

Insert occupancy sensor into the lamp

Occupancy sensor :

- turns lamp off if no motion is detected for 15 minutes
- resumes last brightness setting when motion is detected

Use the touch-strip to control brightness and power

Dimmer Brighter

6

Secure lamp body to base with the hex key provided

Limited Product Warranty

Koncept warrants to the original purchaser of this product against manufacturer defects in design, assembly, material, or workmanship, and will, at Koncept's option, replace or repair any defective product free of charge. This coverage is valid for five years from the date of purchase as long as the original purchaser owns the product. In the case of a hardwired product, this warranty is valid for one year for the LED driver specifically. Koncept will replace or repair the product, which Koncept, at its sole discretion, agrees is defective, free of charge provided that the following conditions for a return are fulfilled.

This warranty does not apply to any product damaged by accident, physical or electrical misuse or abuse, improper installation, alteration, any use contrary to its intended function, war, fire, flood, or any other acts of nature, or unauthorized repair. This warranty does not apply to a product purchased from an authorized 3rd party dealer.

Koncept assumes no liability for any events such as fines arising out of the use of this product or any consequential damages caused by any failure of the product to function properly. In no event shall Koncept be liable for more than the replacement of the product. This warranty does not cover shipping or labor costs associated with the replacement of a defective product. Under no circumstances should this warranty or the product covered by it be construed as an insurance policy against loss of any kind. Koncept staff neither assumes nor authorizes any person or organization to make any warranties or assume any liability in connection with the sale or use of this product.

This warranty covers only products used in the territory covered by your local distributor. This is the complete product warranty and no other warranty exists. Some jurisdictions may not allow limitations on how long an implied warranty lasts, or the exclusion or limitation of incidental or consequential damages, so the above exclusions or limitations may not apply to you. This warranty gives you specific legal rights, and you may also have other rights which vary in different states and countries.

To file a replacement/repair claim under the warranty:

- 1) Contact Koncept for a return authorization number during the warranty period. A claim will not be accepted without a return authorization number.
- 2) Provide a copy of the original purchase receipt with purchase date and product name clearly shown.
- 3) Return the defective product to Koncept freight prepaid and accompanied by (1), (2), and (3) to the following address: Limited Product Warranty
Koncept Inc.
429 E. Huntington Drive,
Monrovia, CA 91016

ATTENTION



To reduce the risk of fire, electric shock or injury:

- Do not use outdoors or near water.
- Do not handle the plugs or the lamp with wet hands.
- Do not look directly at the LEDs.



DO NOT USE AN EXTERNAL DIMMER WITH THIS LAMP.



Overheating can result in reduced LED life. To avoid overheating:

- Do not expose to direct sunlight.
- Recommended ambient temperature: below 25 ° C / 77 ° F.
- Remove the plastic packaging before using.

Specifications

Model	AR3000-CD	AR3000-WD
Color Temperature	Cool Diffused	Warm Diffused
Temperature	~4,500 K	~3,500 K
Dimming	Continuous	
Cord Length	9 ft	

Koncept
429 E. Huntington Drive
Monrovia, CA 91016
Phone: 323-261-8999
Fax: 323-261-8998

support@koncept.com

www.koncept.com

Register your Koncept LED lamp online and benefit from:

- One-year warranty extension (your lamp will be warranted for six full years)
- Priority product maintenance.

Visit www.koncept.com/productsupport and enter the serial number of your product from the back of the lamp's packaging.



WARNING: BEFORE ASSEMBLY OF THIS KIT READ THROUGH THE COMPLETE ASSEMBLY INSTRUCTIONS STEP BY STEP AND NOTE ALL CAUTIONS

1 Shock Hazard. Electric shock could result in serious injury or death. Make sure circuit breaker is set to OFF before installation. Must be installed by a qualified electrician.

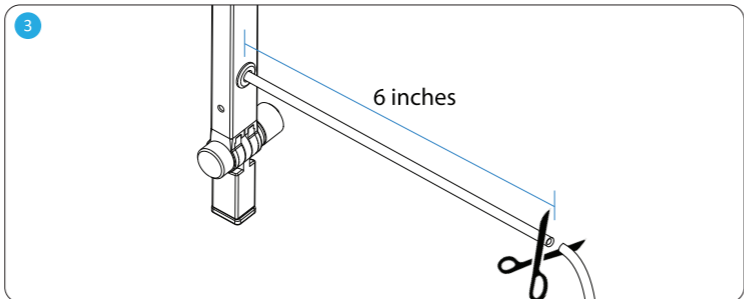
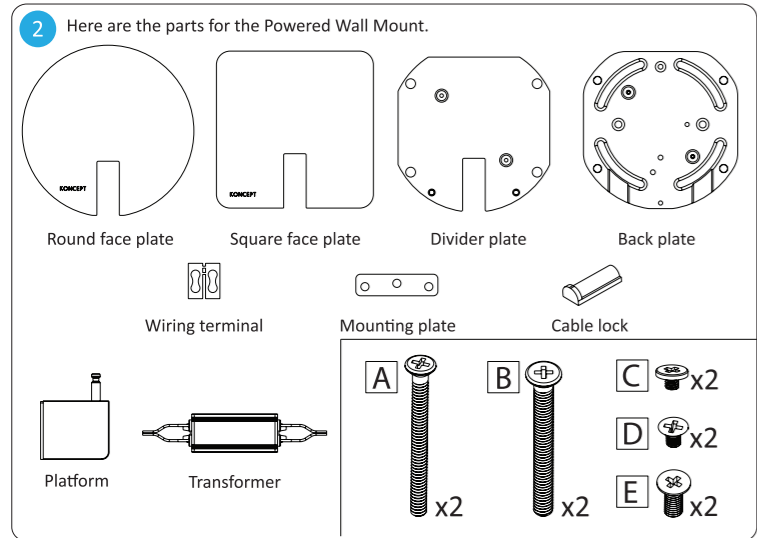

Make sure the lamp is a compatible model to the Powered Wall Mount. (Here are some of the compatible models : AR3000, AR3100, AR1000, AR1100, AR2001, SPY) Cut off the cord at the back of the lamp, make sure to leave at least 6 inches of cord.

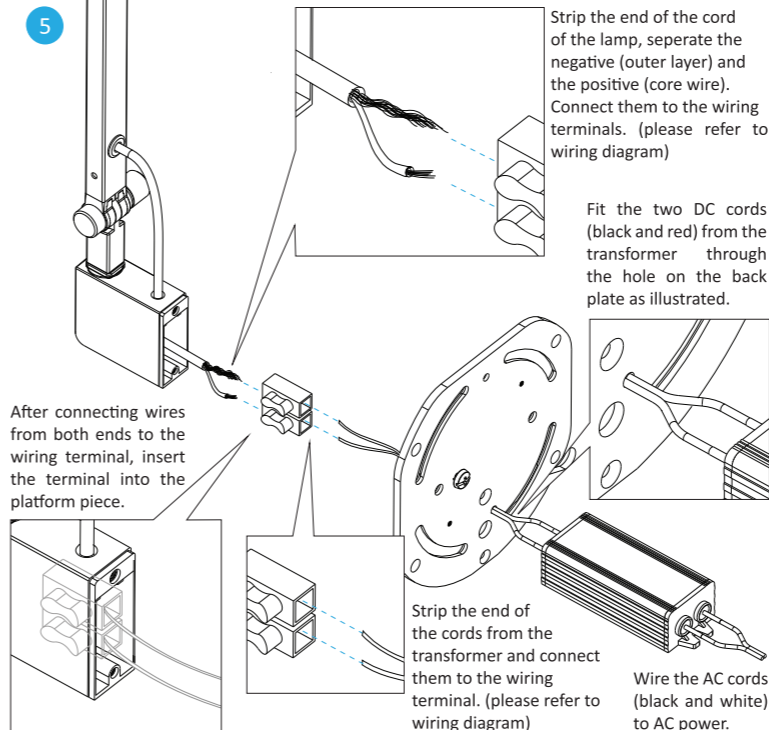
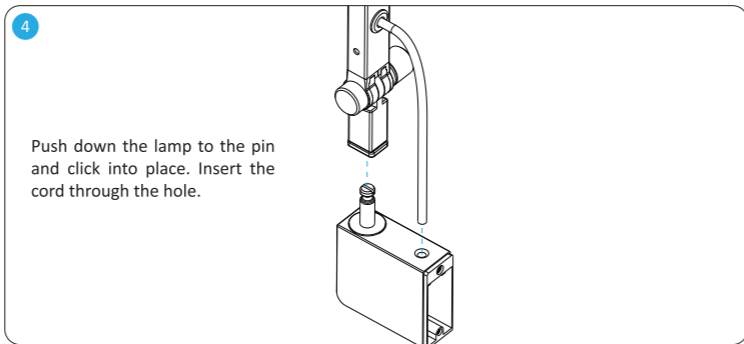

WIRING DIAGRAM

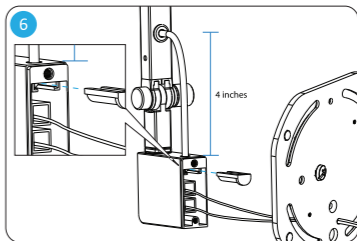
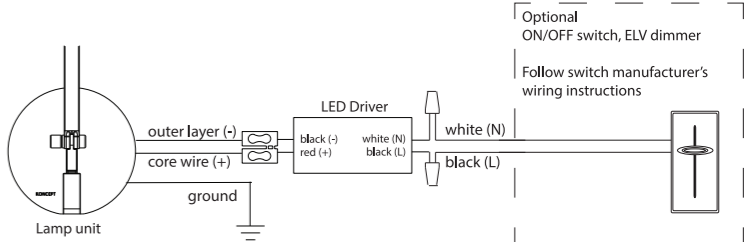

Insert the cable lock into the platform as illustrated. Make sure to leave at least 4 inches of cord out.

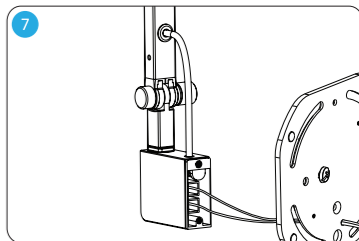

This is how it should look after the cable lock is fully inserted.

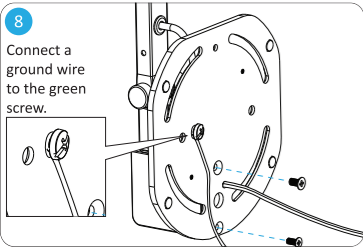

8
Connect a ground wire to the green screw.

Connect a ground wire to the green screw. Then use the two screws labeled "E", fasten the back plate onto the platform.

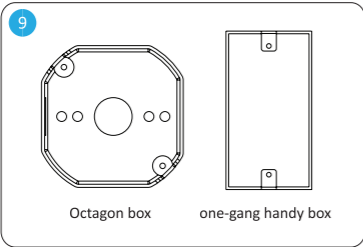

9
Octagon box one-gang handy box

For one-gang handy box, please continue to step 10. Skip to step 12 if you are installing on a Octagon box.

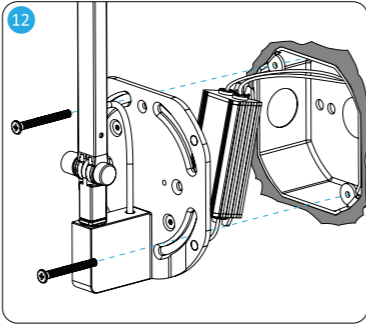

12

Secure back plate to the junction box with screws labeled "B". A junction box with enough depth to fit the LED driver should be used. LED driver should be completely seated inside the junction box.

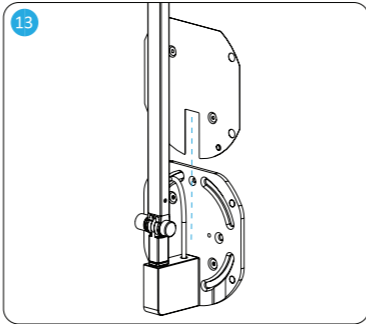

13

Slide the divider plate in front of the back plate.

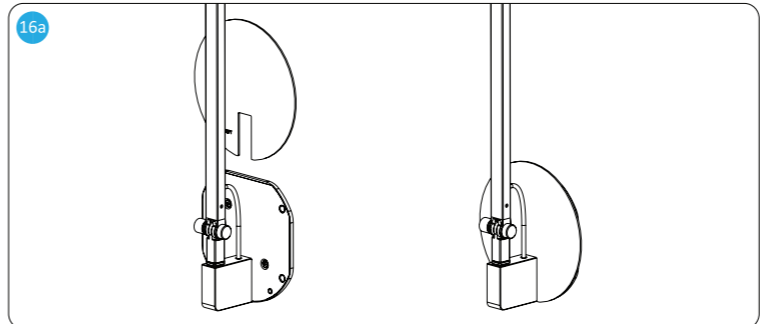

16a

Slide the round cover plate into place.

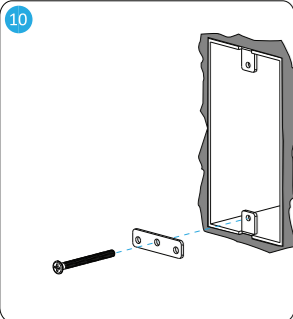

10

Using the screw labeled "A", secure the mounting plate onto the bottom screw hole on the one-gang handy box.

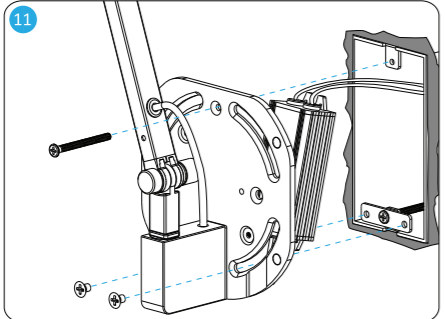

11

Using the screw labeled "A", secure back plate to the top screw hole on the handy box. Using the 2 screws labeled "D", secure the back plate to the mounting plate. Skip to step 13.

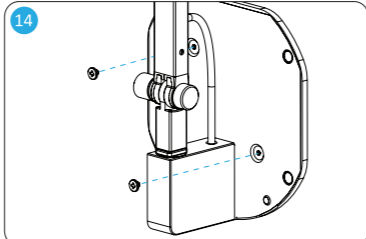

14

Secure the divider plate to the back plate using screws labeled "C".

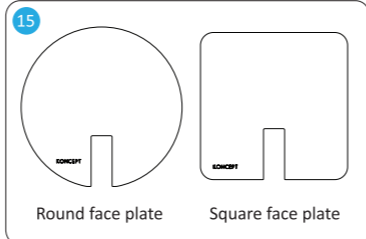

15
Round face plate Square face plate

A round or square face plate can be chosen. For round cover go to step 16a, for square cover go to step 16b.

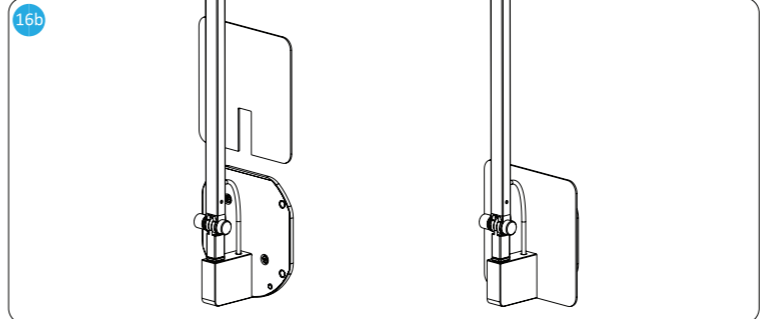

16b

Slide the square cover plate into place.

One Year Limited Product Warranty

Koncept warrants to the original purchaser of this product against manufacturer defects in design, assembly, material, or workmanship, and will, at Koncept's option, replace or repair any defective product free of charge. This coverage is valid for one year from the date of purchase as long as the original purchaser owns the product. Koncept will replace or repair the product, which Koncept, at its sole discretion, agrees is defective, free of charge provided that the following conditions for a return are fulfilled. This warranty does not apply to any product damaged by accident, physical or electrical misuse or abuse, improper installation, alteration, any use contrary to its intended function, war, fire, flood, or any other acts of nature, or unauthorized repair.

Koncept assumes no liability for any events such as fires arising out of the use of this product or any consequential damages caused by any failure of the product to function properly. Under no circumstances should this warranty or the product covered by it be construed as an insurance policy against loss of any kind. Koncept staff neither assumes nor authorizes any person or organization to make any warranties or assume any liability in connection with the sale or use of this product. This warranty covers only products used in the 50 US states and/or Canada. This is the complete MT-01-W002 warranty and no other warranty exists. Some jurisdictions may not allow limitations on how long an implied warranty lasts, or the exclusion or limitation of incidental or consequential damages, so the above exclusions or limitations may not apply to you. This warranty gives you specific legal rights, and you may also have other rights which vary in different states and countries.

To file a replacement/repair claim under the warranty:

- 1) Contact Koncept for a return authorization number during the warranty period. A claim will not be accepted without a return authorization number.
- 2) Make a copy of the original purchase receipt with purchase date and product name clearly shown.
- 3) Provide original purchaser's full name, email address (optional), daytime phone, and postal address.
- 4) Return the defective product to Koncept freight prepaid and accompanied by (1), (2), and (3) to the following address:

Limited Product Warranty
Koncept Inc.
429 E. Huntington Drive
Monrovia, CA 91016

Warnings

-  **Warning: To reduce the risk of fire, electric shock or injury:**
- Do not use in wet locations
 - Do not handle plug or appliance with wet hands

Specifications

Model	MT-01-W002
Compatible lamps	AR3000, AR3100, AR3200, AR1000, AR1100, AR2001, SPY
Input voltage	120 V only

Koncept Inc.
429 E. Huntington Drive
Monrovia, CA 91016, USA
Phone: 323-261-8999
Fax: 323-261-8998

Customer Support:
support@koncept.com

Web Address:
www.koncept.com

KONCEPT

Wall Mount / Wandhalterung / Support mural / Supporto murale

Montering af produktet / How to assemble / Montage / Montage / Montaggio

Indhold / What's in the bag / Inhalt / Contenu du sachet / Contenuto del sacchetto



- Monteringsplade x 1
- Mounting plate x 1
- Montageplatte x 1
- Plaque de fixation x 1
- Piastra di montaggio x 1

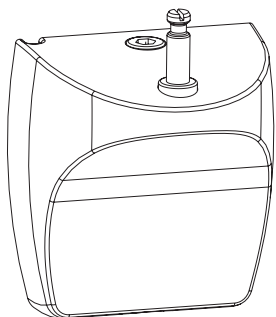

- Vægbeslag x 1
- Wall mount x 1
- Wandhalterung x 1
- Support mural x 1
- Supporto murale x 1

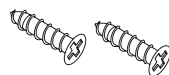

- Skruer x 2
- Screw x 2
- Schrauben x 2
- Visses x 2
- Vite x 2

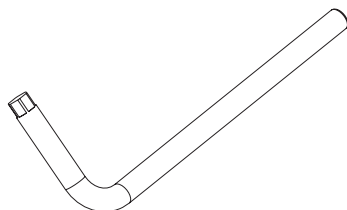

- Hex nøgle x 1
- Hexkey x 1
- Inbus-Schlüssel x 1
- Clé de serrage x 1
- Chiave a brugola x 1

1

- Sæt monteringspladen på væggen med de 2 skruehuller i vandret position.
- Screw the mounting plate to the wall with the 2 screw holes arranged horizontally. For best results, secure the mounting plate to a stud.
- Befestigen Sie die Montageplatte mit den 2 Schrauben an die Wand. Beachten Sie dabei die Ausrichtung der Platte gemäß der Skizze.
- Vissez la plaque de fixation au mur, les 2 visses doivent être positionnées selon un axe horizontal.
- Avvitare la piastra di montaggio a parete. Le due viti devono essere posizionate in un asse orizzontale.

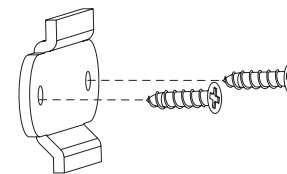

2

- Før lampens ledning gennem ledningskanalen på bagsiden af vægbeslaget.
- Route the lamp's power cord through the cord channel at the back edge of the wall mount.
- Legen Sie das Speisungskabel vor der Montage in den dafür vorgesehenen Kabel-Kanal.
- Faites passer le cordon d'alimentation de la lampe le long du sillon prévu à cet effet, situé sur la face arrière du support mural.
- Far passare il cavo d'alimentazione della lampada lungo il canale per il cavo. Il canale si trova sulla faccia posteriore del supporto murale.

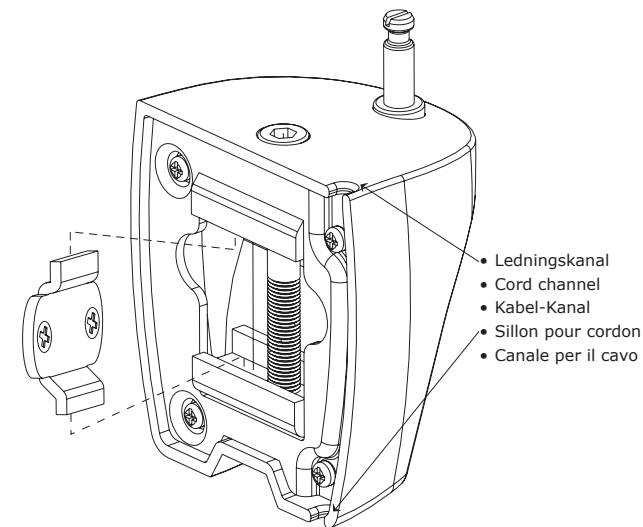

- Ledningskanal
- Cord channel
- Kabel-Kanal
- Sillon pour cordon
- Canale per il cavo

3

- Hæng vægbeslaget op på monteringspladen.
- Hook the wall mount onto the mounting plate.
- Hängen Sie die Wandhalterung auf die Montageplatte.
- Enclenchez le support mural sur la plaque de fixation.
- Ora appendere il supporto da parete alla piastra di montaggio.

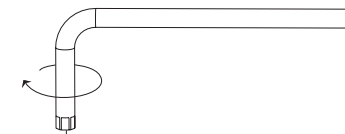

4

- For at fastgøre vægbeslaget bruges hex nøglen til at skru bolten med uret, indtil den sidder helt fast.
- To secure the mount, use the hexkey to turn the bolt located at the top of the mount clockwise until tight.
- Um die Halterung zu fixieren, schrauben Sie mit dem Inbus-Schlüssel die Fixierschraube im Uhrzeigersinn bis die Halterung fest auf der Montageplatte sitzt.
- Afin de sécuriser le support, vissez l'écrou supérieur dans le sens des aiguilles d'une montre à l'aide de la clé de serrage fournie.
- Per fissare il supporto murale, avvitare la vite di fissaggio in senso orario con la chiave fornita.

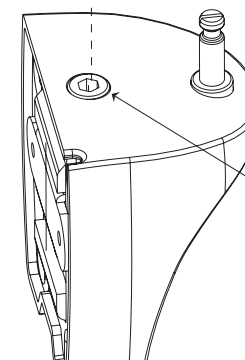

- Bolt
- Bolt
- Fixierschraube
- Écrou
- Vite di fissaggio

Installation Instruction Manual

Grommet Mount

What's in the bag:

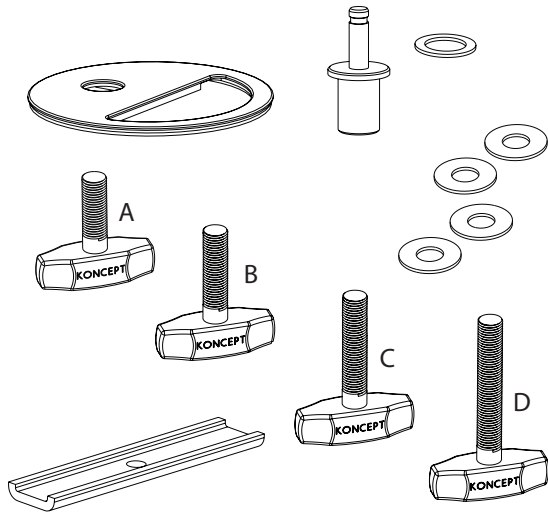

Instructions:

To place the mount over your grommet, measure the thickness of your table, then find your table thickness on the right and follow the instruction illustrations accordingly.

Choose your table thickness:

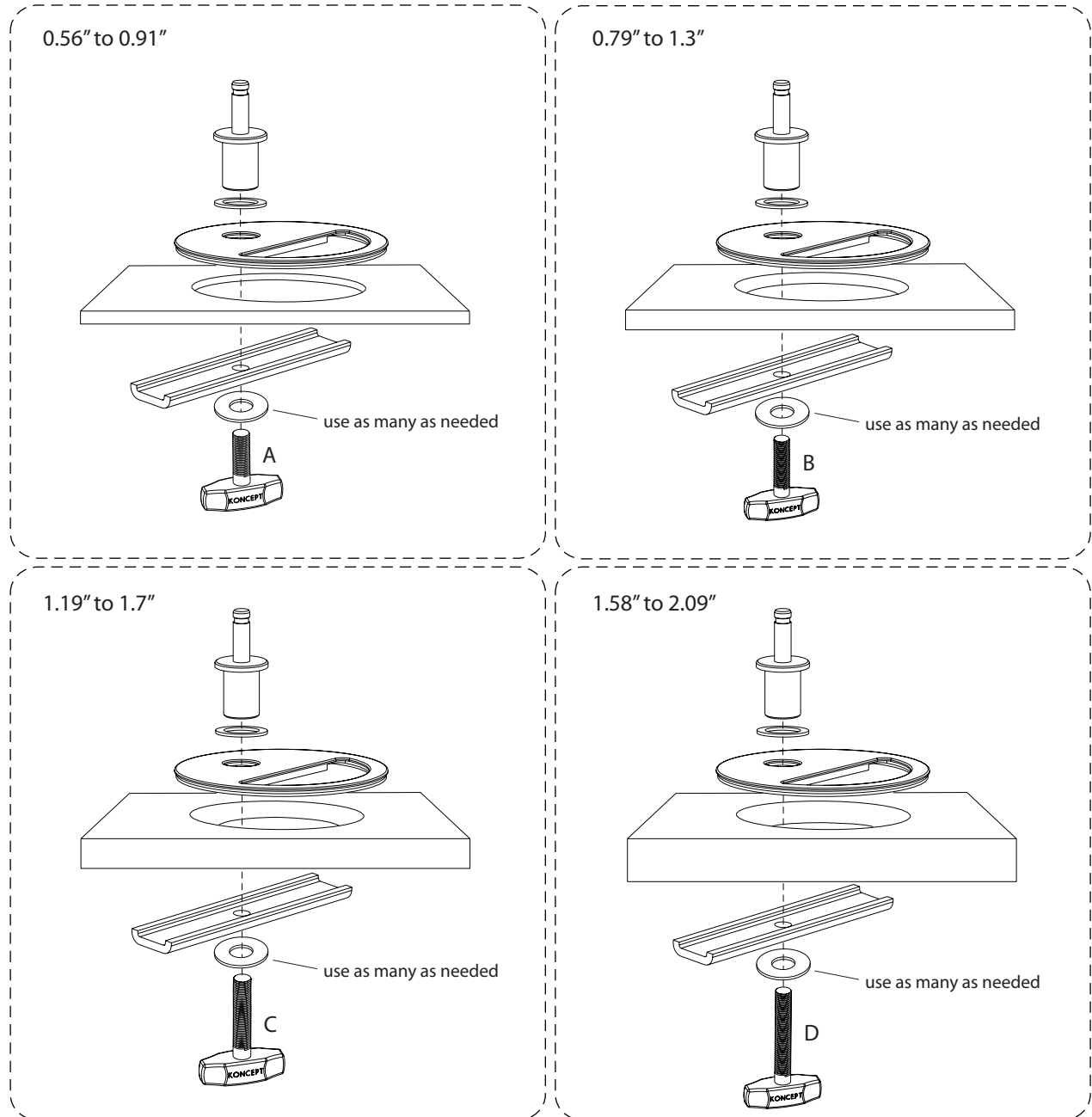

KONCEPT

t: 323.261.8999 | f: 323.261.8998 | www.koncept.com

© 2014 Koncept Inc. All rights reserved.