

Installation Instructions

URGENT: READ PRIOR TO ATTEMPTING INSTALLATION

RECESSED LIGHTING - 4" LED COB SERIES

Item#	Description
NLCBC-451	4" LED, Self Flanged Reflector (Wet)
NLCBC-452	4" LED, Self Flanged Baffle (Wet)
NLCBC-453	4" LED, Squared Round (Wet)
NLCBC-455	4" LED, Squared Pinhole(Wet)
NLCBC-456	4" LED, Squared Regressed (Wet)

INSTALLATION SHOULD BE CARRIED OUT BY YOUR LOCAL ELECTRICIAN.

ALWAYS TURN OFF MAIN POWER BEFORE INSTALLATION

PLEASE READ: Important Information Before installation

- **IMPORTANT**- Risk of fire or electric shock. Installation of this retrofit assembly requires a person familiar with the construction and operation of the luminaires electrical system and the hazard involved. If not qualified, do not attempt installation. Contact a qualified electrician
- **IMPORTANT**- Risk of fire or electric shock. Install this kit only in the luminaires that has the construction features and dimensions shown in the photographs and/or drawings
- **IMPORTANT**- To prevent wiring damage or abrasion, do not pinch or damage expose wiring during installation. Keep away from to edges of sheet metal or other sharp objects
- **IMPORTANT**- Risk of fire or electric shock. Do not alter, relocate, or remove wiring, lampholders, power supply, or any other electrical component.
- This luminaire is intended for installation in accordance with the National Electrical Code and local regulations.
- LED Retrofit Diamond Series is designed to install in typical 4" recessed IC or Non-IC downlight housings with 120V AC line using standard medium base sockets.
- Do not attempt to install or use NLCBC-4 until you read and understand the installation instructions and safety labels.
- Verify power is off before installing or un-installing.
- Do not use NLCBC-4 if the lens, housing, socket, or power cables of the recessed housing it would be inserted into are damaged.
- The modules have line voltage risk of shock and no user serviceable parts. Do not attempt to open them.
- Do not exceed the specified voltage and current input (refer to the specification sheet).
- Do not hot swap NLCBC-4 modules.
- Avoid looking directly into light beam as the high brightness beam may damage eyes.
- Nora Lighting's limited warranty applies only to Nora Lighting's NLCBC-4 module.
- This product must be installed in accordance with the applicable installation code by a person familiar with the construction and operation of the product and the hazards involved.
- Do not make or alter any open holes in an enclosure of wiring or electrical components during kit installation.
- Please retain these instructions for maintenance reference.

Installation Instructions:

1. Make sure power is off. **NOTE:** The orange connector between the screw-in socket and LED unit is not intended to support the weight of unit. Please support unit at all times.
2. If the housing that you intend to put the retrofit into has a mounting clip holding the socket, please ensure you remove the mounting clip from the socket to provide extra room for the retrofit. (Fig. A)
3. Remove NLCBC-4 from its packaging. Determine installation Application.

Retrofitting an Existing Housing & Trim: Remove existing trim and SB CFL/Incandescent bulb from the recessed housing to reveal the medium base socket. Remove socket from mounting clip (Limited to mounting clip). Connect the screw-in socket to the revealed socket or for hardwire installation cut-off existing screw-in socket of LED Retro and existing socket of housing and join wires maintaining polarity using the enclosed connector (Fig. 1). The connector can be separated into 2 pieces. Mount the male portion of connector to the wires from the housing and female portion to the wires of the LED module maintaining polarity. **NOTE:** Do not strip the wire more than 1/4". (Fig. 2)

New Construction or Remodel using Nora Dedicated Housing: Connect the Dedicated connector of the LED module to the Dedicated connector of Nora's housing. (Fig. 2)

4. Connect ground wire inside the recessed housing. (Fig. 3)
5. Squeeze friction blades towards unit and install into recessed housing. (Fig. 4)
6. Carefully route wires into fixture and push module up flush to ceiling surface.
7. Turn power back on.

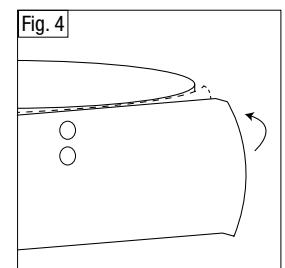
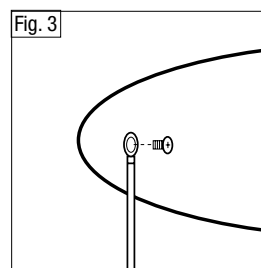
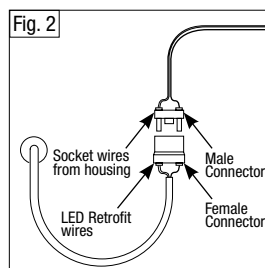
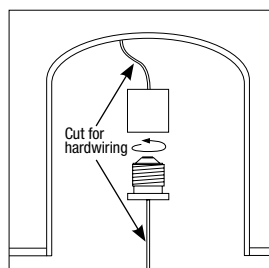
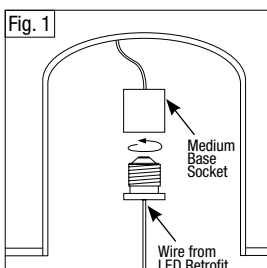
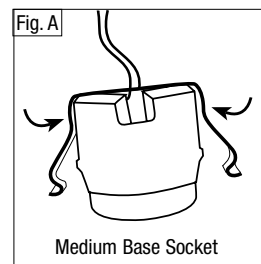

Installation Instructions

URGENT: READ PRIOR TO ATTEMPTING INSTALLATION

RECESSED LIGHTING - 5" LED COB SERIES

Item#	Description
NLCBC-551	5" LED, Self Flanged Reflector (Wet)
NLCBC-552	5" LED, Self Flanged Baffle (Wet)

INSTALLATION SHOULD BE CARRIED OUT BY YOUR LOCAL ELECTRICIAN.

ALWAYS TURN OFF MAIN POWER BEFORE INSTALLATION

PLEASE READ: Important Information Before installation

- **IMPORTANT-** Risk of fire or electric shock. Installation of this retrofit assembly requires a person familiar with the construction and operation of the luminaire electrical system and the hazard involved. If not qualified, do not attempt installation. Contact a qualified electrician
- **IMPORTANT-** Risk of fire or electric shock. Install this kit only in the luminaires that has the construction features and dimensions shown in the photographs and/or drawings
- **IMPORTANT-** To prevent wiring damage or abrasion, do not pinch or damage expose wiring during installation. Keep away from to edges of sheet metal or other sharp objects
- **IMPORTANT-** Risk of fire or electric shock. Do not alter, relocate, or remove wiring, lampholders, power supply, or any other electrical component.
- **IMPORTANT-** Please refer to dimmer list in Spec Sheet
- This luminaire is intended for installation in accordance with the National Electrical Code and local regulations.
- This series is designed to install in typical 5" recessed IC or Non-IC downlight housings with 120V AC line using standard medium base sockets.
- Do not attempt to install or use NLCBC-5 until you read and understand the installation instructions and safety labels.
- Verify power is off before installing or un-installing.
- Do not use NLCBC-5 if the lens, housing, socket, or power cables of the recessed housing it would be inserted into are damaged.
- The modules have line voltage risk of shock and no user serviceable parts. Do not attempt to open them.
- Do not exceed the specified voltage and current input (refer to the specification sheet).
- Do not hot swap NLCBC-5 modules.
- Avoid looking directly into light beam as the high brightness beam may damage eyes.
- Nora Lighting's limited warranty applies only to Nora Lighting's NLCBC-5 module.
- This product must be installed in accordance with the applicable installation code by a person familiar with the construction and operation of the product and the hazards involved.
- Do not make or alter any open holes in an enclosure of wiring or electrical components during kit installation.
- Please retain these instructions for maintenance reference.

Installation Instructions:

1. Make sure power is off. **NOTE:** The orange connector between the screw-in socket and LED unit is not intended to support the weight of unit. Please support unit at all times.
2. If the housing that you intend to put the retrofit into has a socket plate holding the socket, please ensure you remove the plate from the socket to provide extra room for the retrofit.
3. Remove NLCBC-5 from its packaging. Determine installation Application.

Retrofitting an Existing Housing & Trim: Remove existing trim and SB CFL/Incandescent bulb from the recessed housing to reveal the medium base socket. Remove socket from plate (Limited to Plate). Connect the screw-in socket to the revealed socket or for hardwire installation cut-off existing screw-in socket of LED Retro and existing socket of housing and join wires maintaining polarity using the enclosed connector (Fig. 1). The connector can be separated into 2 pieces. Mount the male portion of connector to the wires from the housing and female portion to the wires of the LED module maintaining polarity. **NOTE:** Do not strip the wire more than 1/4". (Fig. 2)

New Construction or Remodel using Nora Dedicated Housing: Connect the Dedicated connector of the LED module to the Dedicated connector of Nora's housing. (Fig. 2)

4. Connect ground wire inside the recessed housing. (Fig. 3)
5. Squeeze friction blades towards unit and install into recessed housing. (Fig. 4)
6. Carefully route wires into fixture and push module up flush to ceiling surface.
7. Turn power back on.

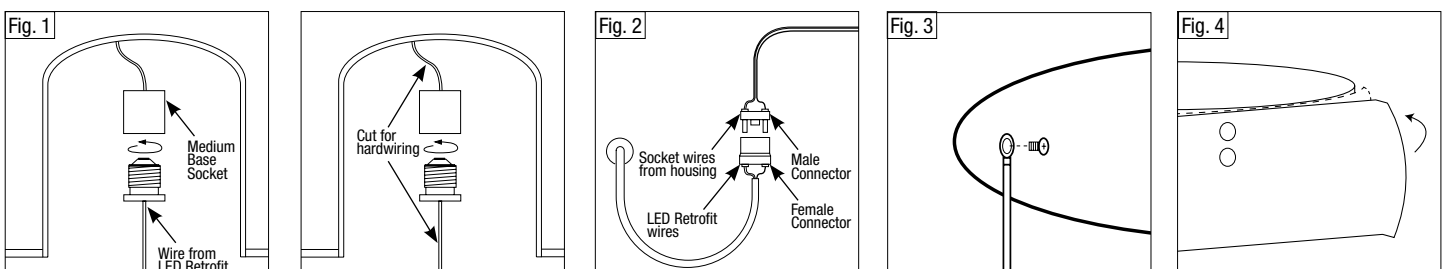

Installation Instructions

URGENT: READ PRIOR TO ATTEMPTING INSTALLATION

RECESSED LIGHTING – 6" LED COB SERIES

Item#	Description
NLCBC-651	6" LED, Self Flanged Reflector (Wet)
NLCBC-652	6" LED, Self Flanged Baffle (Wet)

INSTALLATION SHOULD BE CARRIED OUT BY YOUR LOCAL ELECTRICIAN.

ALWAYS TURN OFF MAIN POWER BEFORE INSTALLATION

PLEASE READ: Important Information Before installation

- **IMPORTANT-** Risk of fire or electric shock. Installation of this retrofit assembly requires a person familiar with the construction and operation of the luminaire electrical system and the hazard involved. If not qualified, do not attempt installation. Contact a qualified electrician
- **IMPORTANT-** Risk of fire or electric shock. Install this kit only in the luminaires that has the construction features and dimensions shown in the photographs and/or drawings
- **IMPORTANT-** To prevent wiring damage or abrasion, do not pinch or damage expose wiring during installation. Keep away from to edges of sheet metal or other sharp objects
- **IMPORTANT-** Risk of fire or electric shock. Do not alter, relocate, or remove wiring, lampholders, power supply, or any other electrical component.
- **IMPORTANT-** Please refer to dimmer list in Spec Sheet
- This luminaire is intended for installation in accordance with the National Electrical Code and local regulations.
- This series is designed to install in typical 6" recessed IC or Non-IC downlight housings with 120V AC line using standard medium base sockets.
- Do not attempt to install or use NLCBC-6 until you read and understand the installation instructions and safety labels.
- Verify power is off before installing or un-installing.
- Do not use NLCBC-6 if the lens, housing, socket, or power cables of the recessed housing it would be inserted into are damaged.
- The modules have line voltage risk of shock and no user serviceable parts. Do not attempt to open them.
- Do not exceed the specified voltage and current input (refer to the specification sheet).
- Do not hot swap NLCBC-6 modules.
- Avoid looking directly into light beam as the high brightness beam may damage eyes.
- Nora Lighting's limited warranty applies only to Nora Lighting's NLCBC-6 module.
- This product must be installed in accordance with the applicable installation code by a person familiar with the construction and operation of the product and the hazards involved.
- Do not make or alter any open holes in an enclosure of wiring or electrical components during kit installation.
- Please retain these instructions for maintenance reference.

Installation Instructions:

1. Make sure power is off. **NOTE:** The orange connector between the screw-in socket and LED unit is not intended to support the weight of unit. Please support unit at all times.
2. If the housing that you intend to put the retrofit into has a socket plate holding the socket, please ensure you remove the plate from the socket to provide extra room for the retrofit.
3. Remove NLCBC-6 from its packaging. Determine installation Application.

Retrofitting an Existing Housing & Trim: Remove existing trim and SB CFL/Incandescent bulb from the recessed housing to reveal the medium base socket. Remove socket from plate (Limited to Plate). Connect the screw-in socket to the revealed socket or for hardwire installation cut-off existing screw-in socket of LED Retro and existing socket of housing and join wires maintaining polarity using the enclosed connector (Fig. 1). The connector can be separated into 2 pieces. Mount the male portion of connector to the wires from the housing and female portion to the wires of the LED module maintaining polarity. **NOTE:** Do not strip the wire more than 1/4". (Fig. 2)

New Construction or Remodel using Nora Dedicated Housing: Connect the Dedicated connector of the LED module to the Dedicated connector of Nora's housing. (Fig. 2)

4. Connect ground wire inside the recessed housing. (Fig. 3)
5. Squeeze torsion springs together and install into torsion spring brackets inside recessed housing. (Fig. 4)
Note: If housing does not have torsion spring receivers, replace housing with one that is compatible with LED module.
6. Carefully route wires into fixture and push module up flush to ceiling surface.
7. Turn power back on.

