



CAUTION - We recommend this fixture be installed by a licensed Electrician.

Before assembling and installing this product, carefully read the following:

- When installing multiple lamps; these fixtures must be wired in parallel in order to achieve the best possible light quality from each lamp. Wiring in series will result in the progressive loss of performance as the lamps move further away from the building power.
- Switch off power to the junction box before installing the lamp.
- Move light switch into the OFF position.
- When mouting to the ceiling, always use appropriate anchoring hardware.
- This lamp is for indoor use only, excluding bathrooms or any type of humid environment.
- We recommend reading the guide before you begin installation.
- Installation Guides can be downloaded from Pablodesigns.com in the case this document is lost or damaged.
- Do not disassemble, modify or try to repair this fixture! In order to recieve technical assistance contact Pablo Designs. Any modification to the fixture will nulify the manufacturer's warranty.

IMPORTANT INFORMATION ABOUT MATERIALS/FINISHES:

- Glass is a material which is fragile and can be easily damaged when mishandled.
- One of the main characteristics of Opal glass is that it is hand blown. Small imperfections like; air bubbles, thickness variations, or scratches can occur during the production process. These imperfections underline the craftsmanship, the exclusivity and authenticity of hand blown Opal glass.
- The annodizing process can result in slight variations in color intensity, we do our best to batch like parts, but slight variations may still remain among part sets.

CLEANING INSTRUCTIONS:

- Use only a soft cloth to clean this fixutre, dampened with water or mild cleanser if required, DO NOT use alcohol, solvents, or other abraasive cleaners, as this could damage the lamp finish.

TECHNICAL SPECIFICATIONS

Voltage: 120-277V 50/60Hz
 Power Consumption: 45W
 Color Temperature: 2700K or 3000K
 Luminosity: 1700 Lumens
 Luminaire Efficacy: 38 Lumens/Watt
 Color Rendition Index: 90 CRI
 Title 20 compliant
 50K hour lifespan
 Cord length 10' (305cm)

Contents

STELLA SHIPS IN A SINGLE BOX AND ARRIVES FULLY ASSEMBLED.

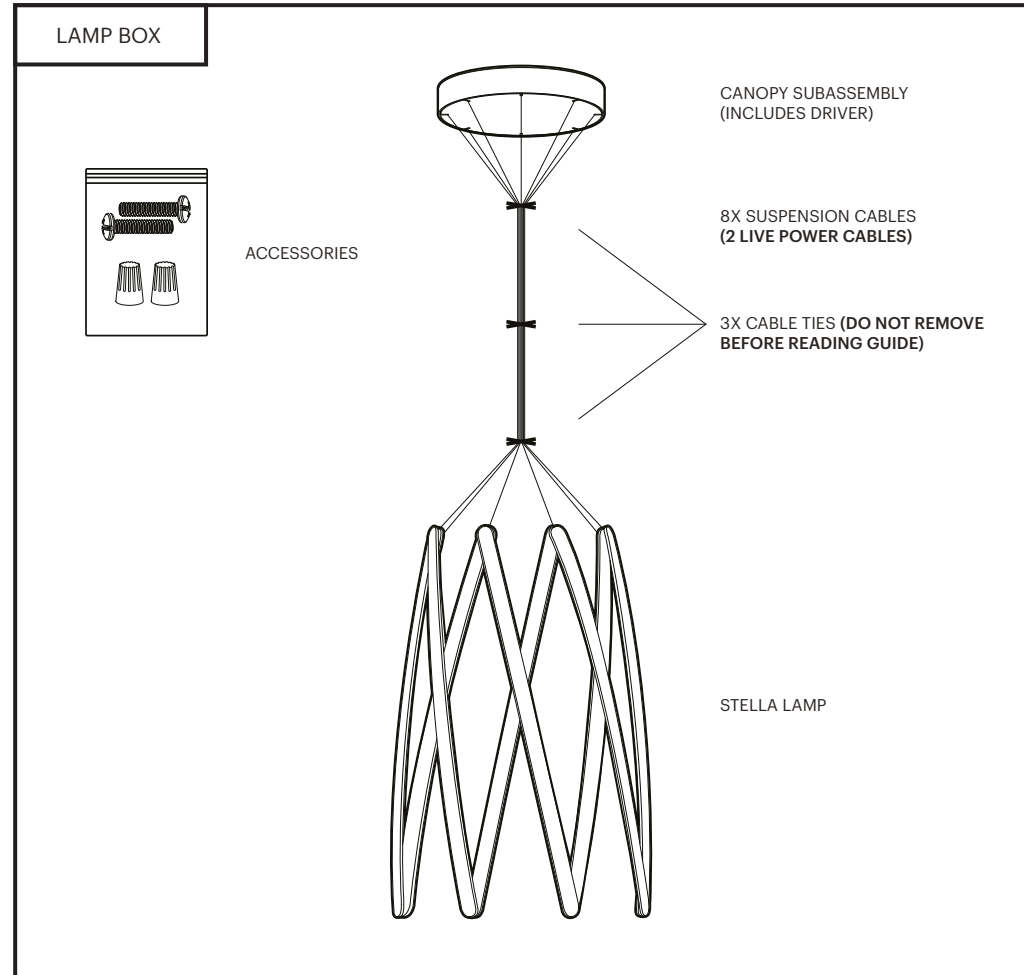

ITS CRITICAL TO AVOID TANGLING THE CABLES PRIOR TO INSTALLATION. PLEASE TAKE EXTRA CARE WHEN REMOVING THE LAMP FROM ITS PACKAGING TO KEEP THE ENTIRE ASSEMBLY IN ALIGNMENT.

IF THERE ARE MISSING OR DAMAGED PARTS, PLEASE CONTACT US AS SOON AS POSSIBLE TO FILE A REPORT. CLEAR PHOTOS AND DESCRIPTIONS WILL ENABLE OUR CUSTOMER SERVICE TEAM TO QUICKLY AND EFFECTIVELY ADDRESS YOUR CLAIM.

(415) 865-5000
 888 MARIN STREET
 SAN FRANCISCO, CA 94124
INFO@PABLODESIGNS.COM
[\[INFO@PABLODESIGNS.EU\]](mailto:INFO@PABLODESIGNS.EU)

- 1** Remove the lamp from the box, lifting from the CANOPY upward. (NOTE: DO NOT REMOVE THE CABLE TIES YET AT THIS STAGE)

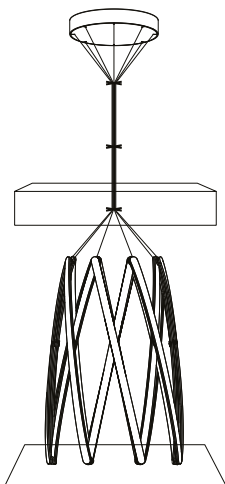

- 2** Remove Upper Most cable tie. Push on one end of the CANOPY COVER PLATE to release magnetic connection.

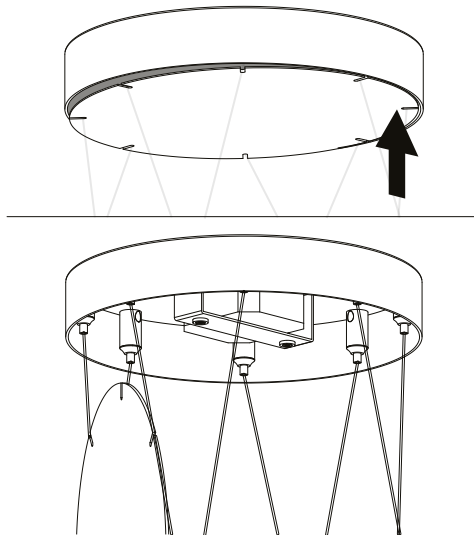

- 3** Thread screws into JUNCTION BOX or appropriate ceiling anchor. Use keyholes to place canopy onto the ceiling, rotate, then fasten mount screws as necessary.

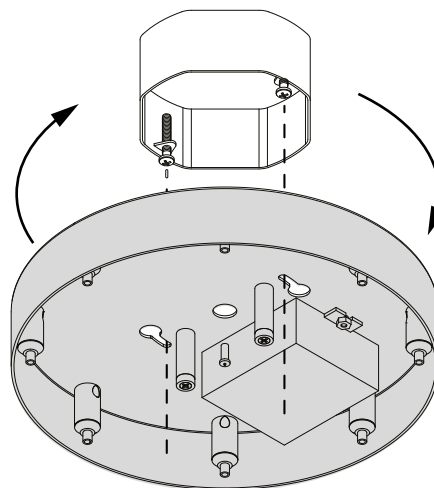

- 4** Connect DRIVER to BUILDING **US**(A-Black to Black/B-White to White) **EU**(A-Black to Brown/B-White to Blue) (NOTE:LAMP ARRIVES PRE-WIRED TO DRIVER)

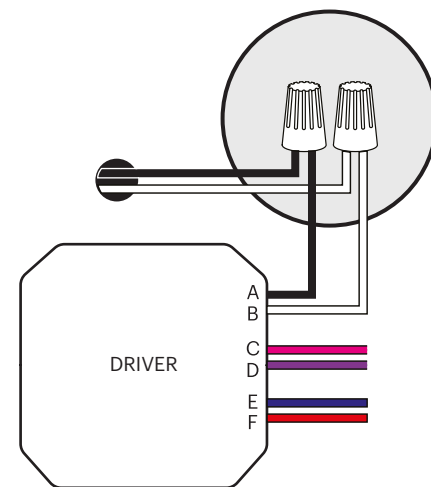

- 5** Remove the remaining cable ties and let the lamp hang freely. Expand lamp to desired position.

NOTE: Lamp height varies depending on position. Height variation range is 18"(46cm) between fully collapsed and fully expanded position when the cables are extended to the same length.

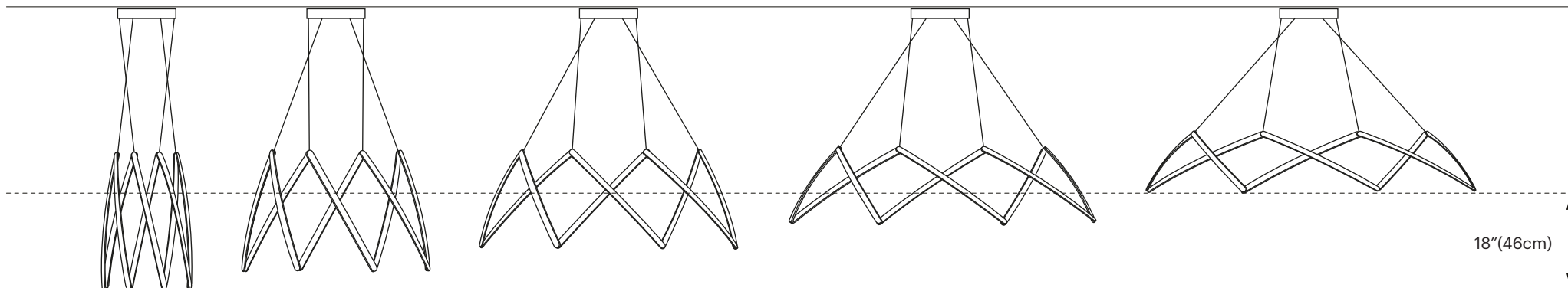

6 TO RAISE THE LAMP:

Push upward on the lower section of the cable gripper to release the locking mechanism then feed the cable up through the cable gripper.

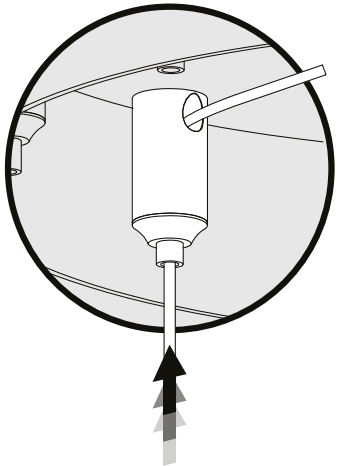
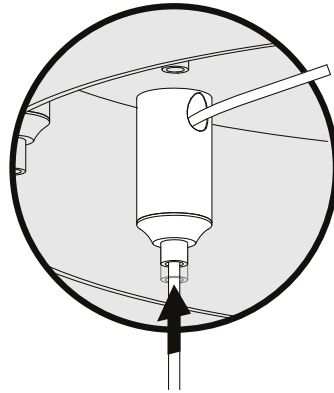
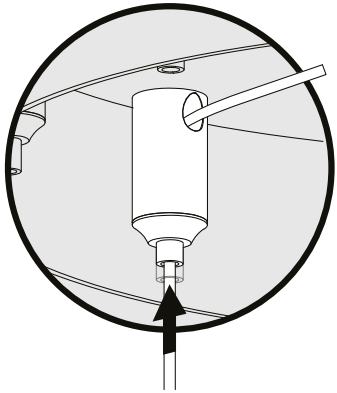

TO LOWER THE LAMP:

Push upward on the lower section of the cable gripper to release the locking mechanism then pull gently on the cable while feeding the other end of the cable down through the cable gripper.

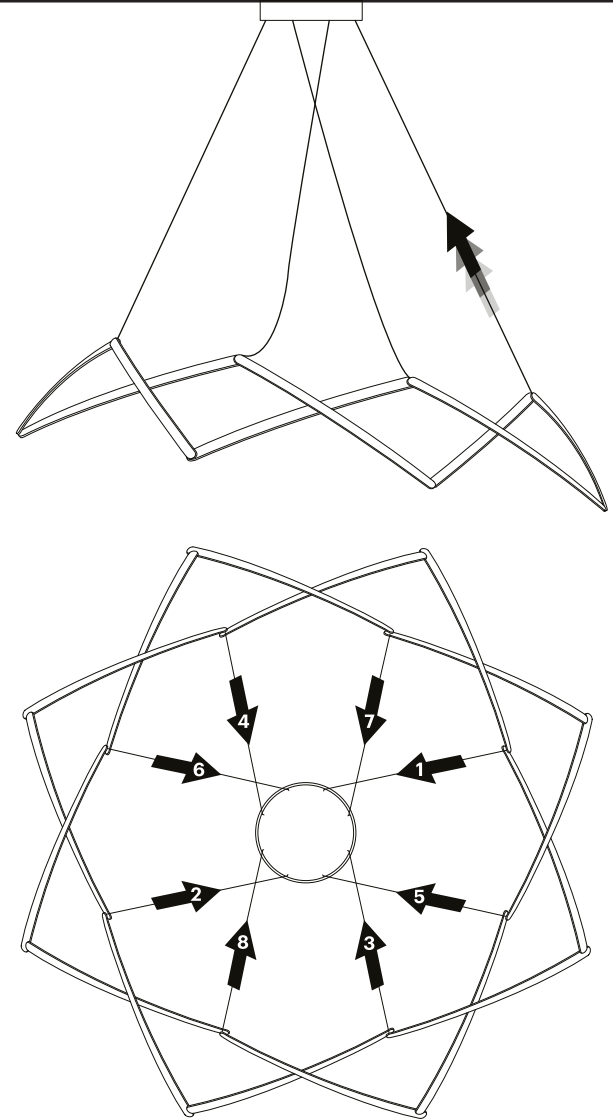
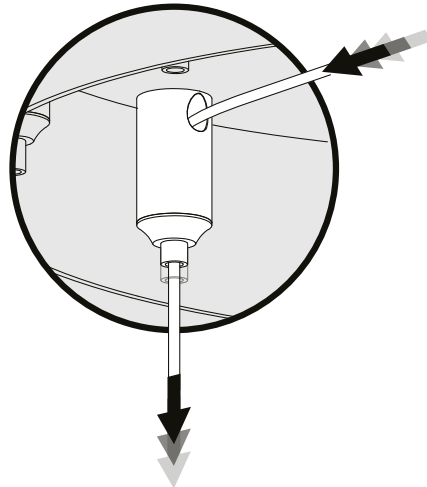
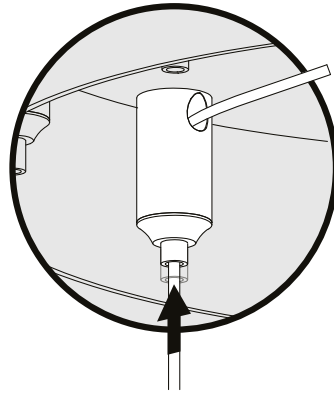

IMPORTANT: When raising or lowering the lamp, we recommend taking a measured approach and alternating between cables that enter the canopy opposite each other and moving around the canopy in a pattern to ensure the stress is distributed evenly across all suspension cables. Use a long level when necessary.

IMPORTANT: Stella is a fully expandable pendant lamp which can change diameter at a moment's notice. Users may decide to set the lamp in one position and leave it there for the duration of the lamps use. Others may decided they want to use the lamp in multiple positions depending on their specific need. In this case it's important to understand the following:

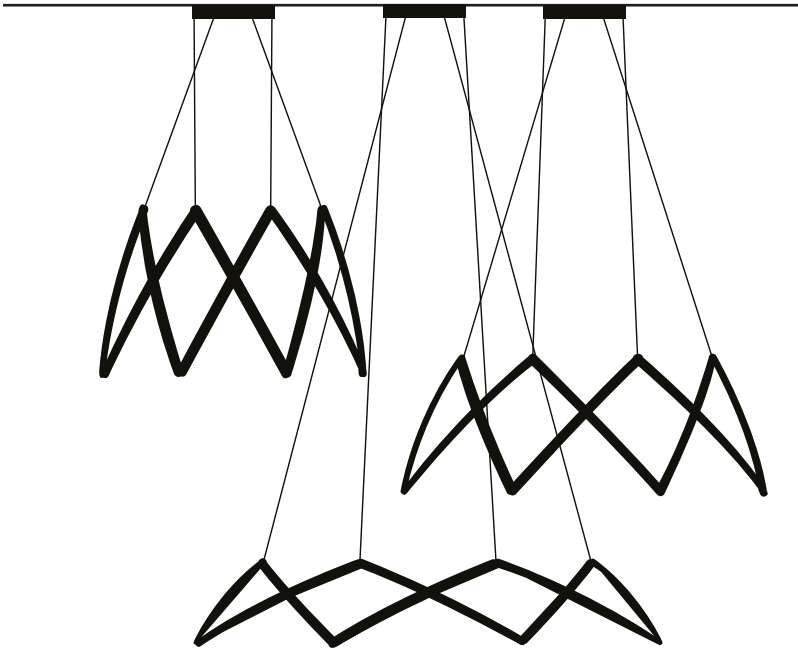
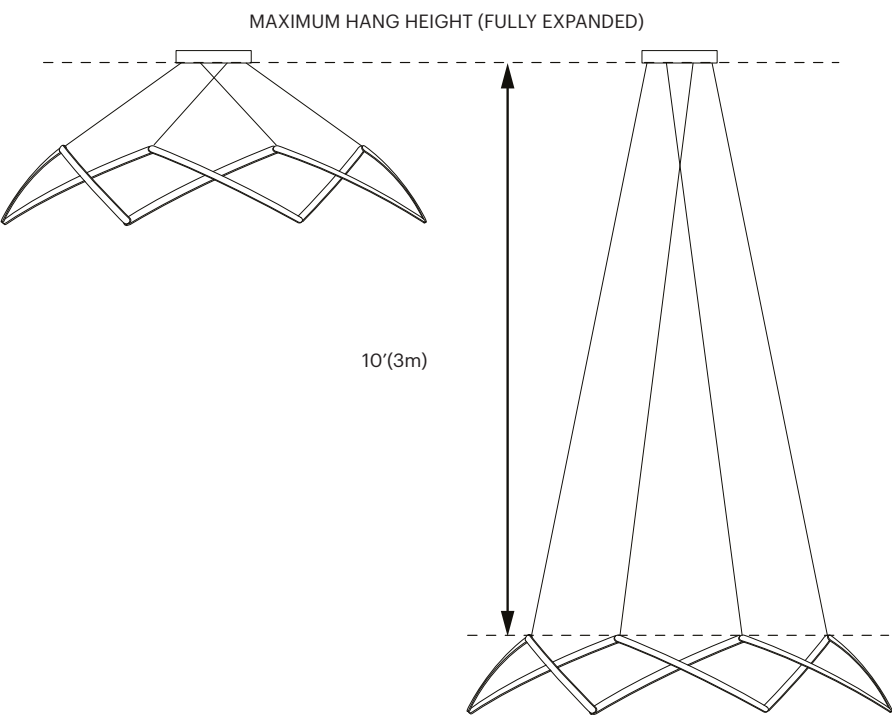
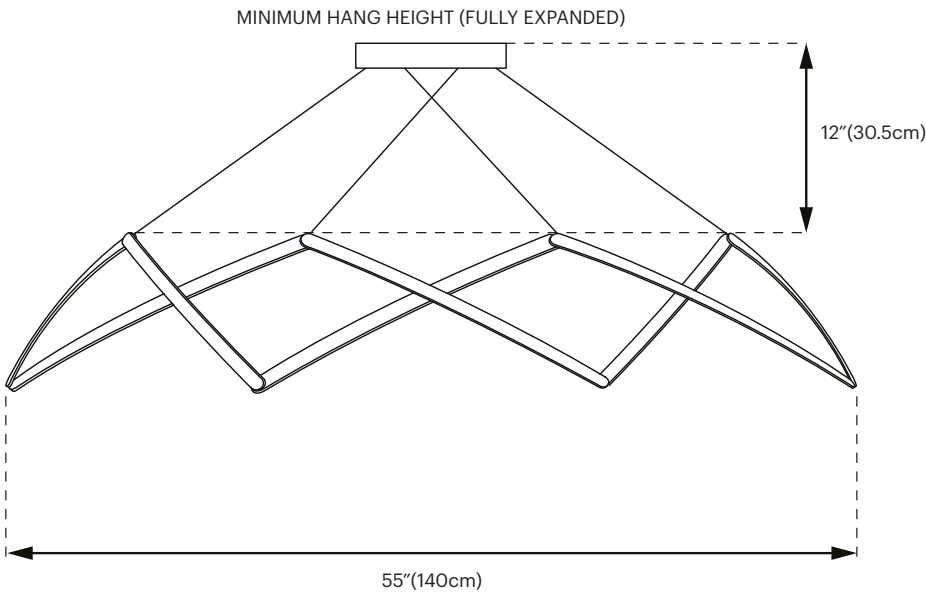
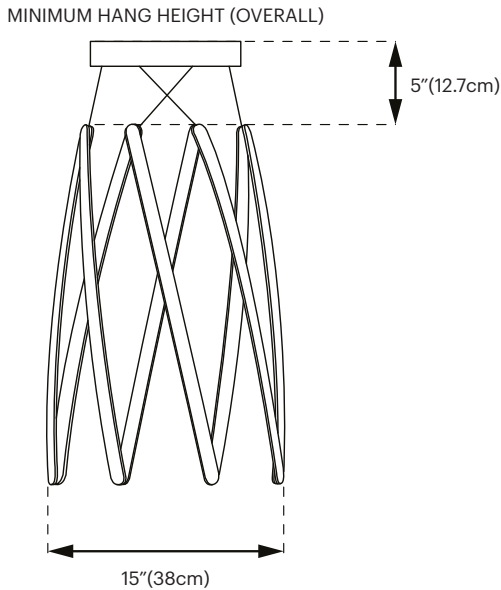

Stella can be hung in groupings with varying heights and diameters to highlight its versatility.