



1718 W. Fullerton Chicago, IL 60614
 Ph: 773.770.1195 • Fax: 773.935.5613
 www.PureEdgeLighting.com • info@PureEdgeLighting.com
 © 2016 PureEdge Lighting. All Rights Reserved.

Installation Instructions for Flex Neon LRF7 24VDC Outdoor Wet Location

FN-LRF7-__

IMPORTANT INFORMATION

- This instruction shows a typical installation.
- The Outdoor Flex Neon is an IP67 rated wet location fixture featuring water tight barrel connections.
- This product bends right to left or left to right.

SAVE THESE INSTRUCTIONS!

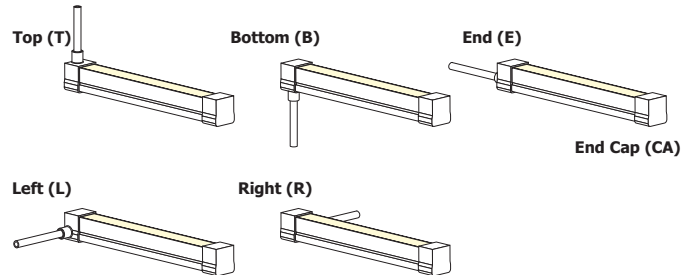

Section One: Install the Flex Neon



NOTE: Omit this Section if using Exterior Channel or Flexible Aluminum Channel. Refer to Section Three or Four.

- 1: Determine the location for the Flex Neon.
- 2: Mark the location of the mounting clips. Mounting clips must be maximum 12" apart from each other (measure from the center of the mounting clip).

NOTE: Steps 3 and 4 are for drywall mounting. Omit these steps if mounting to a wood surface directly.

3: Tap the anchors onto the marked points up to the threaded portion with a hammer.

4: Screw in the threaded portion of the anchors with a Phillips screwdriver.

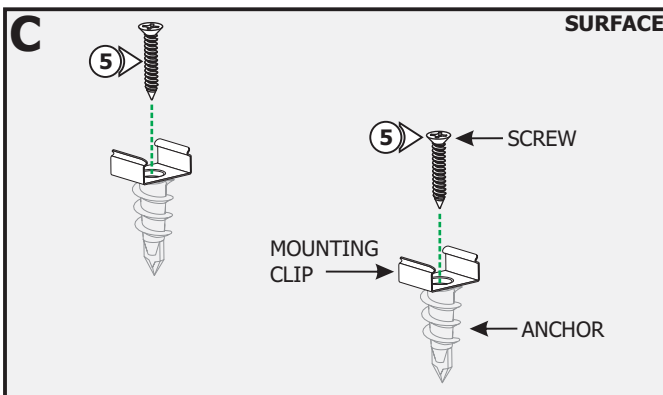
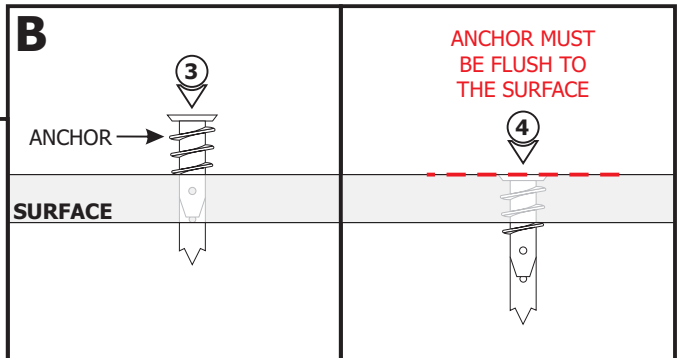

5: Line up the mounting clips to the anchors and secure it to the anchors by tightening the #8-32 screw to each clip.

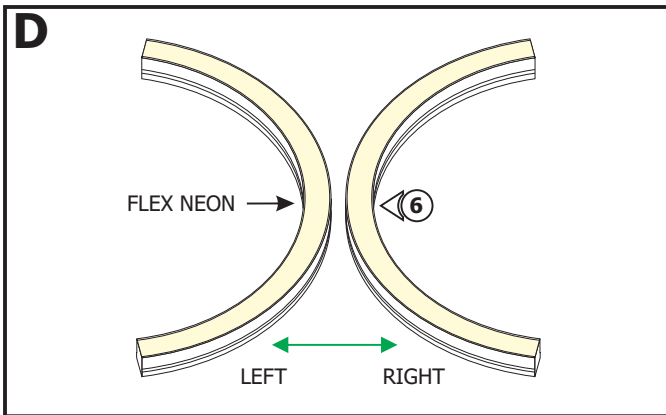

6: If necessary, bend the Flex Neon **ONLY** right to left or left to right.

7: Insert the Flex Neon into each mounting clip.

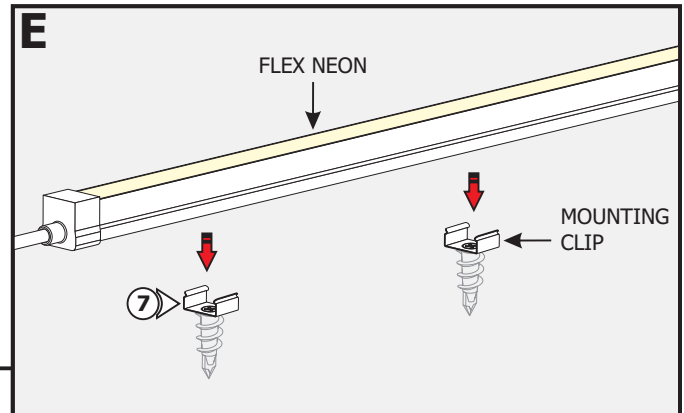

Section Two: Connect to Power

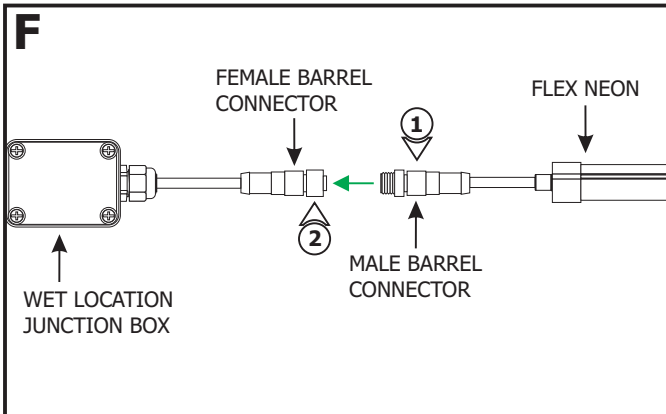

NOTE: Outdoor electrical connections must be made inside a waterproof junction box or using waterproof wire nut connections.

NOTE: Steps 1 through 3 are for the Wet Location Junction Box with Power Cable.

- 1:** Refer to the instructions provided with the wet location junction box to connect to the power supply.
- 2:** Align and push the male barrel connector of the Flex Neon into the female barrel connector going to the power supply.
- 3:** Twist the connector nut to lock in place.

NOTE: Omit steps 4 through 7 if using wet location junction box.

- 4:** Cut the end of the power cord that is going to be connected to power and discard the unused connector.
- 5:** Use AWG wire trimmers to remove the outer insulation from wire harness where electrical connection will be made.

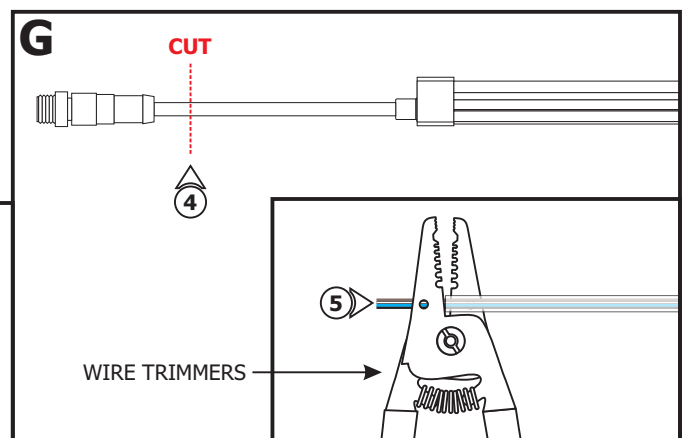

H

6: Connect the white and brown wires of the power cable to the +24VDC wire of the power supply with a wire nut.

7: Connect the blue and black wires of the power cable to the -24VDC wire of the power supply with a wire nut.

8: Refer to the wiring diagram on page 8 and the instructions provided with the power supply to complete the installation.

9: To connect additional Flex Neon, align and push the female barrel connector of one Flex Neon into the male barrel connector of the next one.

10: Twist the connector nut to lock in place. Repeat for any additional sections.

NOTE: Ensure that additional Flex Neon are properly supported and powered.

I

Section Three: Install the Flex Neon with Exterior Channel

J

1: If necessary measure and cut **ONLY** the Exterior Channel to length.

K

MOUNTING CLIP

LOCKING CLIP

NOTE: Clips must be leveled and centered. They must be installed maximum 24" from each other.

2: Determine the location of the Exterior Channel and make all necessary markings on the surface which will consist of the sides and center of the Exterior Channel, mounting clips and locking clips.

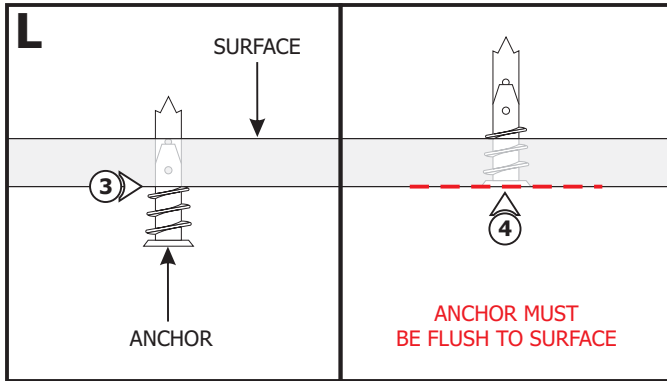

NOTE: Steps 3 and 4 are for drywall mounting. Omit these steps if mounting to a wood surface directly.

3: Tap the anchors onto the marked points up to the threaded portion with a hammer.

4: Screw in the threaded portion of the anchors with a Phillips screwdriver.

Mounting Clips:

5: Line up the mounting clip to the anchor and secure by tightening the screw through the center clip hole into the anchor.

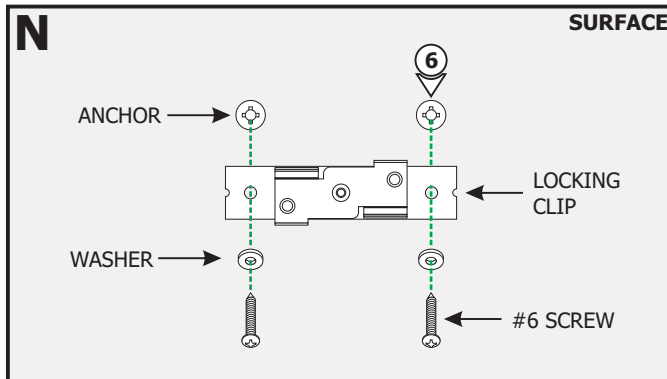
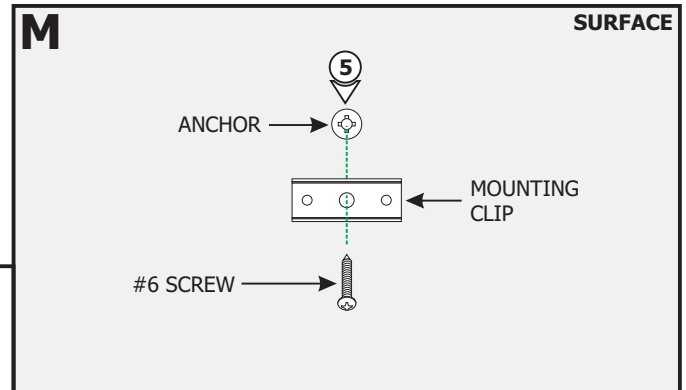

Locking Clips:

6: Line up the locking clips to the anchors and secure them by tightening the two #6 screws through the washers and clip holes into the anchors.

7: Repeat steps 3 through 6 for the remaining mounting and locking clips.

8: Identify the thicker side of the Flex Neon that indicates the location of the LED Soft Strip.

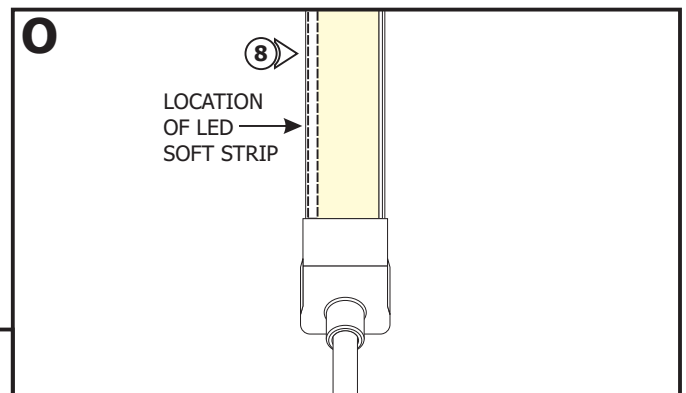

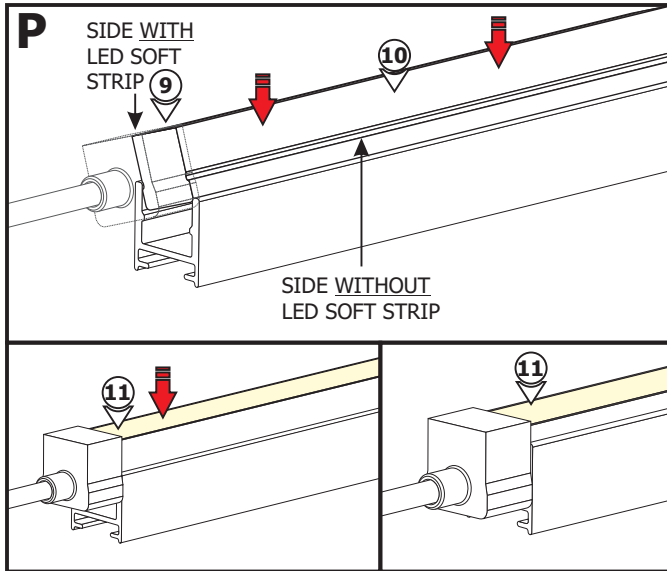

9: Place the side with LED Soft Strip on an angle on top of the Exterior Channel.

10: Slightly push down the side without LED Soft Strip inside the Exterior Channel.

11: Carefully push the Flex Neon completely inside the Exterior Channel.

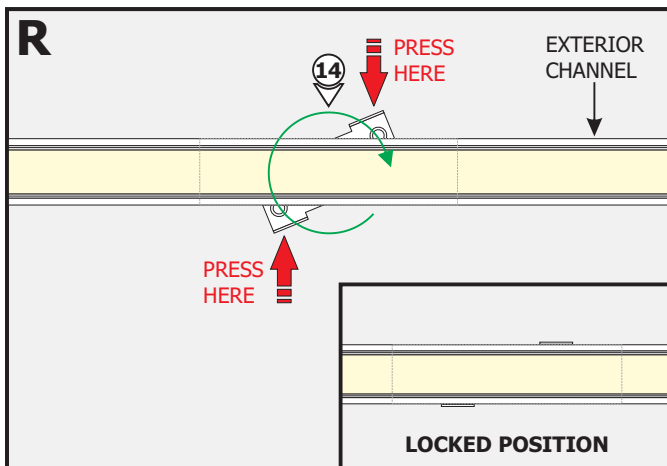
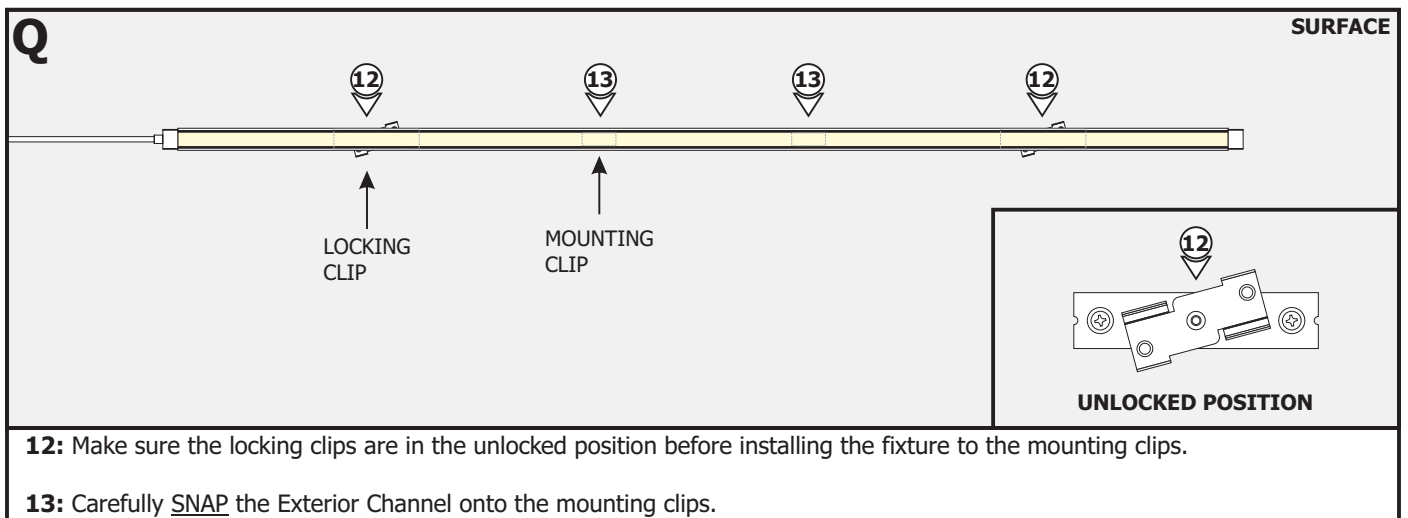

Section Four: Install the Flex Neon with Flexible Aluminum Channel

S

FLEXIBLE ALUMINUM CHANNEL

CUT

LENGTH

1: If necessary measure and cut **ONLY** the Flexible Aluminum Channel to length.

T

SCREW HOLE

BEND

TAB

2: Determine the location of the Flexible Aluminum Channel and mark every fourth tab screw holes.

NOTE: The Flexible Aluminum channel bends in both directions. For simple curves or circles, it is recommended to bend the channel toward the tabs.

NOTE: Steps 3 and 4 are for drywall mounting. Omit these steps if mounting to a wood surface directly.

3: Anchors are not provided. Tap the anchors onto the marked points up to the threaded portion with a hammer.

4: Screw in the threaded portion of the anchors with a Phillips screwdriver.

U

ANCHOR

SURFACE

ANCHOR MUST BE FLUSH TO THE SURFACE

V

SCREW

FLEXIBLE ALUMINUM CHANNEL

SURFACE

5: Secure the Flexible Aluminum Channel to the anchors using screws.

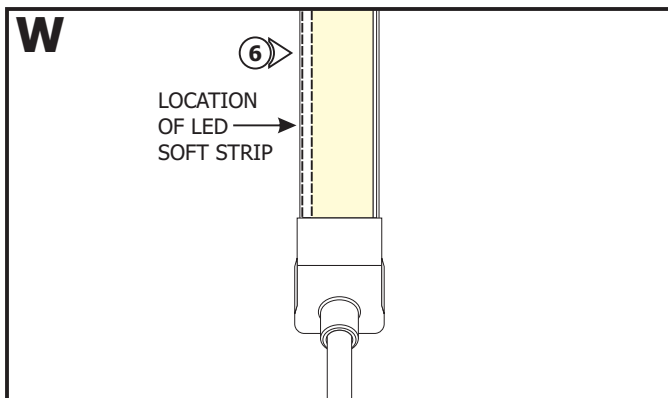

6: Identify the thicker side of the Flex Neon that indicates the location of the LED Soft Strip.

- 7:** Place the side with LED Soft Strip on an angle on top of the Flexible Aluminum Channel.
- 8:** Slightly push down the side without LED Soft Strip inside the Flexible Aluminum Channel.
- 9:** Carefully push the Flex Neon completely inside the Flexible Aluminum Channel.

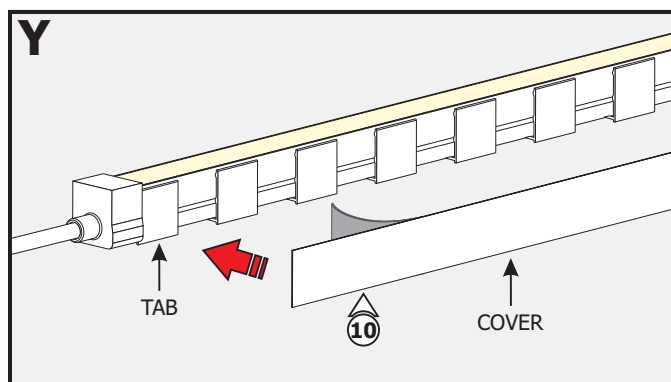
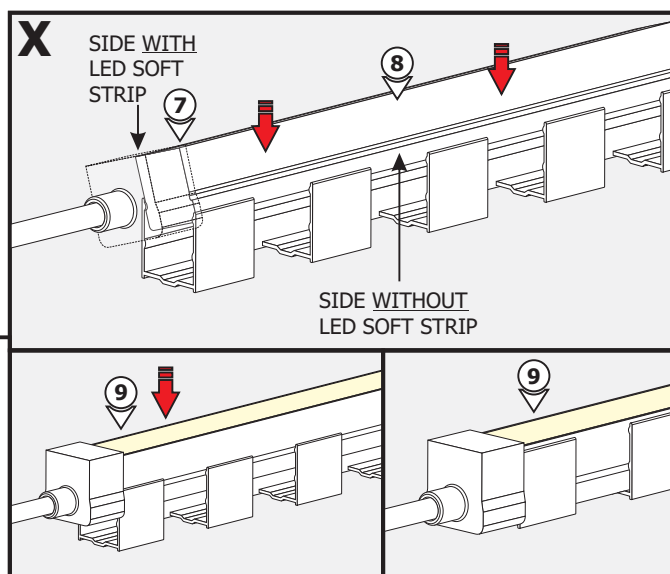

10: Remove the backing from the channel cover. Firmly press down on the Flexible Aluminum Channel tabs while removing the rest of the backing.

11: Refer to Section Two to connect to power.

General Wiring Diagram

