



© 2017 Pure Lighting. All Rights Reserved.

# Installation Instructions For Reveal



1718 W. Fullerton Ave  
Chicago, IL 60614  
Tel: 773-770-1196  
Fax: 773-883-6128  
www.purelighting.com  
info@purelighting.com

## IMPORTANT INFORMATION

- Reveal channel can be used as a toe kick or for cove lighting.
- This instruction shows a typical installation.
- It is recommended more than one person to install the Reveal Channel.

**SAVE THESE INSTRUCTIONS!**

## Install the Junction Box (C-1RE-JBOX)

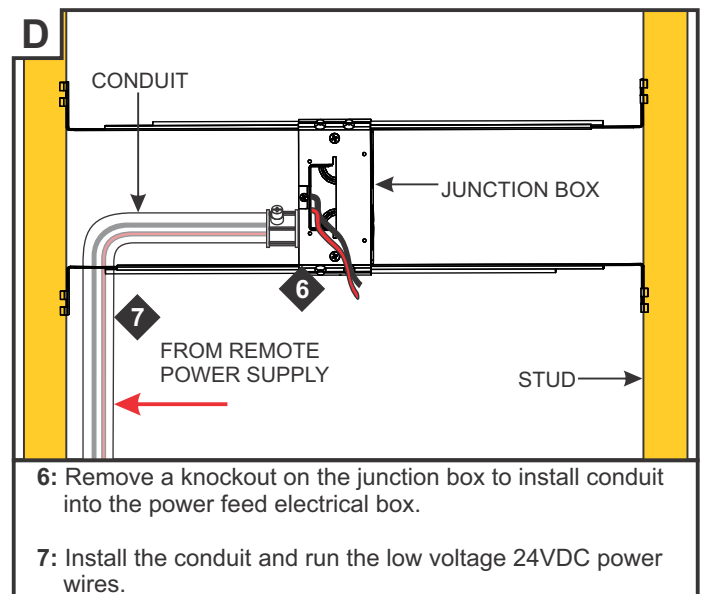
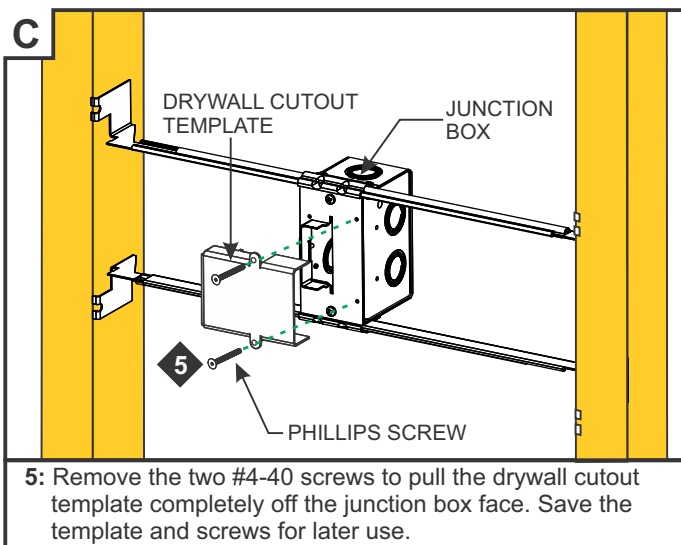
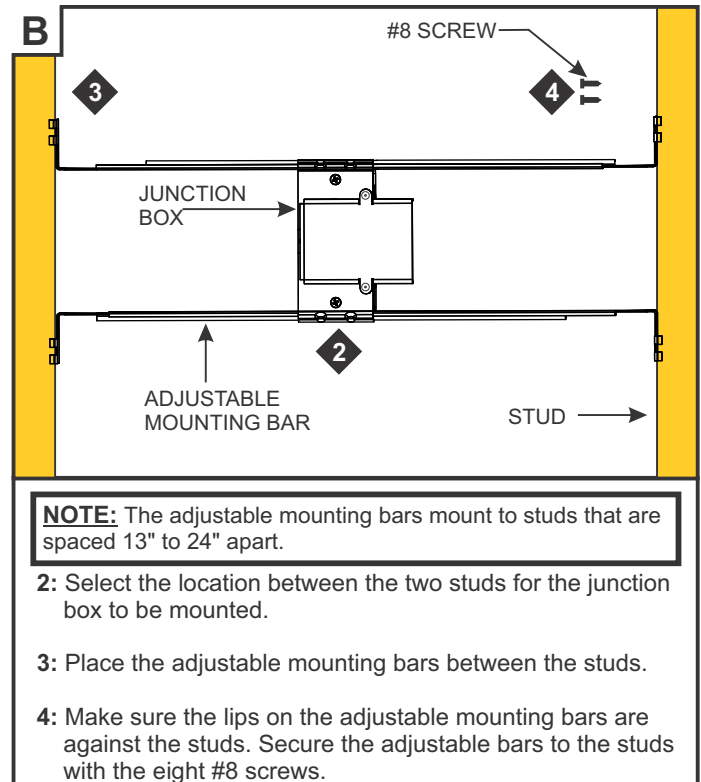
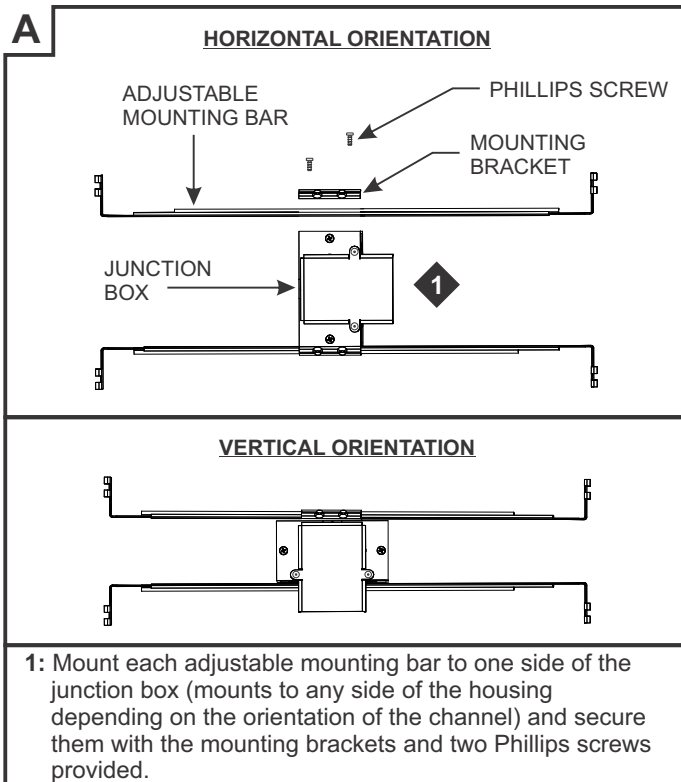

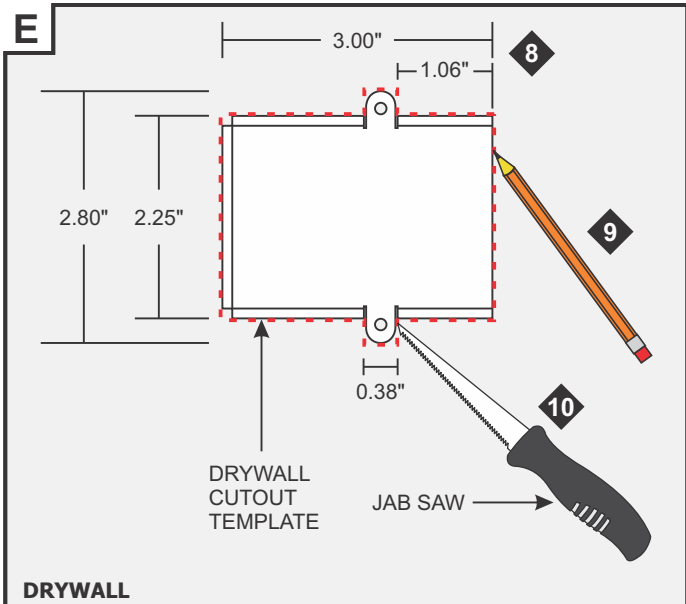

- DRYWALL**
- 8:** Mark a location on the drywall where the junction box will be located.
  - 9:** Trace the drywall cutout template onto the drywall at the junction box location.
  - 10:** Remove drywall cutout template and cut out the marked area using a jab saw or other appropriate tool to expose the junction box.

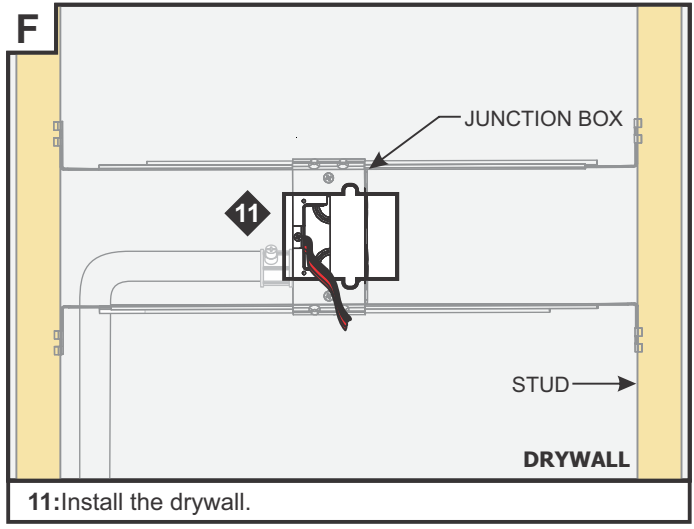

**11:** Install the drywall.

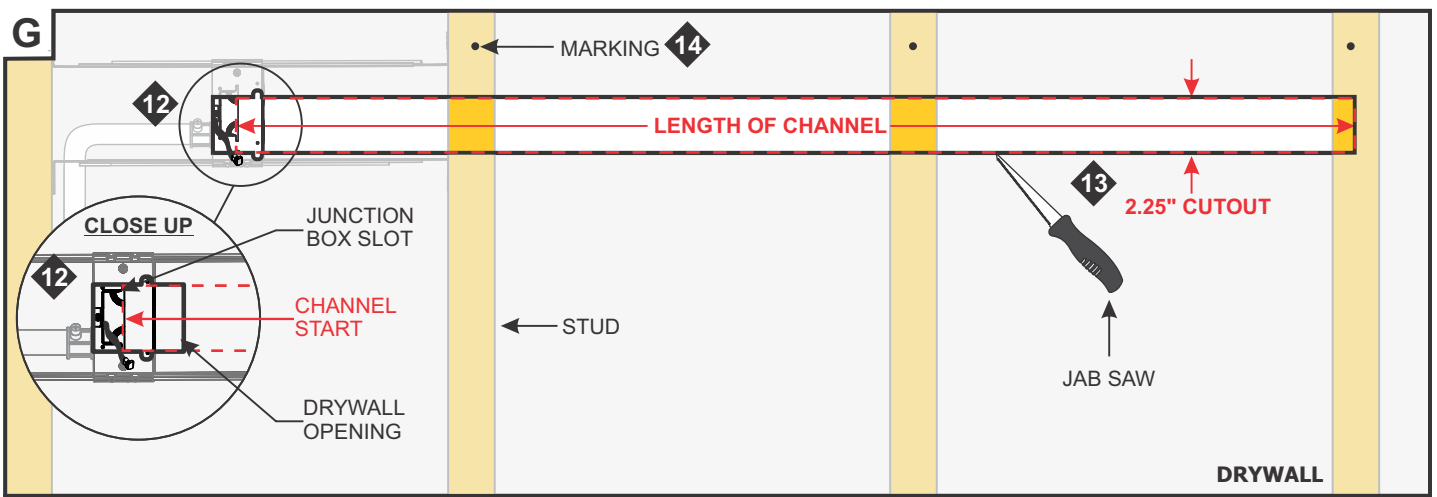

- 12:** Using the drywall opening as reference, mark 2.25" wide lines, the complete length of the channel along the drywall.
- 13:** Cut out the mark lines on the drywall using a jab saw or other appropriate tool.
- 14:** Mark the location to the studs for future reference.

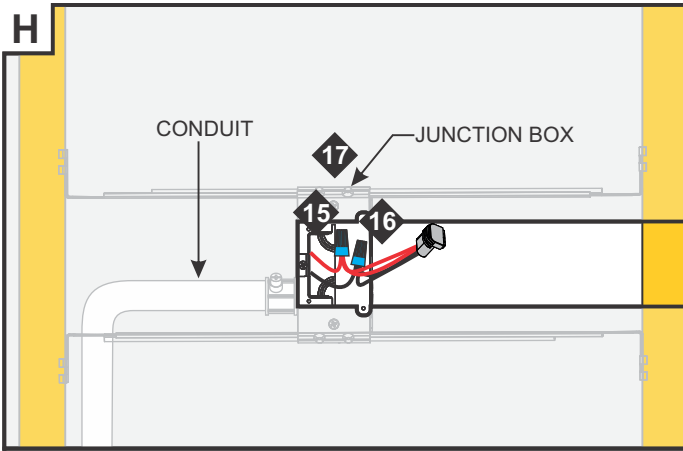

**NOTE:** Remote power supply wires must be present in the junction box. Refer to instructions provided with the power supply.

- 15: Connect the red power supply (24VDC+) wires to each red power wire with a wire nut inside the electrical box.
- 16: Connect the black power supply (24VDC-) wires to each black power wire with a wire nut inside the electrical box.
- 17: Place the wire nut connections inside junction box.

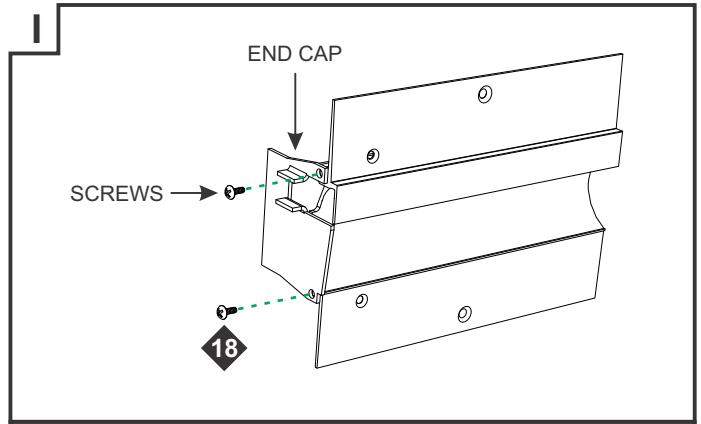

18: Install the power feed end cap to the end of the channel that will be aligned with the junction box with the supplied screws.

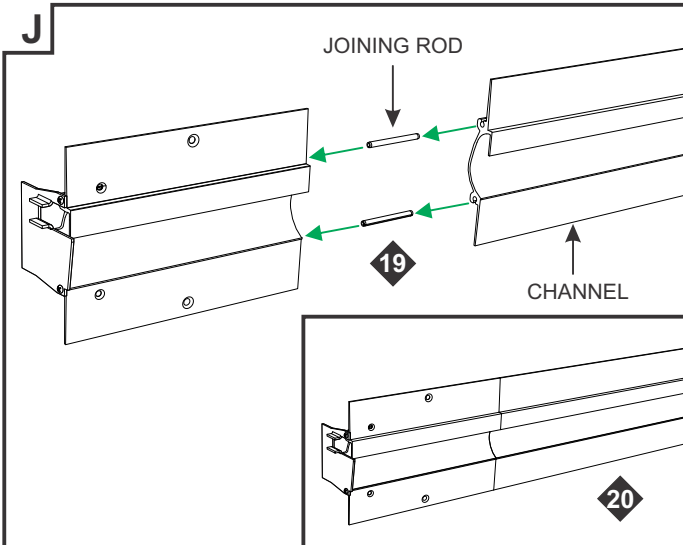

**NOTE:** Channel may be cut in the field. For installation over 120" join two or more Reveal channels together.

- 19: Insert joining rods halfway into the channel.
- 20: Slide another channel onto the joining rods.

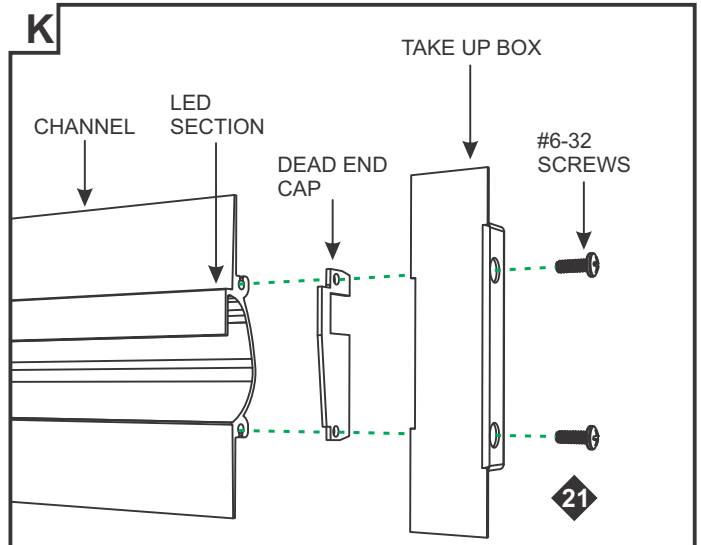

21: Install the dead end cap and take up box to the end of the channel opposite of the junction box using the supplied screws. Ensure the slot of the dead end cap aligns with the LED section of the channel.

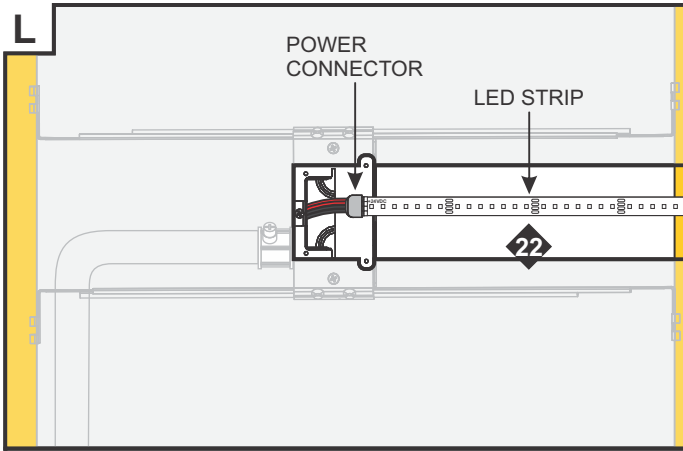

**NOTE:** Test the LED strip before securing the channel to the drywall.

**22:** Align the "+24VDC" marking on the LED strip with the red wire of the power connector. Push the male connector of the LED strip into the female connector of the power cables. Inspect the strip for any irregularities.

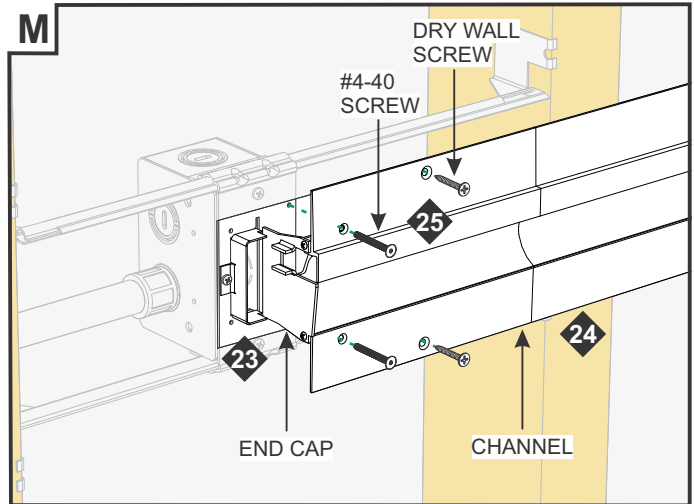

**23:** Align the power feed end cap into the junction box opening slot and push the channel into the drywall cutout.

**24:** Make sure the channel is aligned straight using a level.

**25:** Secure the channel using the two #4-40 screws to the junction box (same screws as in step 5 page 1). Fasten the drywall screws through the pre-drilled holes onto the studs. **If necessary drill new holes on channel flange where they line up with the studs using the #6 X 1-5/8" square trim screw with the square recess bit provided.**

**NOTE:** Ensure screw heads sit flush with the channel.

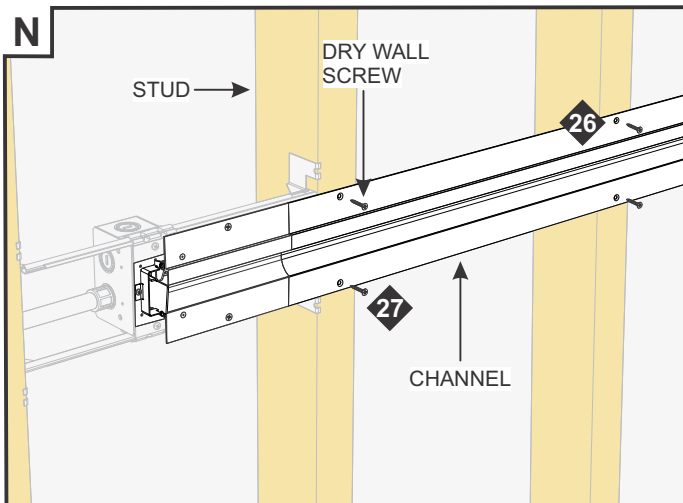

**26:** Drill and countersink holes to the channel at marked stud positions.

**27:** Secure the channel to the studs using drywall screws.

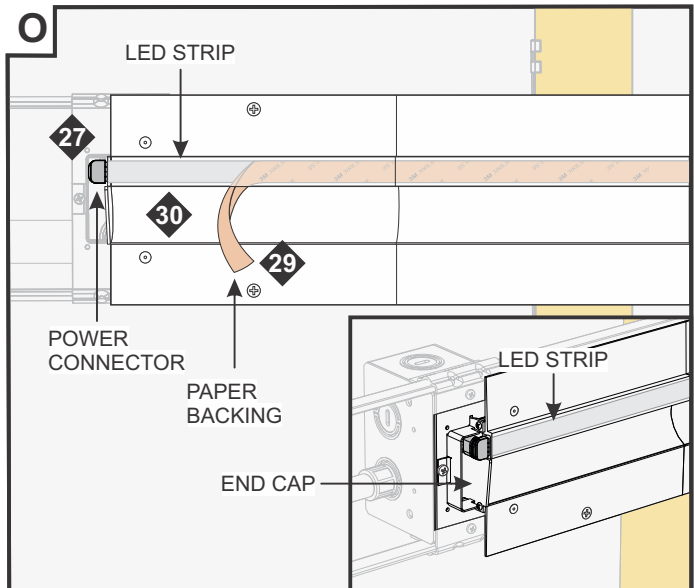

**NOTE:** If installation requires RGB, RGB+W, or Tunable White, refer to wiring diagrams on pages 7 through 9.

**28:** Connect the LED strip to the power connector and place the power connector into the slot in the power feed end cap.

**29:** Carefully remove the backing from the LED strip, making sure not to remove the tape from the back of the strip.

**30:** Firmly press down the adhesive portion of the LED strip onto the channel surface while removing the rest of the backing, making sure there are no air bubbles that can cause surface irregularities.

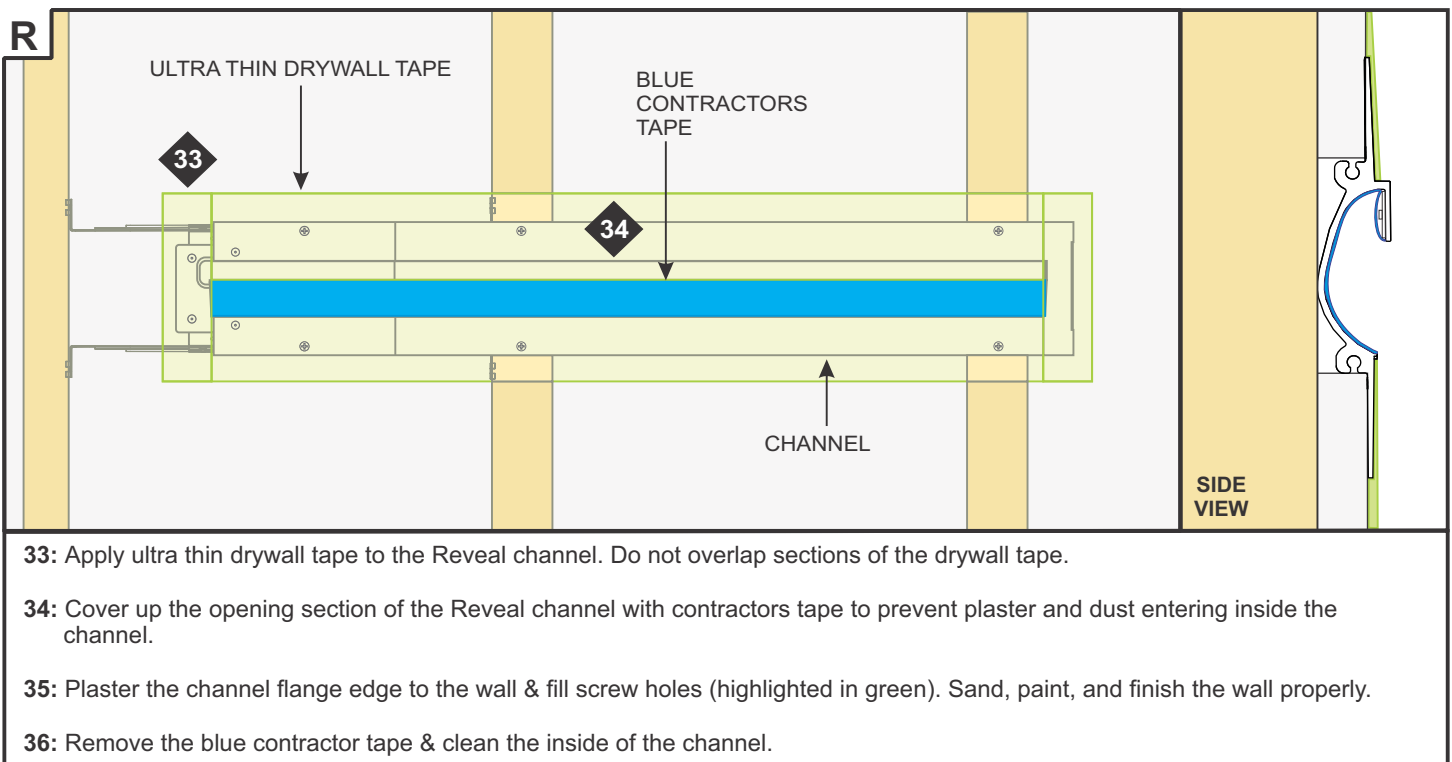
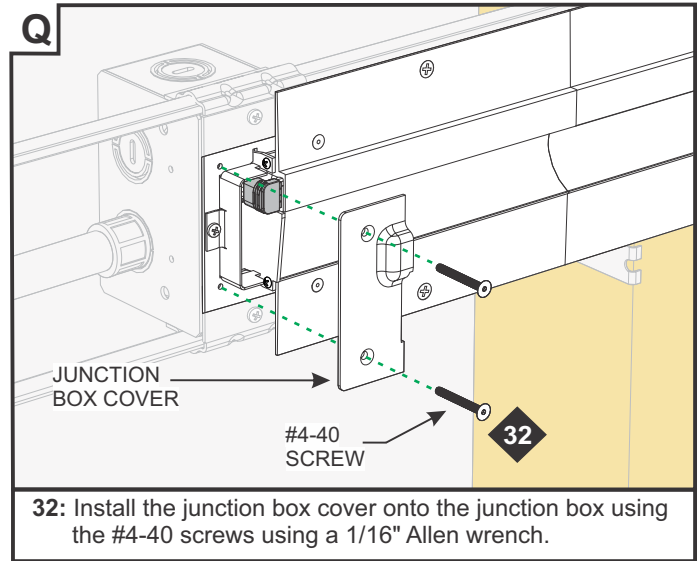
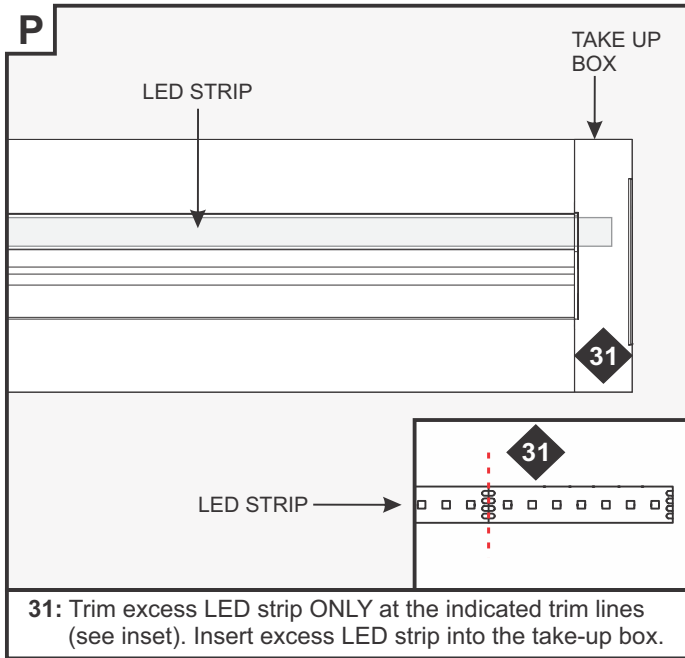

## IMPORTANT INFORMATION REGARDING INSTALLATION AND REWORK OF SOFT STRIP LED

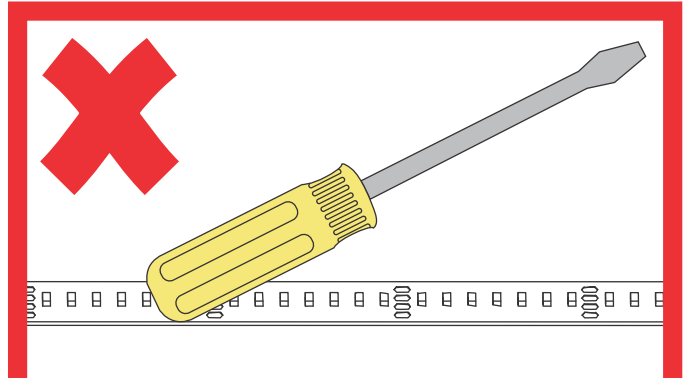
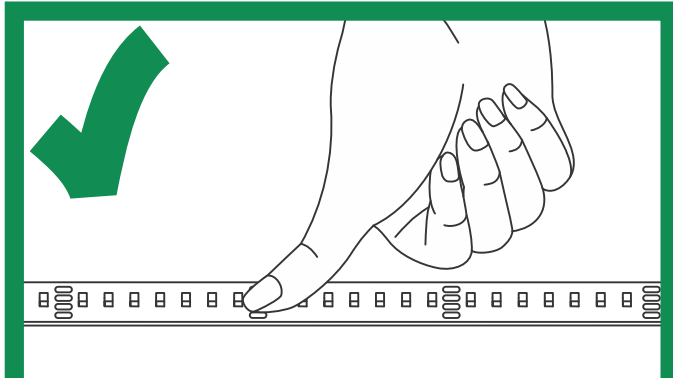
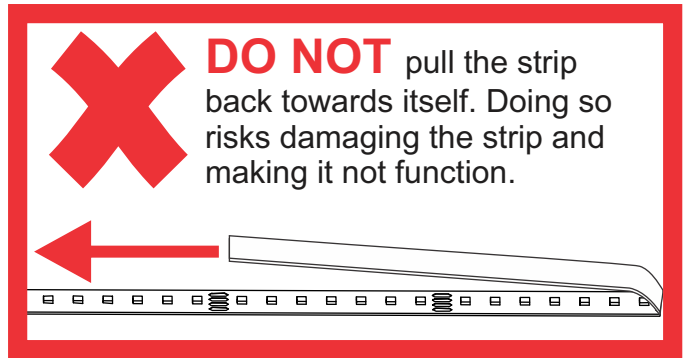
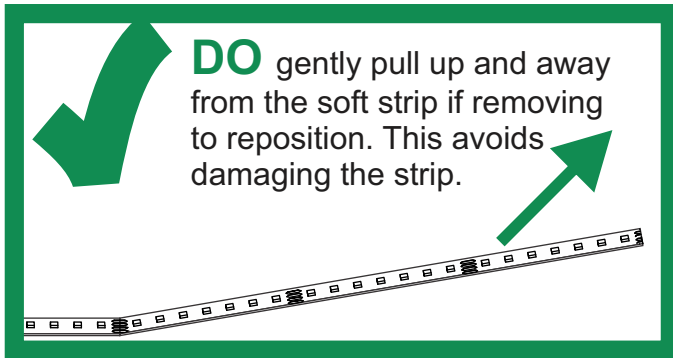

### Relocating Soft Strip (Optional)

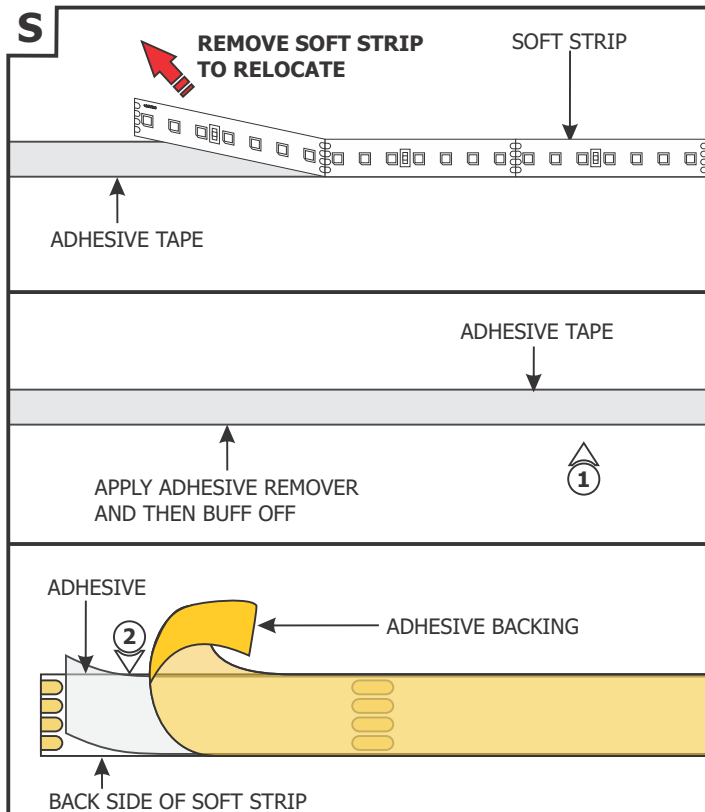

**NOTE:** If relocating the installed soft strip, make sure that the adhesive tape on back of the soft strip covers the entire strip. The adhesive tape isolates the strip from the installation surface. Damaged or inconsistent adhesive tape may cause the contacts on the back of the strip to come in contact with the conductive heat sink which will cause the strip to short and burn. Call Edge Lighting to get replacement adhesive tape and/or optional aluminum heat sink tape (SS-HR-F).

- 1:** To remove tape residue from back of the strip, apply WD-40, Goo Gone, or a mixture of warm water and lemon oil to the corner of a clean, dry towel. Gently buff the area containing the adhesive residue until it is completely removed.
- 2:** Gently remove a few inches of the from one side of the tape backing. Attach the adhesive tape to the back of the soft strip and apply moderate pressure to affix the tape. Continue this step a few inches at the time until the entire adhesive tape is attached to back of the soft strip.
- 3:** Refer to steps 28 through 31 on pages 4 and 5 to reinstall the LED strip.

## General 0-10V Configuration

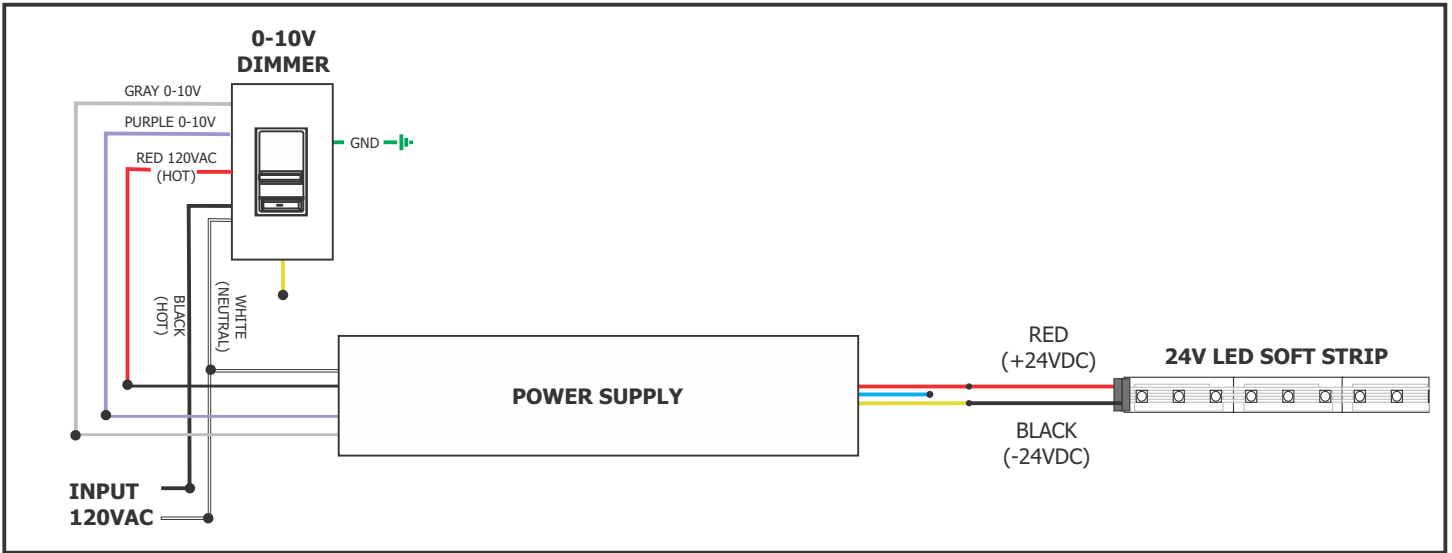

## General 24VDC Configuration

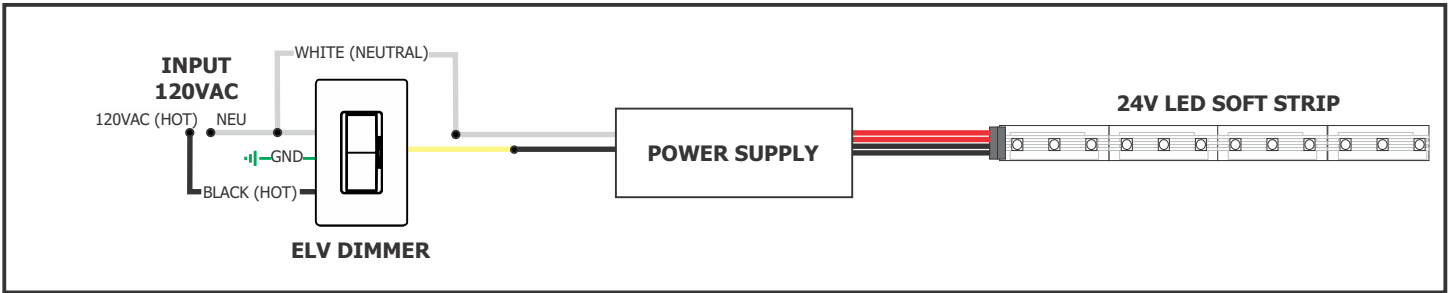

## RGB Configuration

### Using LED Power Supply with RGB Soft Strip & CDP or CTP Control

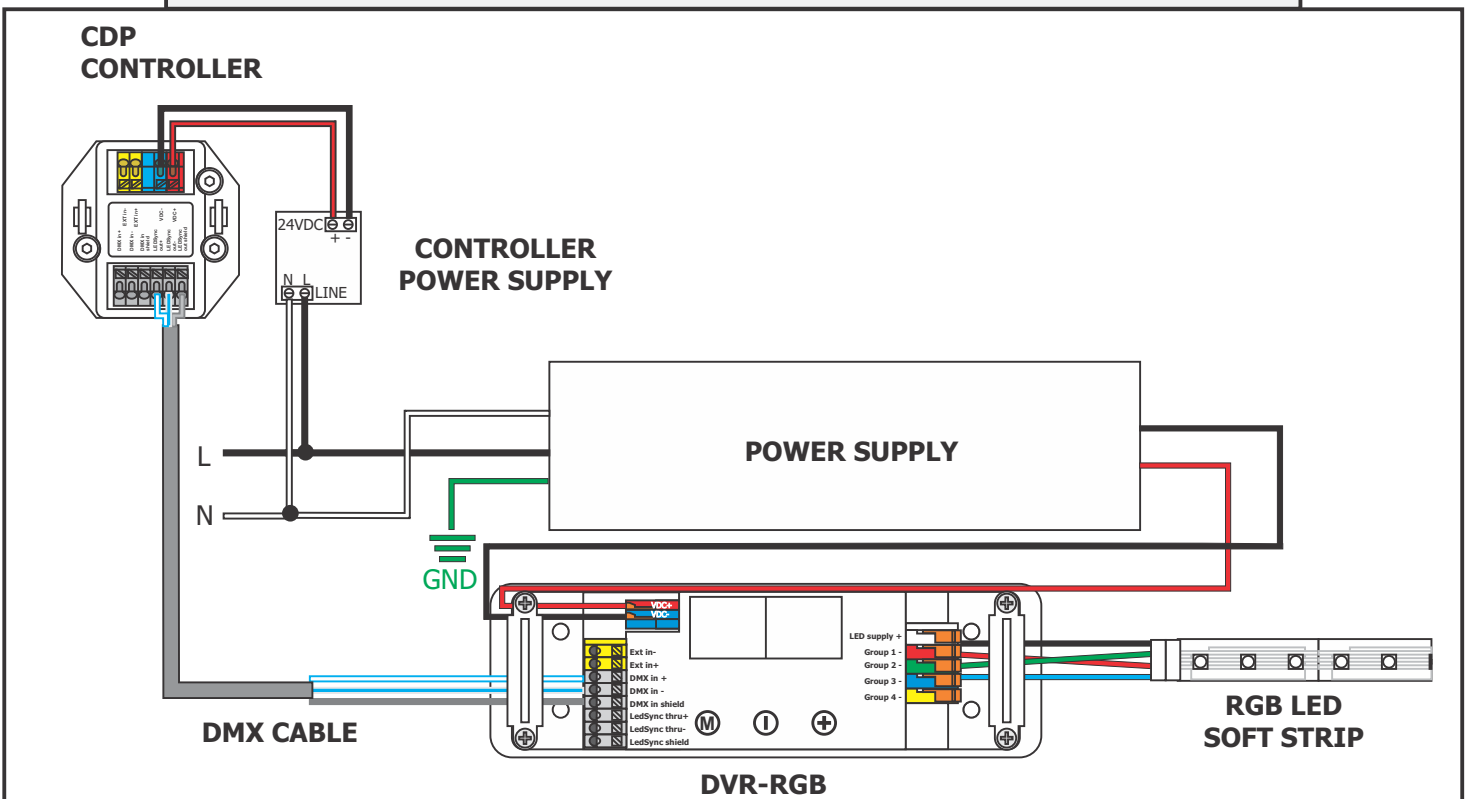

## RGB+W Configuration

Using LED Power Supply with RGB+W Soft Strip & CDP or CTP Control

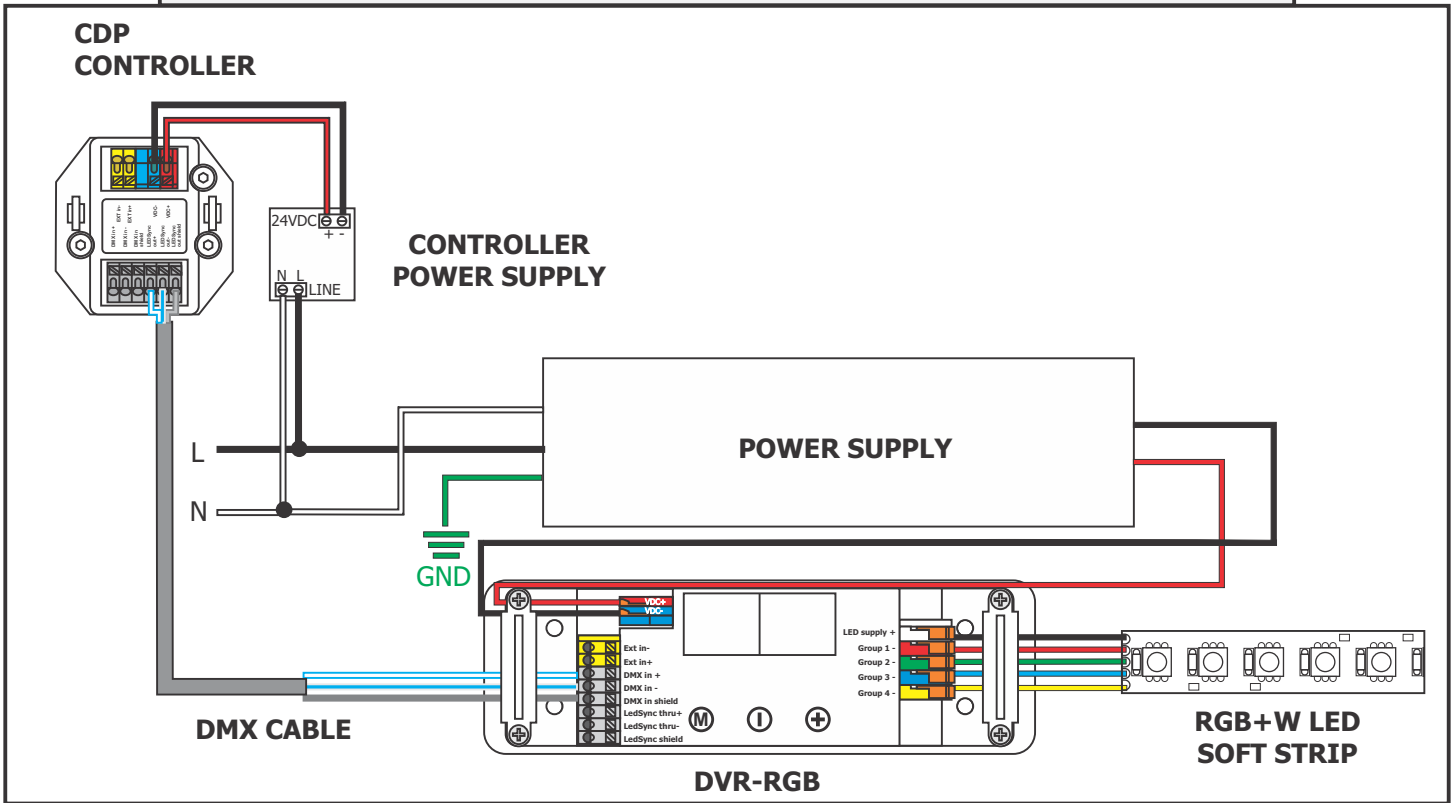

## Tunable White Configuration

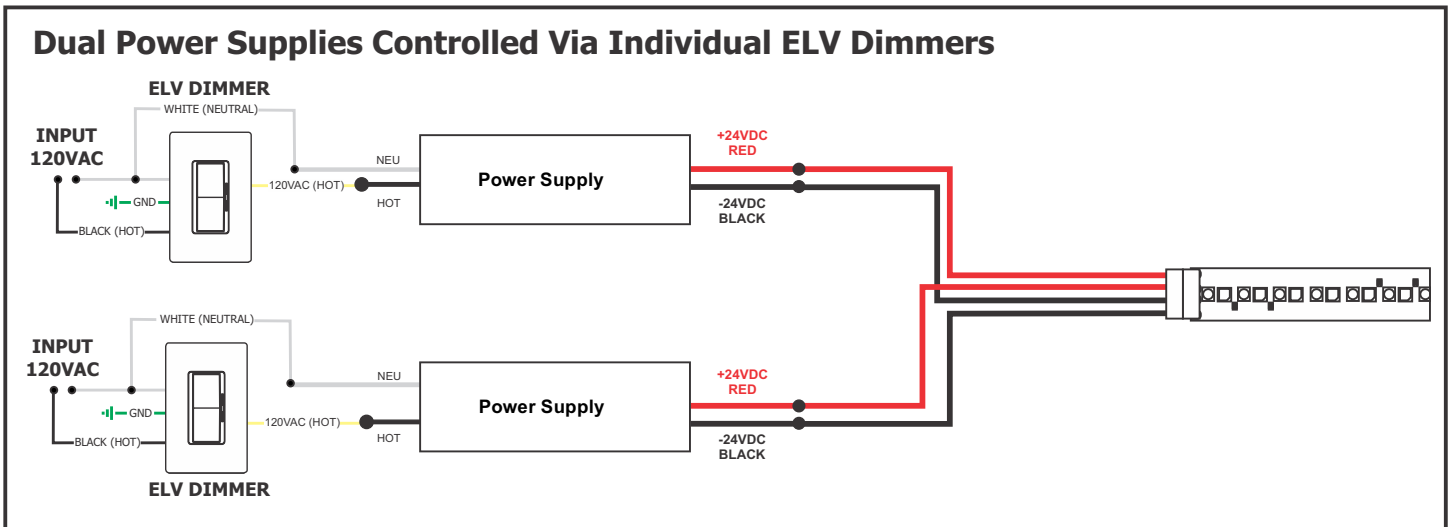



# Tunable White Configuration

## RGB Power Supply with DMX Controller

CDP/CTP or other  
DMX Signal From Any  
Compatible Controller

LED SYNC OUT +  
LED SYNC OUT -  
LED SYNC OUT SHIELD

DMX Cable  
(belden #9841 or CAT5)

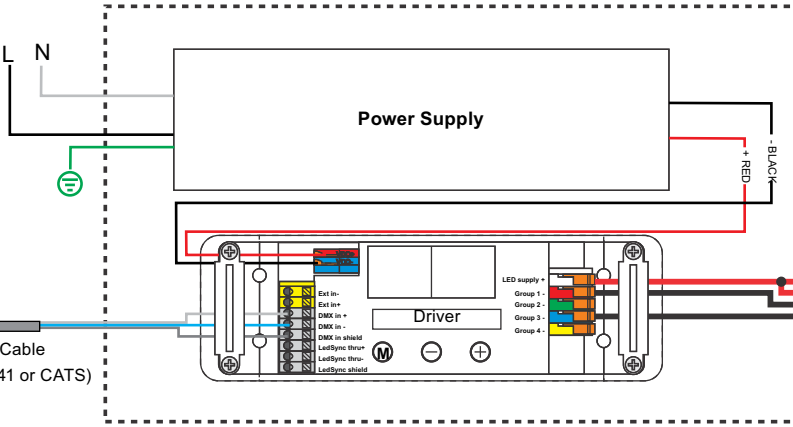

If using a CDP Color Dial, configure your CDP  
to Warm White mode using DIP switches and  
follow CDP operating instructions:

