

# Echo Grande

700TDECGP\_

1.1



## GENERAL PRODUCT INFORMATION:

This product is suitable for damp locations.



This product can be dimmed with a LED or TRIAC dimmer. Consult lamp manufacturer for additional information.



## Installing the Outer Glass & Lamp

**CAUTION:** To reduce the risk of a burn or electric shock during relamping, disconnect the power to the fixture.

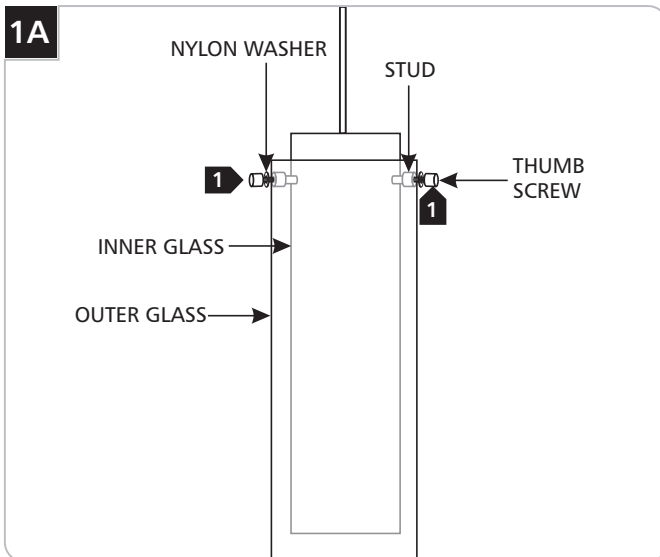

**1** Line up the outer glass holes with the inner glass studs and secure the outer glass to inner glass with provided thumb screws and nylon washers.

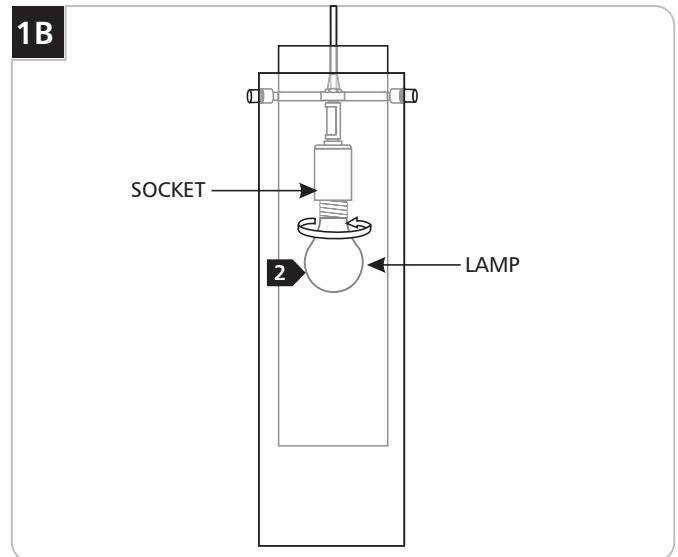

Refer to fixture marking for lamp information.

**2** Screw the lamp into the socket.

**SAVE THESE INSTRUCTIONS!**



**TECH LIGHTING®**

7400 Linder Ave, Skokie, IL 60077

847.410.4400

[www.techlighting.com](http://www.techlighting.com)

© 2017 Tech Lighting, L.L.C. All rights reserved. The "Tech Lighting" graphic is a registered trademark of Tech Lighting, L.L.C. Tech Lighting reserves the right to change specifications for product improvements without notification.

A Generation Brands Company