

Collier Wall

700WSCLR_

1.0

TECH LIGHTING®

WALL

GENERAL PRODUCT INFORMATION:



These fixtures are intended to be installed utilizing NEC compliant junction boxes. **Either a 2"x4" Junction box or 4" Junction Box may be used.**

This product is suitable for dry locations only.

This instruction shows a typical installation.

CAUTION - RISK OF FIRE

This product must be installed in accordance with the applicable installation code by a person familiar with the construction and operation of the product and the hazards involved.

Use minimum 90°C supply conductors.

SAVE THESE INSTRUCTIONS!

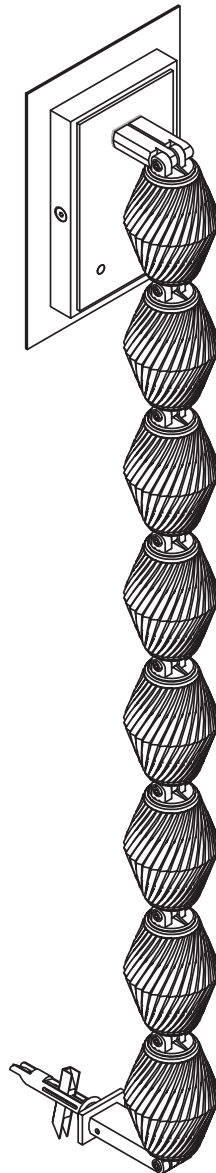

TECH LIGHTING

7400 Linder Ave., Skokie, IL 60077
T 847.410.4400 | F 847.410.4500
www.techlighting.com

Install the Canopy

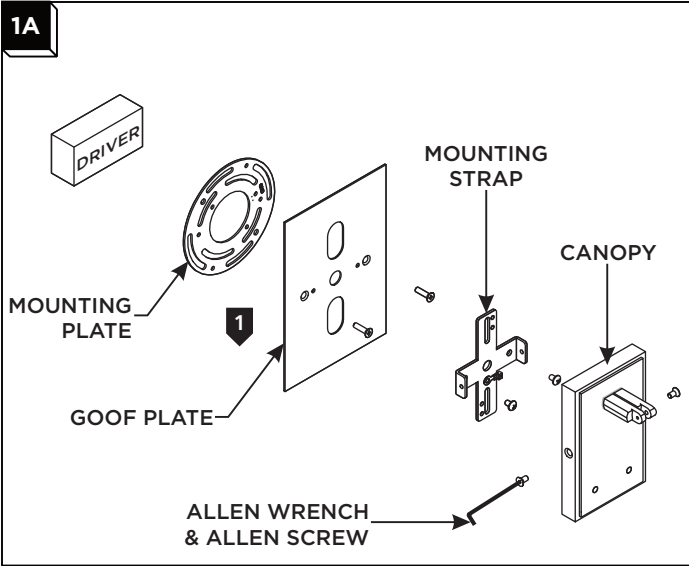

1 Remove the driver and mounting hardware from the canopy by removing the Allen screws using the provided Allen wrench.

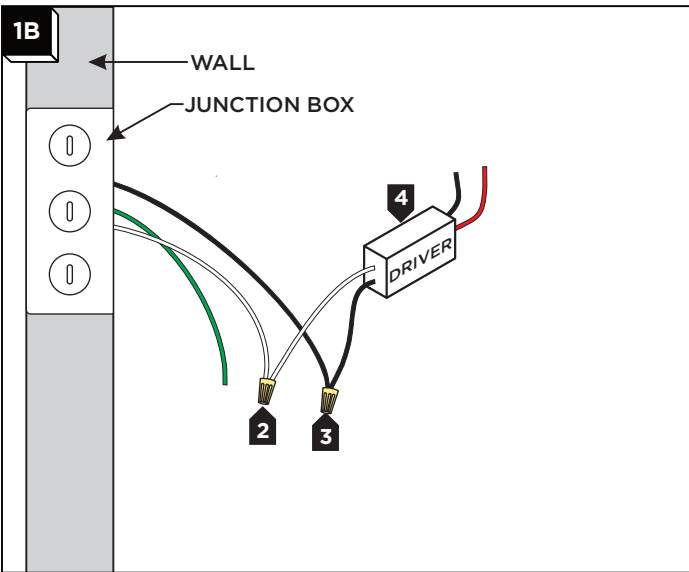

- 2** Connect the white driver wire to the neutral power line with a wire nut.
- 3** Connect the black driver wire to the hot power line with a wire nut.
- 4** Place the driver into the junction box.

For 2"x4" junction boxes, go to step 1C.
For junction boxes larger than 2"x4" , skip to step 1D.

NOTE: The goof plate is intended for use with a junction boxes larger than 2"x4". The goof plate may still be installed using a 2"x4" junction box for aesthetic purposes.

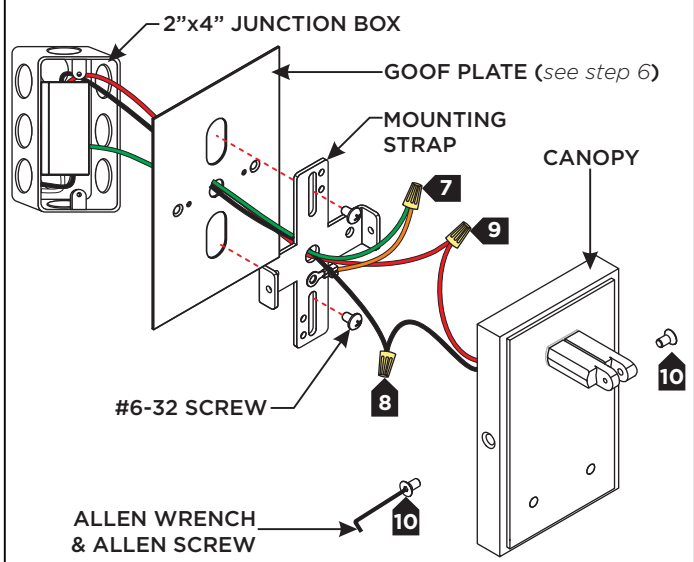
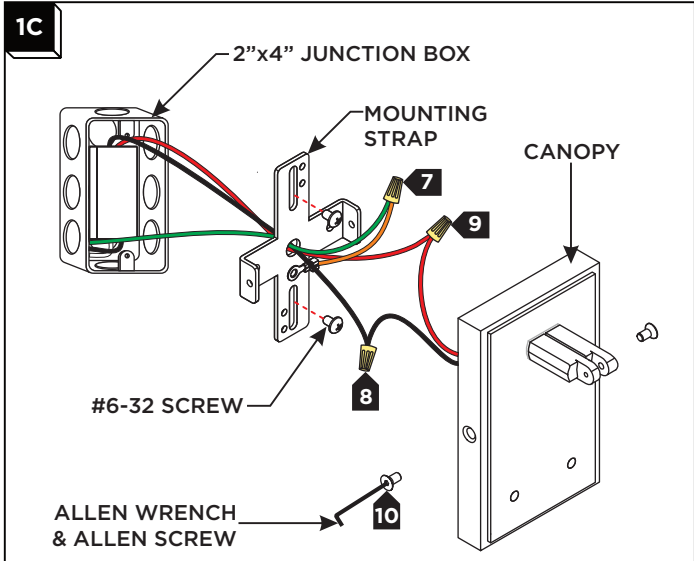

- 5** For junction boxes larger than 2"x4", skip to step 1D.
- 6** Feed the ground and driver output wires through the center of the mounting strap and install it to the 2"x4" junction box with the two 6-32x.75" pan head screws. **NOTE:** If installing the goof plate for aesthetic purposes, install the goof plate along with the mounting strap using the two 6-32x.75".
- 7** Connect the fixture to a suitable ground in accordance with local electrical codes.
- 8** Connect the black/blue driver wire to the black/blue fixture wire with a wire nut.
- 9** Connect the red driver wire to the red fixture wire with a wire nut.
- 10** Install the canopy onto the mounting strap with the Allen screws using the provided Allen wrench.

Install the Strings

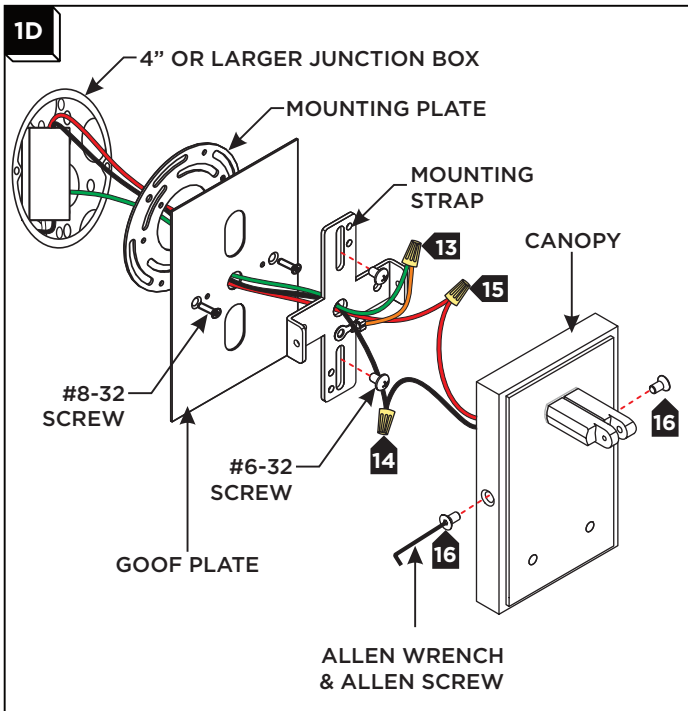

- 11** Feed the ground and driver output wires through the center of the mounting plate and goof plate, then install them to a junction box 4" or greater with the two #8-32" screws ensuring that the threaded holes on the mounting plate are positioned vertical and leveled.
- 12** Feed the ground and driver output wires through the center of the mounting strap, then install it to the goof plate with the two 6-32x.75" pan head screws
- 13** Connect the fixture to a suitable ground in accordance with local electrical codes.
- 14** Connect the black/blue driver wire to the black/blue fixture wire with a wire nut.
- 15** Connect the red driver wire to the red fixture wire with a wire nut.
- 16** Install the canopy onto the mounting strap with the Allen screws using the provided Allen wrench.

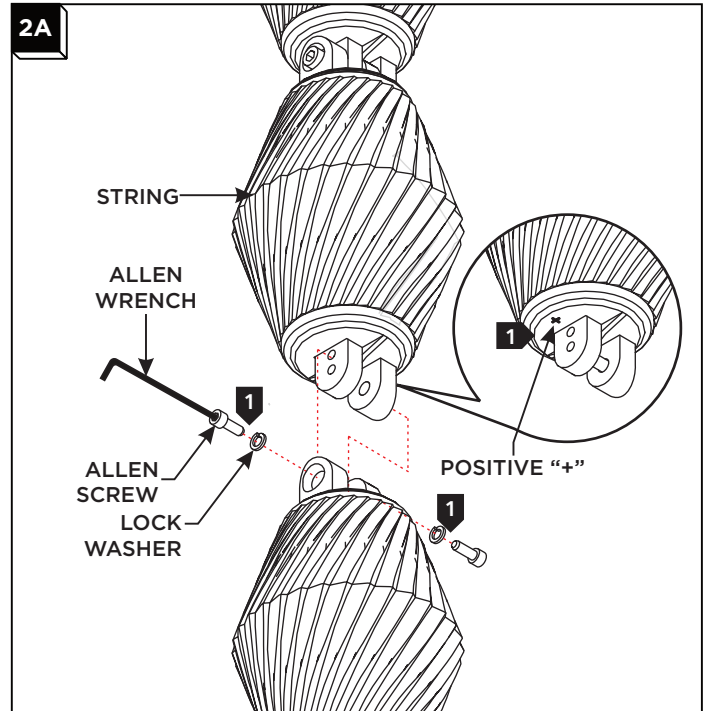

- 1** Connect strings together by using the washers and Allen screws making sure to match the polarity. Tighten the Allen screws until snug. **Only connect up to 2' strings at a time** (8 modules max).

CAUTION: Do not hold up more than 2' of string by a single crystal. The weight from the string may damage the end-cap components and cause damage to the string. Handle strings with two hands, and handle like delicate jewelry.

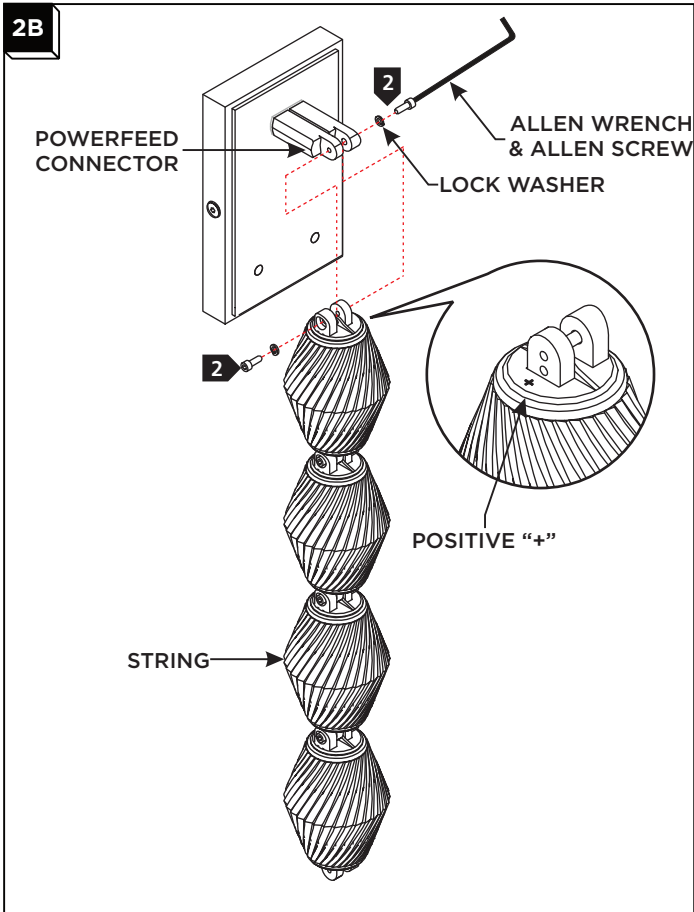

2 Connect strings to the power feed connector by using the washers and Allen screws making sure to match the polarity. Tighten the Allen screws until snug. **Only connect up to 2' strings at a time** (8 modules max).

If installing the Stand-off, go to step 3A.
If installing the Finial, go to step 4A.

Install the Stand-off (Optional)

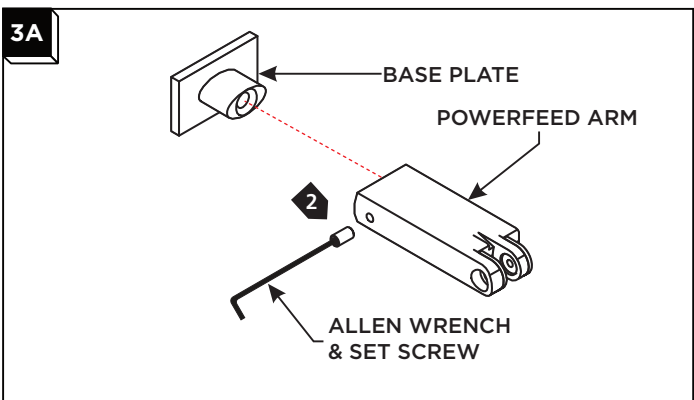

1 Disassemble stand-off assembly by unscrewing the set screw on the powerfeed arm using the provided Allen wrench.

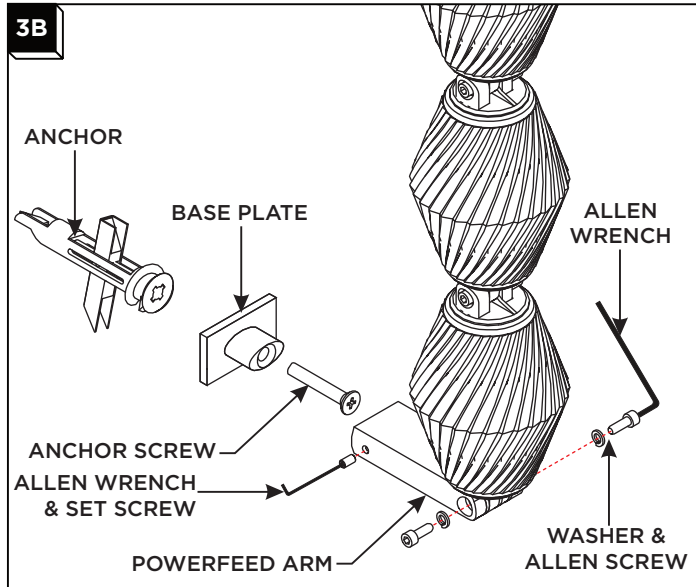

- 2** Install stand off powerfeed arm to the end of the string using the Allen screws and washers with the provided Allen wrench.
- 3** Measure and mark against wall surface where stand-off locates.
- 4** Install anchor to surface at marked location.
- 5** Install anchor screw to secure stand-off base plate to surface.
- 6** Insert stand-off to base plate and secure with set-screw using the provided Allen wrench.

Install the End Cap (Optional)

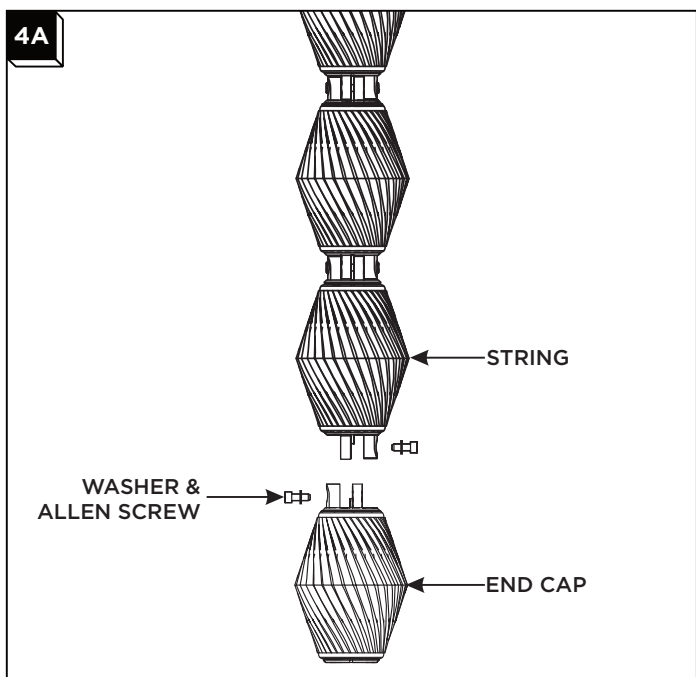

1 Install the end cap to the end of a string using the washers and Allen screws making sure to match the polarity. Tighten the Allen screws until snug.