

Ponte Task Sconce

SLTS14530, SLTS14630 | 1.0

VISUAL COMFORT & Co.

MODERN COLLECTION

GENERAL PRODUCT INFORMATION:

These fixtures are intended to be installed utilizing NEC compliant junction boxes.

Use approximate 2"x4" single gang junction box or provided universal mounting/goof plate to completely cover the junction box.

This product is safety listed for damp locations.

This product features a four way built-in dimmer.

This instruction shows a typical installation.

CAUTION - RISK OF FIRE

This product must be installed in accordance with the applicable installation code by a person familiar with the construction and operation of the product and the hazards involved.

Use minimum 90°C supply conductors.

SAVE THESE INSTRUCTIONS!

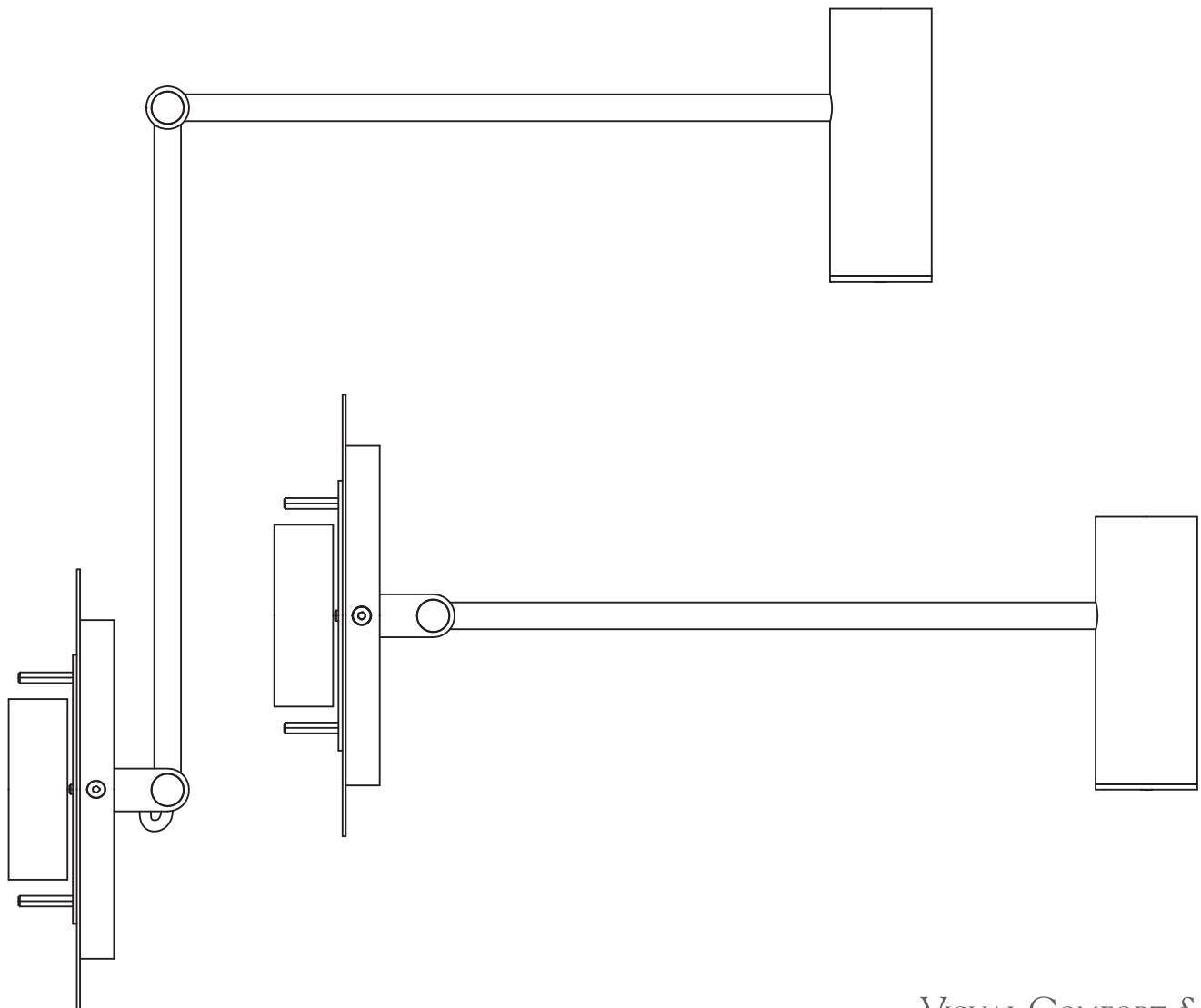

Install the Fixture

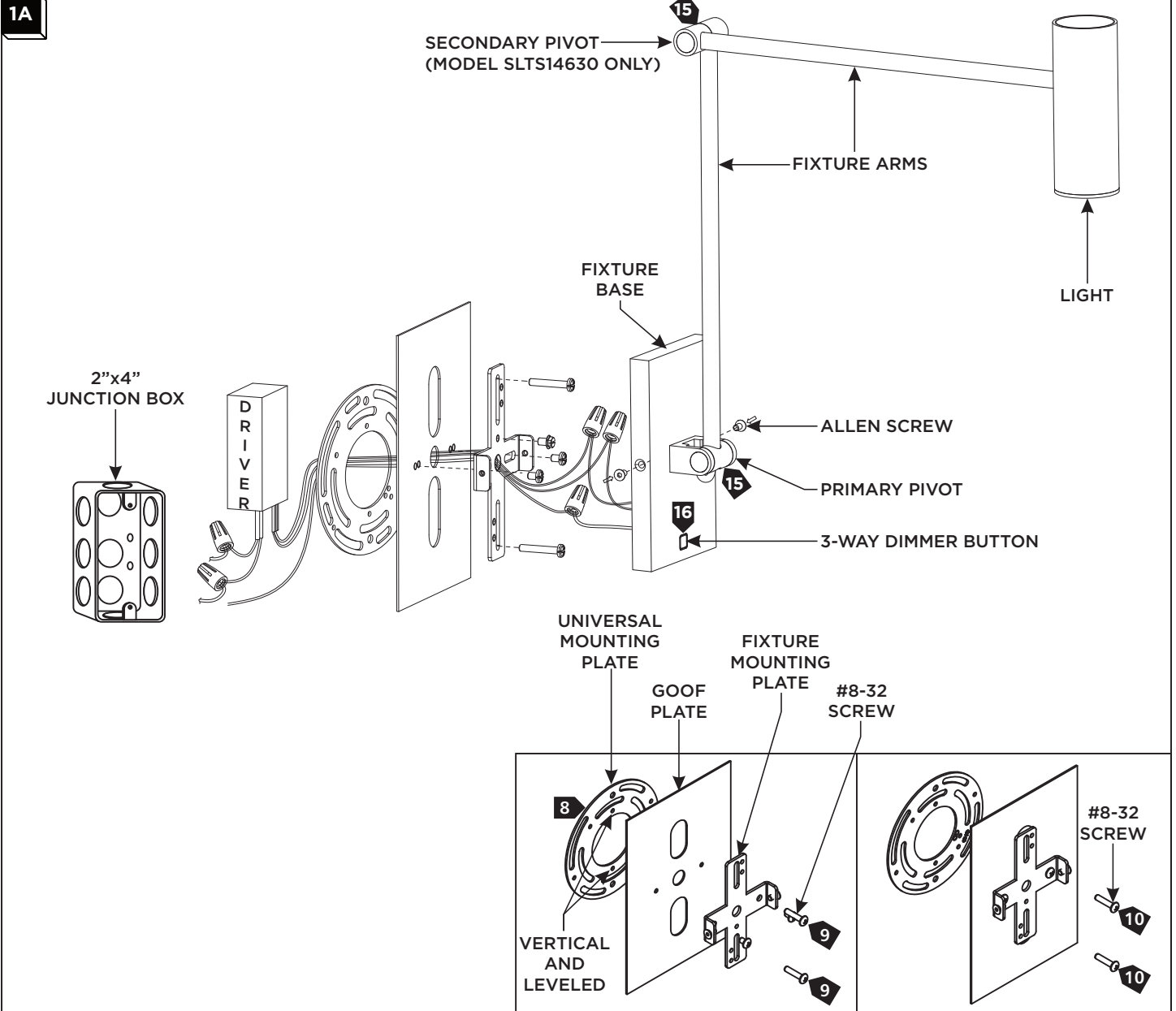

- 1 With the provided Allen wrench, remove the Allen screws on the fixture base.
- 2 Remove the mounting plate from the fixture base.
- 3 Connect the fixture to a suitable ground in accordance with local electrical codes.
- 4 Connect the white driver wire to the neutral power line with a wire nut.
- 5 Connect the black driver wire to the hot power line with a wire nut.
- 6 Place the driver into the junction box.
- 7 For a 2"x4" junction box, install the fixture mounting plate with the two 6-32x.75" pan head screws and skip to step 11.
- 8 For junction boxes larger than 2"x4", feed the driver output wires through the center hole of the round universal mounting plate and secure it to the junction box ensuring that the threaded holes are positioned vertically and leveled.
- 9 Install the fixture mounting plate to the goof plate using the two 8-32x.25" pan head screws.
- 10 Feed the driver output wires through the center of the fixture mounting plate/goof plate assembly and secure it to the universal mounting plate using the two 8-32x.75" pan head screws.
- 11 Connect the black/blue driver wire to the black/blue fixture wire with a wire nut.
- 12 Connect the red driver wire to the red fixture wire with a wire nut.
- 13 Properly place the wires and wire nut connections into the junction box/fixture base and install the mounting plate to the junction box with the two #6-32 screws provided. **NOTE:** Must use approximate 2"x4" junction box or goof plate to completely cover the junction box.
- 14 Properly place the wires and wire nut connections into the junction box/fixture base, mount the fixture base onto the fixture mounting plate, and secure it in place by reinstalling the Allen screws using the provided Allen wrench.
- 15 **Adjust the Arms:** Use the primary and secondary pivots to adjust the light in the desired direction. Do not exceed the range of motion for either pivot. **NOTE:** Only Model SLTS14630 includes a secondary pivot.
- 16 **Dimming:** Use button on the fixture base to cycle through dimming levels.