

INSTALLATION INSTRUCTION

Mini LED Multiple Spots - New Construction

MT-3LD111NA-F30/MT-3LD211NA-F30/MT-3LD311NA-F30

WAC LIGHTING

Responsible Lighting®

SAFETY INSTRUCTION

IMPORTANT: NEVER attempt any work without shutting off the electricity.

1. Read all of these instructions before installing the track system.
2. System is intended for installation by a qualified electrician in accordance with the National Electrical Code and local regulations.
3. Go to the main fuse box, or circuit breaker. Place the main power switch in the "OFF" position and unscrew the fuse(s) or switch "OFF" the circuit breaker switch(es) that control the power to the fixture or room that you are working on.
4. Place the wall switch in the "OFF" position.

INSTRUCTIONS DE SÉCURITÉ IMPORTANTES

1. Lisez toutes les instructions avant d'installer.
2. Système est destiné à être installé par un électricien qualifié en conformité avec le code national de l'électricité et les règlements locaux.
3. Accédez au panneau central de disjoncteurs ou de fusibles de votre demeure et placez l'interrupteur principal en position d'arrêt («OFF»).
4. Placez l'interrupteur mural en position d'arrêt (« OFF »).

NEW CONSTRUCTION HOUSING MOUNTING:

1. Install mounting frame using two hanger bars, (24 1/2" max). Bars are notched on the ends to fit over "T" bars in suspended ceilings. Hanger bars include a captive mounting "screw-nail" for ease of installation (as Fig.1). Align the bottom of the hanger bar with the bottom of the wood joist. Secure the "screw-nail" on each end by screwdriver (as Fig.A), or by hammer (as Fig.B). Use locking screws to secure (as Fig.C).
2. Slide fixture along bar hangers into desired location.
3. Junction box is suitable for branch wiring and has trade size knockouts and integral non-metallic sheathed cable connectors.
4. Remove spring latched junction box door and connect fixture wires to building wires: insert each supply wire into appropriate junction box connector. Connect black fixture wire to hot wire, white fixture wire to neutral wire and green fixture wire to ground (as Fig.2).
5. Place all wiring and connectors back in wiring box and replace junction box door.
6. When installing in drywall, cut a hole 4 1/8" X 4 1/8" in the drywall. Note: 3/4" inch maximum ceiling thickness.
7. Push the trim assembly up until the trim ring is flush to the ceiling (as Fig.3, Fig.4 and Fig.5).

USE TEMPLATE SUPPLIED TO MAKE APPROPRIATE CUTOUT.

Model	Cutout
MT-3LD111NA-F30	4 1/8" x 4 1/8"
MT-3LD211NA-F30	8 1/4 x 4 1/8"
MT-3LD311NA-F30	12 3/16" x 4 1/8"

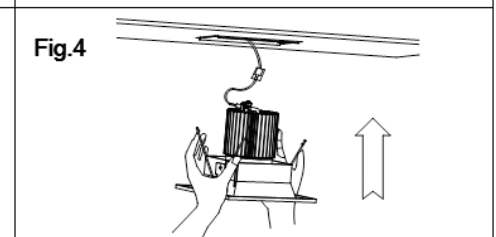
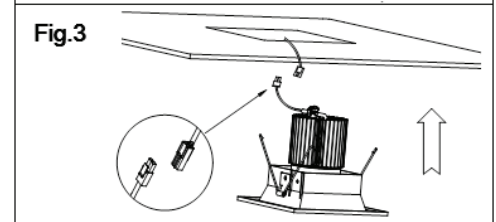
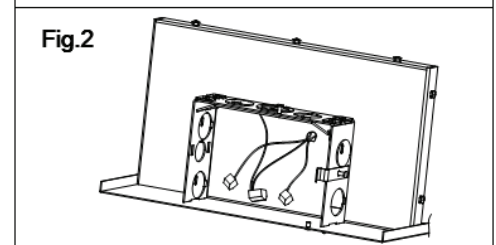
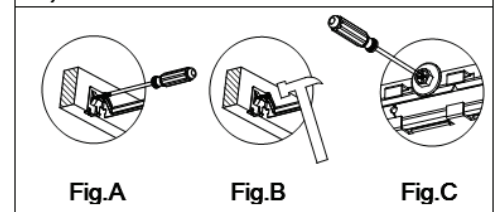
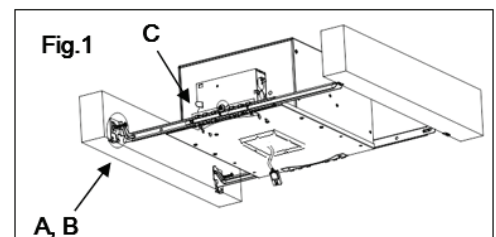
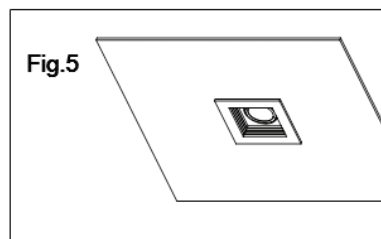

WAC Lighting

www.waclighting.com

Phone (800) 526.2588 • Fax (800) 526.2585

Headquarters/Eastern Distribution Center

44 Harbor Park Drive • Port Washington, NY 11050

Phone (516) 515.5000 • Fax (516) 515.5050

Western Distribution Center

1750 Archibald Ave • Ontario, CA 91761

Phone (800) 526.2588 • Fax (800) 526.2585

INSTALLATION INSTRUCTION
Mini LED Multiple Spots - Remodel
 MT-3LD111R-F30/MT-3LD211R-F30/MT-3LD311R-F30

SAFETY INSTRUCTION

IMPORTANT: NEVER attempt any work without shutting off the electricity.

1. Read all of these instructions before installing the track system.
2. System is intended for installation by a qualified electrician in accordance with the National Electrical Code and local regulations.
3. Go to the main fuse box, or circuit breaker. Place the main power switch in the "OFF" position and unscrew the fuse(s) or switch "OFF" the circuit breaker switch(es) that control the power to the fixture or room that you are working on.
4. Place the wall switch in the "OFF" position.

INSTRUCTIONS DE SÉCURITÉ IMPORTANTES

1. Lisez toutes les instructions avant d'installer.
2. Système est destiné à être installé par un électricien qualifié en conformité avec le code national de l'électricité et les règlements locaux.
3. Accédez au panneau central de disjoncteurs ou de fusibles de votre demeure et placez l'interrupteur principal en position d'arrêt («OFF»).
4. Placez l'interrupteur mural en position d'arrêt (« OFF »).

REMODEL HOUSING MOUNTING:

1. Cut out a hole in the existing ceiling (as Fig.1).
2. Pull ceiling wire through the hole (as Fig.2).
3. Junction box is suitable for chain wiring of multiple fixtures and is supplied with a slide latch door, and two trade size knockouts connectors.
4. Remove junction box door and connect fixture wires to building wires: insert each supply wire into appropriate junction box connector. Connect black fixture wire to hot wire, white fixture wire to neutral wire and green fixture wire to ground (as Fig.3 and Fig.4).
5. Place all wiring and connectors back in wiring box and replace junction box door.
6. Push the housing up through the hole (as Fig.5).
7. Push clips to secure the fixture. Note: 1 inch maximum ceiling thickness (as Fig.6).
8. Push the trim assembly up until the trim ring is flush to the ceiling (as Fig.7, Fig.8, Fig.9 and Fig.10).

USE TEMPLATE SUPPLIED TO MAKE APPROPRIATE CUTOUT.

Model	Cutout
MT-3LD111R-F30	4 1/8" x 4 1/8"
MT-3LD211R-F30	8 1/4 x 4 1/8"
MT-3LD311R-F30	12 3/16" x 4 1/8"

