

LED Wall Mounts

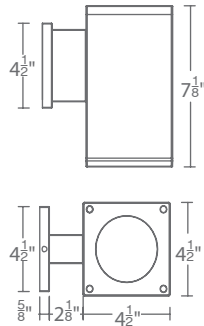

Fixture Type:

Catalog Number:

Project:

Location:

PRODUCT DESCRIPTION

The latest energy efficient LED technology in an appealing cubical profile delivers accent and wall wash lighting. Comes in various light distribution and beam angle options.

FEATURES

- High performance exterior rated LED wall mount light
- Fixture can install upside down to alter light distribution
- Solid aluminum construction
- 5 year warranty

ORDERING NUMBER

SPECIFICATIONS

Input:	Universal voltage 120V - 277VAC, 50/60Hz
Dimming:	Electronic low voltage (ELV) : 100% - 5% 0-10V: 100% - 1%
Light Source:	High output 3 Step Mac Adam Ellipse COB Rated life of 60,000 hours at L70
Finish:	Electrostatically powder coated, white, black, bronze and graphite
Standards:	IP65 rated, UL & cUL wet location listed, Energy Star® 2.2 rated Title 24 JA8-2016 Compliant
Operating Temp:	-13°F to 122°F (-25°C to 50°C)

Diameter	Watt	Beam	Beam Angle	Color Temp	CRI	Reference Output ¹ Lumen	CBCP	Efficacy (lm/w)	Light Distribution	Finish					
DC-WS05	5"	25W	S Straight up or down	16°	927S	2700K	90	1825	10050	73		BK Black WT White BZ Bronze GH Graphite			
					827S	2700K	85	2190	12057	88					
					930S	3000K	90	1895	10427	76					
					830S	3000K	85	2300	12644	92					
					835S	3500K	85	2350	12937	94					
			840S	4000K	85	2375	13062	95							
			N Straight up or down	25°	927S	2700K	90	1810	5280	72					
					827S	2700K	85	2170	6335	87					
					930S	3000K	90	1880	5478	75					
					830S	3000K	85	2275	6643	91					
					835S	3500K	85	2330	6797	93					
			840S	4000K	85	2350	6863	94							
			DC-WS0517	5"	17W	F Straight up or down	33°	927S	2700K	90	1900		4515	76	
								827S	2700K	85	2280		5417	91	
								930S	3000K	90	1970		4685	79	
830S	3000K	85						2390	5681	96					
835S	3500K	85						2445	5812	98					
840S	4000K	85	2470	5870	99										
F Away from the wall	N/A	927A	2700K	90	2000		80								
		827A	2700K	85	2400		96								
		930A	3000K	90	2075	N/A	83								
		830A	3000K	85	2520	N/A	101								
		835A	3500K	85	2575		103								
840A	4000K	85	2600		104										
F Towards the wall	N/A	927B	2700K	90	2000		80								
		827B	2700K	85	2400		96								
		930B	3000K	90	2075	N/A	83								
		830B	3000K	85	2520	N/A	101								
		835B	3500K	85	2575		103								
840B	4000K	85	2600		104										

DC-WS05- _____ - _____ ¹Reference output shows 25W output. Multiply by 0.7 to determine output for 17W combinations.

Example: **DC-WS05-F930A-WT**

wacighting.com
Phone (800) 526.2588
Fax (800) 526.2585

Headquarters/Eastern Distribution Center
44 Harbor Park Drive
Port Washington, NY 11050

Central Distribution Center
1600 Distribution Ct
Lithia Springs, GA 30122

Western Distribution Center
1750 Archibald Avenue
Ontario, CA 91760

LED Wall Mounts

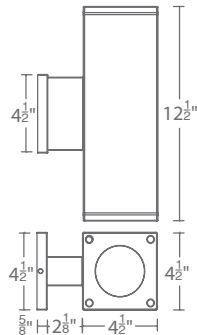

Fixture Type:

Catalog Number:

Project:

Location:

PRODUCT DESCRIPTION

The latest energy efficient LED technology in an appealing cubical profile delivers accent and wall wash lighting. Comes in various light distribution and beam angle options.

FEATURES

- Single light extended body high performance exterior rated LED wall mount
- Fixture can install upside down to alter light distribution
- Solid aluminum construction
- 5 year warranty

SPECIFICATIONS

Input: Universal voltage 120V - 277VAC, 50/60Hz
Dimming: Electronic low voltage (ELV) : 100% - 5%
 0-10V: 100% - 1%
Light Source: High output 3 Step Mac Adam Ellipse COB
 Rated life of 60,000 hours at L70
Finish: Electrostatically powder coated, white, black, bronze and graphite
Standards: IP65 rated, UL & cUL wet location listed, Energy Star® 2.2 rated Title 24 JA8-2016 Compliant
Operating Temp: -13°F to 122°F (-25°C to 50°C)

ORDERING NUMBER

Diameter	Watt	Beam	Beam Angle	Color Temp	CRI	Reference Output ¹ Lumen	Reference Output ¹ CBCP	Efficacy (lm/w)	Light Distribution	Finish			
DC-WE05	5"	S Straight up or down	16°	927S	2700K	90	1825	10050	73		BK Black WT White BZ Bronze GH Graphite		
				827S	2700K	85	2190	12057	88				
				930S	3000K	90	1895	10427	76				
				830S	3000K	85	2300	12644	92				
				835S	3500K	85	2350	12937	94				
		840S	4000K	85	2375	13062	95						
		N Straight up or down	25°	927S	2700K	90	1810	5280	72				
				827S	2700K	85	2170	6335	87				
				930S	3000K	90	1880	5478	75				
				830S	3000K	85	2275	6643	91				
				835S	3500K	85	2330	6797	93				
		840S	4000K	85	2350	6863	94						
		DC-WE0517	5"	F Straight up or down	33°	927S	2700K	90	1900	4515		76	
						827S	2700K	85	2280	5417		91	
						930S	3000K	90	1970	4685		79	
830S	3000K					85	2390	5681	96				
835S	3500K					85	2445	5812	98				
840S	4000K	85	2470	5870	99								
F Away from the wall	N/A	927A	2700K	90	2000		80						
		827A	2700K	85	2400		96						
		930A	3000K	90	2075	N/A	83						
		830A	3000K	85	2520	N/A	101						
		835A	3500K	85	2575		103						
840A	4000K	85	2600		104								
F Towards the wall	N/A	927B	2700K	90	2000		80						
		827B	2700K	85	2400		96						
		930B	3000K	90	2075	N/A	83						
		830B	3000K	85	2520	N/A	101						
		835B	3500K	85	2575		103						
840B	4000K	85	2600		104								

DC-WE05- _____ - _____ ¹Reference output shows 25W output. Multiply by 0.7 to determine output for 17W combinations.

Example: DC-WE05-F930A-WT

wacighting.com
 Phone (800) 526.2588
 Fax (800) 526.2585

Headquarters/Eastern Distribution Center
 44 Harbor Park Drive
 Port Washington, NY 11050

Central Distribution Center
 1600 Distribution Ct
 Lithia Springs, GA 30122

Western Distribution Center
 1750 Archibald Avenue
 Ontario, CA 91760