

Date: \_\_\_\_\_ Project: \_\_\_\_\_

Fixture Type: \_\_\_\_\_ Specifier/Rep: \_\_\_\_\_

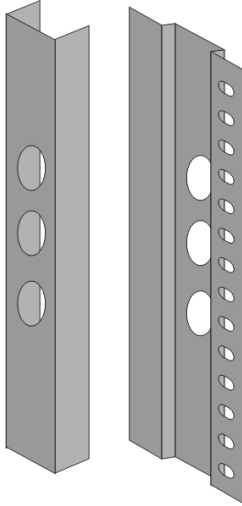

### Assembly instructions for outer casing masonry wall

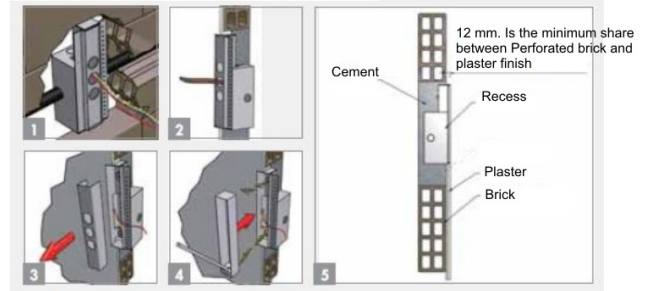

Available for **International** specifications by adding **'INT'** at the end of the existing Model # International spec sheets are available upon request

Exact Measurements: Metric

**Model:** D4-9013

### Additional Details

Used for outer casing Masonry

## Components for use with....

- Spillo - Recessed - 1Rod - [D4-6007WHI] -- 52.6cm / 20 11/16" - 6.60W LED - 3000K - White
- Spillo - Recessed - 1Rod - [D4-6007CHR] -- 52.6cm / 20 11/16" - 6.60W LED - 3000K - Chrome
- Spillo - Recessed - 1Rod - [D4-6007BLA] -- 52.6cm / 20 11/16" - 6.60W LED - 3000K - Black