

Lightology

lightology.com
866-954-4489
02-10-26

Project: _____
Company: _____
Location: _____ Fixture Type: _____
SPEC #: **MT01026421**
Approved On: _____ Approved By: _____

Blaze Wall Sconce By Matteo Lighting



Description

The Blaze Wall Sconce adds both form and function to your interior space. The smooth metal shade casts warm shadows across your room and can be directed where you need light. Available with a Single straight arm or Double adjustable arm.



Shown in aged gold brass / black

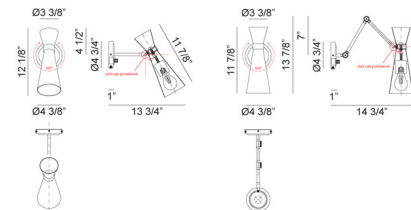

Specifications

COLOR Black
BODY FINISH Aged Gold Brass
WATTAGE 60W
DIMMER Standard 120V
DIMENSIONS 4.75"W x 12.125"H x 13.75"D
BULB NOT INCLUDED 1 x A19/Medium (E26)/60W/120V Incandescent



CLICK TO VIEW PRODUCT

Notes: