

Lightology

lightology.com
866-954-4489
07-18-25

Project: _____
Company: _____
Location: _____ Fixture Type: _____
SPEC #: **HMR1073094**
Approved On: _____ Approved By: _____

Axis Double Wall Sconce

By Hammerton Studio



Description

The Axis Double Wall Sconce is an eye catching use of recycled glass to create functional art. Is it ice or diamonds, you decide. Pairing hand polished metalwork with thick artisan cast glass and excess materials from glassblowing creates the unique characteristics of this luxury light that will dramatically refract light in surprising ways. May be mounted horizontally or vertically. Available with 2700K or 3000K color temperature options.

Specifications

COLOR Clear Cast Glass
BODY FINISH Flat Bronze
WATTAGE 12W
DIMMER Low Voltage Electronic
DIMENSIONS 5.5"W x 26"H x 3.5"D
INTEGRATED LED MODULE 2 x LED/6W/120V LED

Technical Information

COLOR RENDERING 93 CRI
LAMP COLOR 2700K
LUMENS/WATT 77.67
LUMINOUS FLUX 466 lumens



Shown in flat bronze / clear cast glass

All dimensions are shown in inches unless otherwise stated.

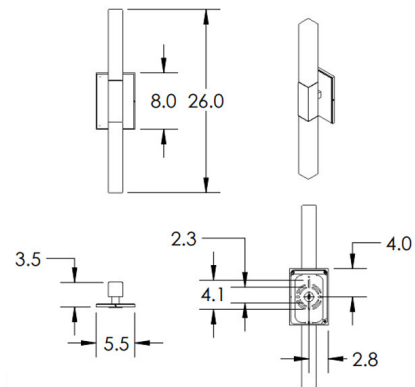

Mounting Method: J-Box Wall Mount



CLICK TO VIEW PRODUCT

Notes: