



**BRAND**

Hammerton Studio

**DESCRIPTION**

The Gem Double Wall Sconce is jewelry for your home. Features gems of LED lit hand blown glass that are meticulously crafted by Hammerton artisans. The fixture gives a nod to an organic aesthetic that exudes casual sophistication. Each shade takes the place of a traditional bulb and unfolds with striking illumination. The finished look is relaxed, soft and unique. Each glass shade is a one-of-a-kind artisan creation. Available with 2700K or 3000K color temperature options.



Shown in: Satin Nickel / Clear

<b>SHADE COLOR</b>	Clear
<b>BODY FINISH</b>	Satin Nickel
<b>WATTAGE</b>	12W
<b>DIMMER</b>	Low Voltage Electronic
<b>DIMENSIONS</b>	6.5"W x 21.1"H x 7.7"D
<b>LAMP</b>	2 x LED/6W/120V LED

*Technical Information*

<b>LUMINOUS FLUX</b>	466 lumens
<b>LUMENS/WATT</b>	77.67
<b>LAMP COLOR</b>	3000 K
<b>COLOR RENDERING</b>	93 CRI

ITEM NUMBER

HMR1073281

All dimensions are shown in inches unless otherwise stated.

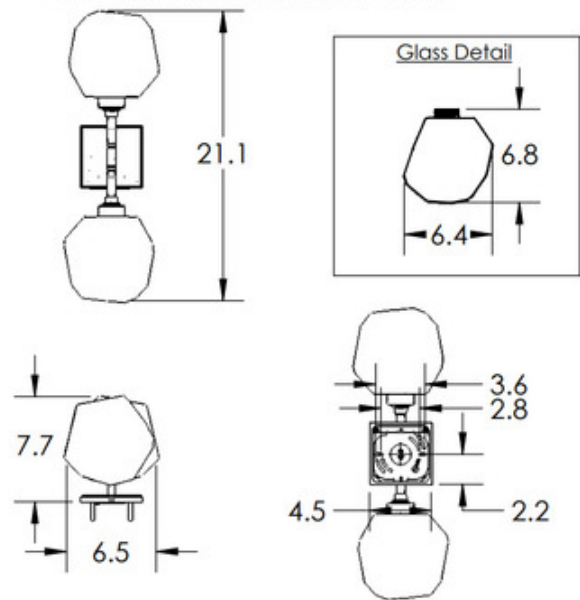

Mounting Method: J-Box Wall Mount

COMPANY	PROJECT	FIXTURE TYPE	APPROVED BY	DATE