

Lightology

lightology.com
866-954-4489
04-22-26

Project: _____

Company: _____

Location: _____ Fixture Type: _____

SPEC #: **TOY1140650**

Approved On: _____ Approved By: _____

Nastro Outdoor Wall Sconce

By Tooy



Description

The Nastro Outdoor Wall Sconce features an aluminum band bent around a cylinder to create a modern, geometric fixture. The integrated LED strip allows the sconce to maintain its simple, minimalist structure. Installable upside down. The Color choice is for the structure and the Finish choice is for the cylindrical weight. Phase cut dimming. Backplate for standard US junction box is included. Note: Note: Includes a remote driver which must be placed in an accessible location (remote driver dimensions: 6.3L x 1.8W x .8H).

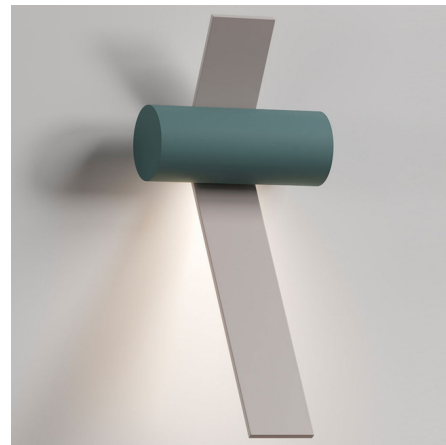

Shown in greenish-grey cylinder / beige

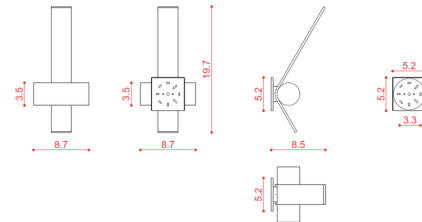

Specifications

COLOR Beige
BODY FINISH Greenish-Grey Cylinder
WATTAGE 11W
DIMMER Low Voltage Electronic
DIMENSIONS 8.7"W x 19.7"H x 8.5"D
INTEGRATED LED MODULE 1 x LED/11W/120V LED

Technical Information

PRODUCT DIMENSIONS Remote Driver Dimensions: 6.3"W x 1.7"D x 0.78"H
LAMP COLOR 2700K
LUMENS/WATT 131.91
LUMINOUS FLUX 1451 lumens



CLICK TO VIEW PRODUCT

Notes: