

Lightology

lightology.com
866-954-4489
04-22-26

Project: _____
Company: _____
Location: _____ Fixture Type: _____
SPEC #: **EUF1287566**
Approved On: _____ Approved By: _____

Tri-Fold Gen2 Color-Select LED Mirror By Eurofase



Description

The Tri-Fold Gen2 LED Mirror offers a sleek design, featuring a pair of back lit LED strips placed in the center mirror and a tri-fold option for optimized viewing angles. A touch sensor switch is used to turn the light on and off and to choose the color temperature--6400K, 4500K, or 3000K. Pressing and holding the switch dims the lumens.

Specifications

COLOR	N/A
BODY FINISH	Chrome
WATTAGE	30W
DIMMER	Included
DIMENSIONS	43.5"W x 65"H x 1.5"D
INTEGRATED LED MODULE	1 x LED/30W/120V LED
COUNTRY OF ORIGIN	China

Technical Information

COLOR RENDERING	90 CRI
LAMP COLOR	CCT Select
LUMENS/WATT	90.00
LUMINOUS FLUX	2700 lumens



Shown in chrome

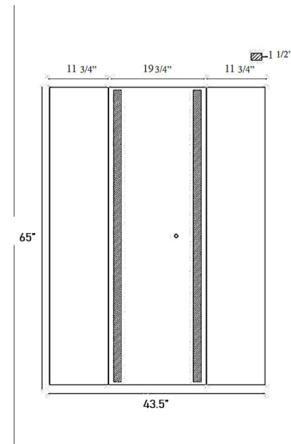

CLICK TO VIEW PRODUCT

Notes: