

# Lightology

lightology.com  
866-954-4489  
01-12-26

Project: \_\_\_\_\_  
Company: \_\_\_\_\_  
Location: \_\_\_\_\_ Fixture Type: \_\_\_\_\_  
SPEC #: **BOM1396423**  
Approved On: \_\_\_\_\_ Approved By: \_\_\_\_\_

## Fragments Wall Sconce

By Bomma



### Description

The Fragments Wall Sconce is crafted from a material called Fragmentglass, composed of glass shards which have been melted down in a mold and meticulously hand-cut into gem-like shapes. The shards come from glass pieces that have been rejected by Bomma's rigorous quality control as a way to reuse the wasted material. While imperfections from bubbles or trace elements such as iron are undesirable in some pieces, the Fragments Wall Sconce intentionally showcases their unique variations as a dazzling visual texture. While the ratios of colored glass are carefully controlled, each sconce takes on a one-of-a-kind look due to the unpredictability of the melting process.

### Specifications

COLOR . . . . . White Fragmentglass  
BODY FINISH . . . . . Brushed Gold  
WATTAGE . . . . . 12W  
DIMMER . . . . . Low Voltage Electronic  
DIMENSIONS . . . . . 5.7"W x 15.6"H x 6.5"D  
BULB INCLUDED . . . . . 1 x LED/G4 (bipin)/12W/12V LED

### Technical Information

COLOR RENDERING . . . . . 90 CRI  
LAMP COLOR . . . . . 2700K  
LUMENS/WATT . . . . . 83.33  
LUMINOUS FLUX . . . . . 100 lumens



Shown in brushed gold / white fragmentglass

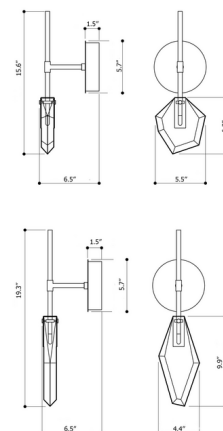

CLICK TO VIEW PRODUCT

Notes: