

# Lightology

lightology.com  
866-954-4489  
08-31-25

Project: \_\_\_\_\_  
Company: \_\_\_\_\_  
Location: \_\_\_\_\_ Fixture Type: \_\_\_\_\_  
SPEC #: **WAC1416585**  
Approved On: \_\_\_\_\_ Approved By: \_\_\_\_\_

## FQ 2 inch 25W With Trim New Construction Non-IC Frame-In Kit By WAC Lighting



### Description

The FQ 2 Inch 25 Watt Non-IC Rated New Construction Frame-In Kit is designed for with trim round or square trims. Universal 120/277 with Electronic Low Voltage (ELV): 100%-1%, TRIAC: 100%-1%, or 0-10V: 100%-1%. Emergency (EM) fixtures provided with integral emergency battery back up with 24 inch lead wire remote test switch. Provides at least 90 minutes of 6W illumination during emergency operation. Ceiling cutout (Round and Square): 3.5 inch. Ceiling thickness: 1/2 to 1 inch. NOTE: A complete fixture requires a housing and trim (round or square), sold separately. See trim for lumens.



Shown in galvanized steel

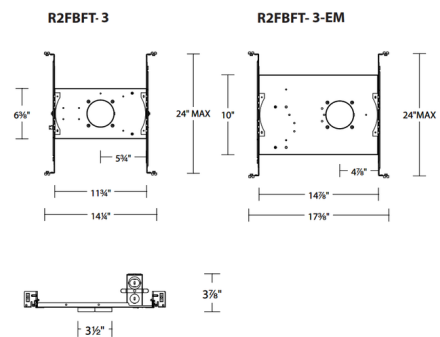

### Specifications

COLOR . . . . . N/A  
BODY FINISH . . . . . Galvanized Steel  
WATTAGE . . . . . 25W  
DIMMER . . . . . Low Voltage Electronic  
DIMENSIONS . . . . . 14.25"W x 3.87"H x 6.38"D  
INTEGRATED LED MODULE . . . . . LED/25W/120-277V LED

### Technical Information

HOUSING HEIGHT . . . . . 4"  
HOUSING TYPE . . . . . New Construction NON IC  
CEILING TYPE . . . . . Drywall with Trim



CLICK TO VIEW PRODUCT

Notes: