

Lightology

lightology.com
866-954-4489
10-10-25

Project: _____
Company: _____
Location: _____ Fixture Type: _____
SPEC #: **EDG1443830**
Approved On: _____ Approved By: _____

Reveal Cove/Pathway TruColor RGBTW Plaster-In LED System 24V

By PureEdge Lighting



Description

Reveal TruColor RGBTW (RGB + Tunable White) Cove/Pathway, a 24VDC linear made to order LED system, features a shallow plaster-in extrusion that recesses into 5/8 inch drywall. This innovative system blends seamlessly into the drywall, accenting architecture and serves as a practical wayfinding application. Pure Smart TruColor technology uses five channels of tunable LEDs, composed of RGBTW red, blue, green, and Tunable White (1500K-6500K). Reveal is sold in 12 inch increments and may be field cut to any length. Available Options: 5 Watt: 5 Watts RGB + 5 Watts Tunable White (up to 20 feet) 7 Watt: 5 Watts RGB + 7 Watts Tunable White (up to 12 feet) 10 Watt: 5 Watts RGB + 10 Watts Tunable White (up to 10 feet) System includes: Junction Box with Adjustable Mounting Bars, Pure Smart/Wiz Pro CV Bridgebox, Reveal Channel(s), Power Feed End Cap, Junction Box Cover, Dead End Cap, Take-Up Box, Drywall Screws, and LED Soft Strip. Order PSBR Remote Power Supply separately. The Reveal Cove/Path with TruColor RGBTW light engine requires Pure Smart controls for operation.

Specifications

COLOR	N/A
BODY FINISH	White
WATTAGE	5W
DIMMER	N/A
DIMENSIONS	12"L x 4.38"W x 0.75"H
INTEGRATED LED MODULE	1 x LED/5W/24V LED

Technical Information

LAMP LIFE	50000 hours
COLOR RENDERING	93 CRI
LAMP COLOR	RGB+White
LUMENS/WATT	34.00
LUMINOUS FLUX	170 lumens

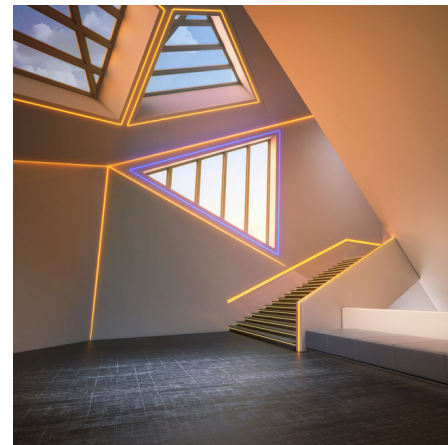

Shown in white

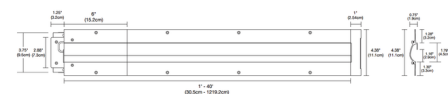

INCLUDED COMPONENTS

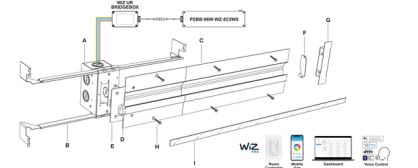

- A. JUNCTION BOX**
Mounts behind drywall with Adjustable Mounting Bars, and includes a channel for the Power Feed End Cap. Low Voltage 24VDC wires from the LED Soft Strip connect to LED wires inside box. Junction Box opening is concealed with the Junction Box Cover and is required at the beginning of each run.
- B. ADJUSTABLE MOUNTING BARS**
Provide flexibility for mounting in a variety of spaces.
- C. REVEAL CHANNEL**
5/8" deep extrusion houses a single row of RGBTW TruColor™ Dynamic Color Changing LED Soft Strip.
- D. POWER FEED END CAP**
Provides a connection area for 24VDC wires at beginning of run where LED Soft Strip enters channel.
- E. JUNCTION BOX COVER**
Connects Junction Box opening. Required at the beginning of each run.
- F. DEAD END CAP PLATE**
Provides a finished look and prevents light leak at end of run where LED Soft Strip ends channel.
- G. TAKE-UP BOX**
Prevents dark spots at end of run by tucking excess LED Soft Strip safely behind wall.
- H. DRYWALL SCREWS**
Secure channel to drywall and stud.
- I. LED SOFT STRIP**
Black Strip shows commercial grade RGBTW TruColor™ Dynamic Color Changing LED Soft Strip. See lamp data on for additional details.



CLICK TO VIEW PRODUCT

Notes: