

Lightology

lightology.com
866-954-4489
04-25-26

Project: _____
 Company: _____
 Location: _____ Fixture Type: _____
 SPEC #: **EDG1486560**
 Approved On: _____ Approved By: _____

Verge Corner RGB/RGBW Drywall Plaster-In System 24V

By PureEdge Lighting



Description

Verge Corner RGB/RGBW is another innovative design from the family of 24VDC plaster-in systems. Verge Corner recesses within 5/8 inch or thicker drywall and mounts directly to studs and joists without modification. The slim plaster-in aluminum channel has a 4 inch paintable backer plate creating visually interesting and dramatic illumination by highlighting the inside corners of two drywall surfaces such as ceiling, coves, and skylights. Verge Corner is available in 1 foot increments (sold in 5 foot increments) in RGB (Red-Green-Blue) in 10 watts (2X5W) per foot up to 20 feet, and RGBW (Red-Green-Blue+2000K White) is available in 12 watts (2X6.3W) per foot up to 16 feet. May be field cut to any length. A remote DMX power supply, controller, and optional accessories are sold separately. Included Components: (2) Junction Boxes, Adjustable Mounting Bars, (2) Backer Plates, (2) Verge Corner Channels, Drywall Screws, (2) LED Strips, and (2) Lenses.

Specifications

COLOR	N/A
BODY FINISH	White
WATTAGE	.50W
DIMMER	N/A
DIMENSIONS	60"L x 4"W x 4"H x 0.75"D
INTEGRATED LED MODULE	5 x LED/10W/24V LED

Technical Information

LAMP LIFE	50000 hours
LAMP COLOR	RGB

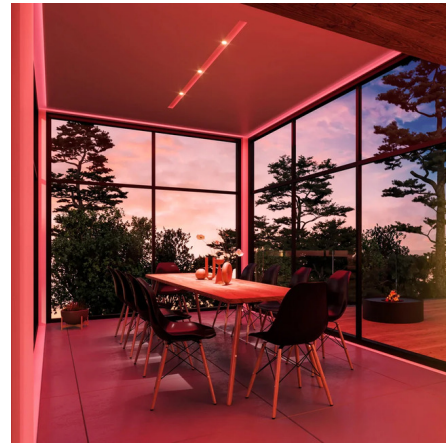

Shown in white

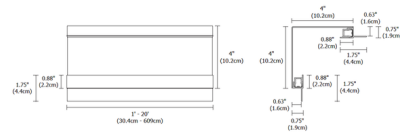

MAXIMUM LENGTHS BEFORE RE-FEEDING:
 • 10 watts per foot - 20' (2 x 5WDC) RGB Only
 • 12 watts per foot - 16' (2 x 6.3WDC) RGBW Only

INCLUDED COMPONENTS

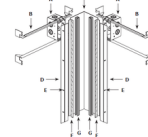

- A. JUNCTION BOX**
Mounts to wall with adjustable mounting bars. Low Voltage 24VDC. Screws from Backer Plate (single screws) to the sides must be used. Junction Box opening is covered by the Backer Plate, and required at the beginning of each run.
- B. ADJUSTABLE MOUNTING BARS**
Provide flexibility for mounting in a variety of spaces. Verge Corner includes two sets of mounting hardware.
- C. BACKER PLATE**
4" paintable aluminum plate conceal junction box and reflect light.
- D. VERGE CHANNEL**
Slim 1/2" deep extrusion each houses a single row of LED Strip.
- E. DRYWALL SCREWS**
Screw channels to drywall and studs.
- F. LED STRIP**
Commercial grade White or Dynamic Color Changing LED Strip. See lamp data for additional details.
- G. LENS**
1/2" wide diffused (White lens projects a clean line of light without glare). Verge Corner includes two lenses.



CLICK TO VIEW PRODUCT

Notes: