

Lightology

lightology.com
866-954-4489
04-25-26

Project: _____

Company: _____

Location: _____ Fixture Type: _____

SPEC #: **STM1543881**

Approved On: _____ Approved By: _____

Dreamer Vertical Pendant

By Studio M



Description

Drawing inspiration from her acclaimed Dreamcloud experiential design at Art Basel Miami, Nina Magon reinterprets her otherworldly installation for use in the home or hospitality project. The Dreamer Vertical Pendant suspends bubble-like glass forms that appear to float across a channel of LED illumination. Use as a solo standout or hang in clusters for dramatic effect.



Shown in black chrome / mirror smoke

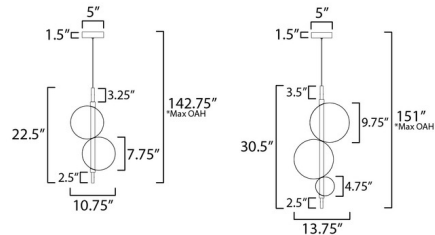

Specifications

COLOR Mirror Smoke
 BODY FINISH Black Chrome
 WATTAGE 9W
 DIMMER 0-10V
 DIMENSIONS 32.5"L x 13.75"W x 30.5"H
 INTEGRATED LED MODULE 1 x LED/9W/120V LED

Technical Information

COLOR RENDERING 90 CRI
 LAMP COLOR 3000K
 LUMENS/WATT 36.67
 LUMINOUS FLUX 330 lumens



CLICK TO VIEW PRODUCT

Notes: