



**BRAND**

Juno Lighting

**DESCRIPTION**

R702 Round Back MR16 low voltage track fixture features a 90 degree vertical aiming capability and 358 degree rotation. Copper alloy contacts provide precise spring action. True, positive electrical ground. 50W 12V electronic transformer with circuit protection included. Patented embossed polarity arrows on bottom of adapter. Spring-loaded locking latch with embossed polarity arrows secures fixture to the track. Pull-up contact to up position for use on two-circuit track. Finish available in Black. One 50 watt, 12 volt MR16 halogen bulb or LED equivalent is required, but not included. Halogen dimmable with a low voltage electronic dimmer. Consult bulb manufacturer for dimmer compatibility when using LED equivalent. 2.5 inch diameter x 3.75 inch height x 5.5 inch length. UL listed. Compatible with Juno Lighting Trac-Lites 1-circuit and Trac-Master 1-circuit and 2-circuit 120 volt line voltage track systems.



<b>SHADE COLOR</b>	N/A
<b>BODY FINISH</b>	Black
<b>WATTAGE</b>	50W
<b>DIMMER</b>	Low Voltage Electronic
<b>DIMENSIONS</b>	5.5"L x 2.5"W x 3.75"H
<b>BULB NOT INCLUDED</b>	
<b>LAMP</b>	1 x MR16/GU5.3 (bipin)/50W/12V Halogen 1 x MR16/GU5.3 (bipin)/12V LED

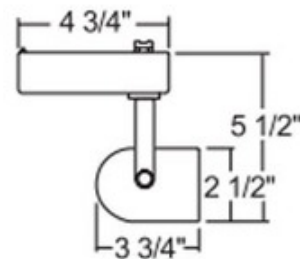

**SPEC #**

JUN25983

COMPANY

PROJECT

FIXTURE TYPE

APPROVED BY

DATE