

Lightology

lightology.com
866-954-4489
07-07-25

Project: _____
Company: _____
Location: _____ Fixture Type: _____
SPEC #: **HUZ38387**
Approved On: _____ Approved By: _____

12V Step Lite Round Eyelid Halogen Step Light By Hunza Lighting



Description

The Step Lite Solid Eyelid Outdoor Light is designed with a 3.5 inch flange and recessed body for flush mounting into canister for concrete masonry, stone or wood, providing illumination of steps and low level features such as exterior paved areas. When used with Hunza mounting canister there are no mounting holes in the flange. The eyelid feature eliminates all upward light, providing an excellent glare-free illuminating effect. Machined from thick aluminum in powder coat finish Bronze or Black, solid Copper, or 316 Stainless Steel with a clear tempered stepped glass lens. UL listed. IP67 rated for wet locations. Required mounting canister (DKcan for wood or SLcan for concrete or stone) and low voltage transformer, sold separately. Dimmer type dependent on type of transformer/ power supply selected (low voltage electronic or low voltage magnetic).



Shown in copper

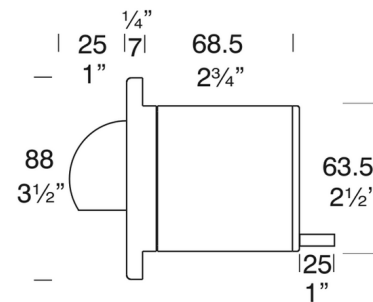

Specifications

COLOR N/A
BODY FINISH Black
WATTAGE 20W
DIMMER Dimmable
DIMENSIONS 3.5"W x 3.5"H x 4"D
BULB NOT INCLUDED 1 x MR16/GU5.3 (bipin)/20W/12V Halogen
OTHER BULB OPTIONS 1 x MR16/GU5.3 (bipin)/12V LED
COUNTRY OF ORIGIN New Zealand



CLICK TO VIEW PRODUCT

Notes: