

Lightology

lightology.com
866-954-4489
08-17-25

Project: _____
Company: _____
Location: _____ Fixture Type: _____
SPEC #: **HEV39681**
Approved On: _____ Approved By: _____

HL-716 MR16 Sign Light

By Hevi Lite

Description

HL-716 MR16 Sign Light features a 24 inch arm with 90 degree adjustability. Perfect for illumination of signs, buildings and open spaces. Available in a machined aluminum. Finish available in satin aluminum, black, bronze, or white. ETL listed. Suitable for wet/damp/dry locations. Requires a 12V AC output transformer, sold separately.



Shown in aluminum / bronze

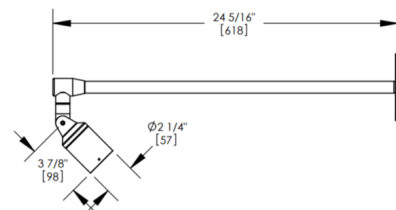
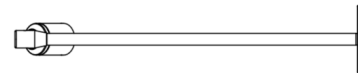

Specifications

COLOR	Bronze
BODY FINISH	Aluminum
WATTAGE	50W
DIMMER	Low Voltage Electronic
DIMENSIONS	24.31"L x 2.25"W x 3.88"H
BULB NOT INCLUDED	1 x MR16/GX5.3/50W/12V Halogen
OTHER BULB OPTIONS	1 x MR16/GU5.3 (bipin)/12V LED
COUNTRY OF ORIGIN	United States



CLICK TO VIEW PRODUCT

Notes: