

# Lightology

lightology.com  
866-954-4489  
04-25-26

Project: \_\_\_\_\_  
 Company: \_\_\_\_\_  
 Location: \_\_\_\_\_ Fixture Type: \_\_\_\_\_  
 SPEC #: **HMR532857**  
 Approved On: \_\_\_\_\_ Approved By: \_\_\_\_\_

## Textured Glass Round Multi Light Pendant By Hammerton Studio



### Description

The Textured Glass Round Multi Light Pendant brings a visual masterpiece to your interior space. The glass requires skilled artisan precision and two kiln passes to achieve this stunning look. Each piece is a unique work of art. Available in 3, 5, 8, and 11 light options. Canopy: sizes on spec sheet.

### Specifications

COLOR	Frosted Strata
BODY FINISH	Beige Silver
WATTAGE	24W
DIMMER	Standard 120V
DIMENSIONS	17.8"W x 12"H
BULB NOT INCLUDED	3 x A19/Medium (E26)/8W/120V LED
OTHER BULB OPTIONS	3 x A19/Medium (E26)/60W/120V Incandescent
COUNTRY OF ORIGIN	United States

### Technical Information

PRODUCT DIMENSIONS . . . . . Min/Max Adjustable Length: 15.5" - 133.5"



Shown in beige silver / frosted strata

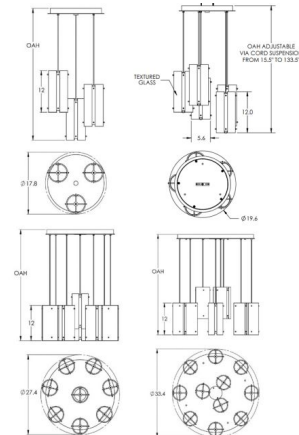

CLICK TO VIEW PRODUCT

Notes: