



lightology.com
866-954-4489
12-30-25

Project: _____	
Company: _____	
Location: _____	Fixture Type: _____
SPEC #: DLS881476	
Approved On: _____	Approved By: _____

Universal Rough-In-Plate for 2/3/4/6 Inch Recessed Products

By DALS Lighting



Description

The Universal Drilling Plate serves as a template for cutting precise product openings. Adds extra support and allows for easy and quick installation allows for quick and easy installation for any DALS recessed light fixture. Expandable on-center spacing up to 24 inches.



Shown in galvanized steel

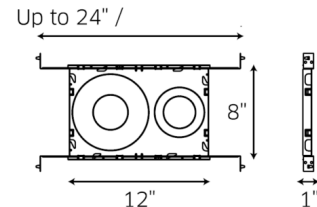

Ø2 3/4"
Ø3 3/8"
Ø4 1/4"
Ø6 1/2"

Specifications

COLOR	N/A
BODY FINISH	Galvanized Steel
WATTAGE	N/A
DIMMER	N/A
DIMENSIONS	12"L x 8"W x 1"H
BULB	N/A
COUNTRY OF ORIGIN	China



CLICK TO VIEW PRODUCT

Notes: