

Lightology

lightology.com
866-954-4489
05-23-26

Project: _____

Company: _____

Location: _____ Fixture Type: _____

SPEC #: **NOR882754**

Approved On: _____ Approved By: _____

NL Series 6IN MLV 12V Non-IC New Construction Housing

By Nora Lighting



Description

The NL Series 6 Inch 12 Volt Non-IC New Construction Housing is constructed of one piece white baked enamel steel and allows for ceiling thickness up to 1.38 inch. Rated for use with a 12 volt MR16 GU5.3 lamp, sold separately. Non-IC housings require a minimum clearance of 3 inches from thermal insulation. UL listed. Suitable for damp locations (or wet locations with designated trims). Meets or exceeds ASTM-283 Air-Tight requirements. Dimmable with a (MLV) magnetic low voltage dimmer. A complete fixture requires a housing, trim and bulb, sold separately.

Specifications

REFLECTOR/BAFFLE COLOR N/A
BODY FINISH White
WATTAGE 50W
DIMMER Low Voltage Magnetic
DIMENSIONS 12.5"W x 7.5"H x 7.5"D
BULB INCLUDED 1 x MR16/GU5.3 (bipin)/50W/12V Halogen
OTHER BULB OPTIONS 1 x MR16/GU5.3 (bipin)/12V LED

Technical Information

APERTURE SIZE 6.000"
HOUSING HEIGHT 8"
HOUSING TYPE New Construction NON IC
CEILING TYPE Drywall with Trim



Shown in white

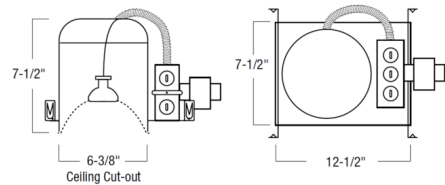

CLICK TO VIEW PRODUCT

Notes: