



lightology.com  
866-954-4489  
08-04-25

Project: _____	
Company: _____	
Location: _____	Fixture Type: _____
SPEC #: <b>JUN954177</b>	
Approved On: _____	Approved By: _____

## T31N Pendant Adapter

By Juno Lighting



### Description

The T31N Pendant Adapter adapts corded, swag or chain-hung fixtures to track. Includes loop hook for chain installation and strain relief for direct cord suspension. Chain installation accepts cord diameter up to 0.270 and supports up to 15 pounds. Strain relief installation accepts cord diameter of 0.170 to 0.255, type SVT 18/3, and supports up to 5 pounds. Finish available in Black, White or Silver. Designed for use with Juno Lighting Trac-Master, Trac-Master 2 Circuit and Trac-Lites 120 volt line voltage track systems. Two position power contact provided for two-circuit application. UL listed.

### Specifications

COLOR	N/A
BODY FINISH	Black
WATTAGE	N/A
DIMMER	N/A
DIMENSIONS	3.63"W x 2"H
BULB	N/A



Shown in black

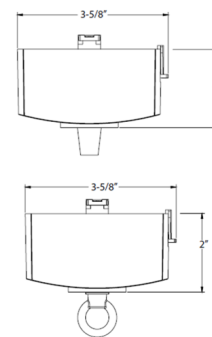

CLICK TO VIEW PRODUCT

Notes: