

Lightology

lightology.com
866-954-4489
07-02-25

Project: _____

Company: _____

Location: _____ Fixture Type: _____

SPEC #: **FMA978095**

Approved On: _____ Approved By: _____

E27 Table Lamp

By Frama



Description

The E27 Table Lamp is an industrial and straight forward fitting combined with a textile cord. Best combined with various decorative bulbs. Place around the home to illuminate your space. On/off switch located on the lamp's cord. CE listed.



Shown in copper

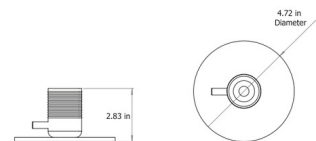

Specifications

COLOR	N/A
BODY FINISH	Copper
WATTAGE	60W
DIMMER	N/A
DIMENSIONS	4.72"W x 2.83"H
BULB NOT INCLUDED	1 x A19/Medium (E26)/60W/120V Incandescent
OTHER BULB OPTIONS	1 x A19/Medium (E26)/120V LED
COUNTRY OF ORIGIN	China



CLICK TO VIEW PRODUCT

Notes: