

Lightology

lightology.com
866-954-4489
07-07-26

Project: _____

Company: _____

Location: _____ Fixture Type: _____

SPEC #: **MSR979240**

Approved On: _____ Approved By: _____

Sound Wall Sconce

By Masiero



Description

The Sound Wall Sconce features a circular metal band that wraps around a smaller round diffused lens. It is connected to the wall by an elegantly curved metal rod. Choose between a Brushed Gold finish or a combination of Matte Black and Brushed Brass finish. This fixture comes with a cord but it can also be hardwired into the wall. Available with halogen or LED lamp options. ETL listed.



Shown in brushed gold / diffused lens

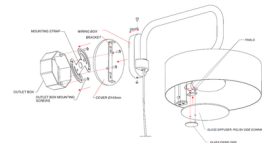
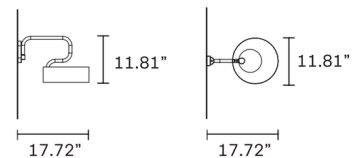

Specifications

COLOR	Diffused Lens
BODY FINISH	Brushed Gold
WATTAGE	3W
DIMMER	0-10V
DIMENSIONS	11.81"W x 11.81"H x 17.72"D
INTEGRATED LED MODULE	1 x LED/3W/120V LED

Technical Information

COLOR RENDERING	90 CRI
LAMP COLOR	3000K
LUMENS/WATT	141.67
LUMINOUS FLUX	425 lumens



CLICK TO VIEW PRODUCT

Notes: